

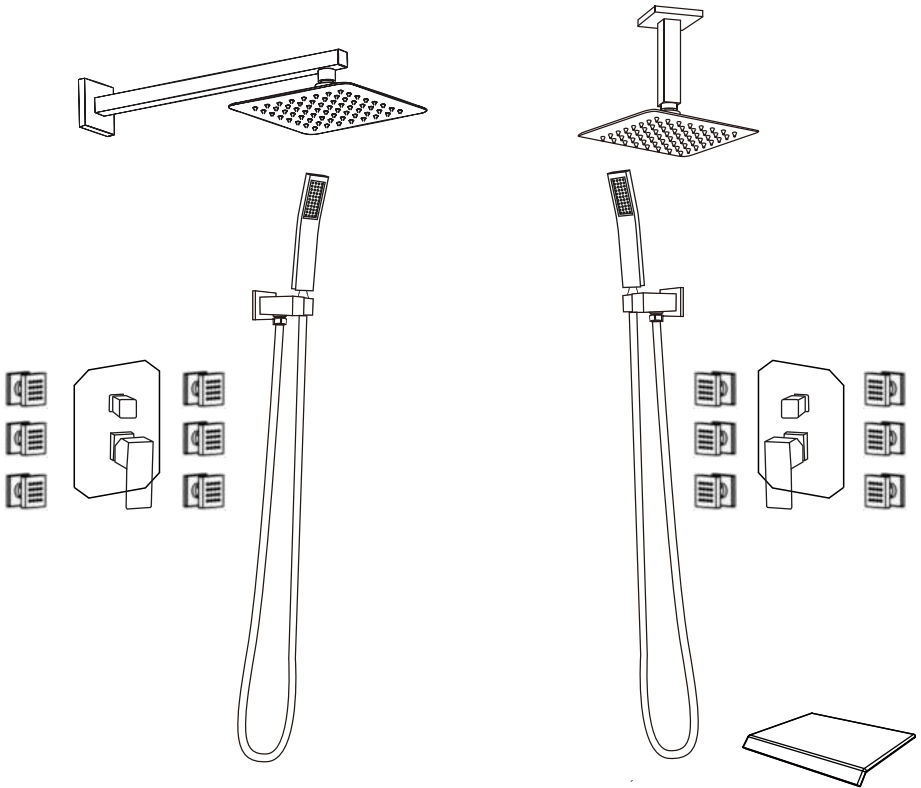

SR SUN RISE

# Installation Manual



Please do not hesitate to contact us with your questions, concerns and/or problems, we're here to help. We will replace or repair your product free of charge.

Contact US: [mikechen@eyakult.com](mailto:mikechen@eyakult.com) (USA)  
[zhongly@eyakult.com](mailto:zhongly@eyakult.com) (Canada)



# Catalog

About SR SUN RISE SANITARY..... 01

cUPC Certification .....02

3-Function Shower System (EN).....04

4-Function Shower System (EN) .....13

Warranty.....24

Clean and Maintain Product.....25

# ABOUT US

Founded in 2005, **SR SUN RISE**, provides the best shower systems online for home bathrooms and commercial use. We are the go-to brand for performance, reliability, and modern shower fixtures.

**SR SUN RISE** ensures that all our products are health conscious, ergonomic, and environmentally friendly. This allows us to exceed the expectations of our consumers, even those who are accustomed to high-end lifestyles. A major goal of ours since the brand's inception has been to make consumers feel our products have been personalized for their needs in an ever-evolving multi-functional home.

**SR SUN RISE** products frequently appear in the world of high-end commercial buildings in Europe, the Middle East, Asia, Southeast Asia, etc. These regions are well-known for having lavish bathrooms.

We use science and technology to improve people's quality of life. The bathroom is not just the bathroom, it is the place where people unload a day of fatigue and get to be most relaxed and vulnerable versions of themselves. SR SUNRISE is committed to continuously improving the experience of life.

At **SR SUN RISE** we pride ourselves on using humane and environmentally conscious methods to manufacture all our shower systems and products. We do our part to make sure that we can preserve our planet. We hope to set an example for others to also do their part so that future generations can experience the beauty this world has to offer.



# IAPMO RESEARCH AND TESTING, INC.

5001 E. Philadelphia Street, Ontario, CA 91761 • Phone (909) 472-4100 • Fax (909) 472-4244 • [www.iapmort.org](http://www.iapmort.org)



## CERTIFICATE OF LISTING



IAPMO Research and Testing, Inc. is a product certification body which tests and inspects samples taken from the supplier's stock or from the market or a combination of both to verify compliance to the requirements of applicable codes and standards. This activity is coupled with periodic surveillance of the supplier's factory and warehouses as well as the assessment of the supplier's Quality Assurance System. This listing is subject to the conditions set forth in the characteristics below and is not to be construed as any recommendation, assurance or guarantee by IAPMO Research and Testing, Inc. of the product acceptance by Authorities Having Jurisdiction.

*Issued To:*

**GUANGDONG RI ZHENG INDUSTRIAL CO., LTD.**

NO.41 XIANSAN ROAD, RIZHENG BUILDING, WANJIANG SREET, 52300 DONGGUAN, GUANGDONG, CHINA

*Product:*

**Plumbing Fixture Fittings**

*Products are in compliance with the following code(s):*

**Uniform Plumbing Code (UPC®)  
National Plumbing Code of Canada**

*Products are in compliance with the following standard(s)*

**ASME A112.18.1-2018/CSA B125.1-18**

**File Number:** 12900

**Revised Date:** January 28, 2021

**Effective Date:** January 2021

**Void After:** January 2026\*

*Tim Collings*  
Chairman, Product Certification Committee



*SP/IL*  
Chief Technical Service Officer

\*This certificate is not evidence of current listing. To verify listing status, visit the IAPMO R&T Product Listing Directory at [pld.iapmo.org](http://pld.iapmo.org)

This listing period is based upon the last date of the month indicated on the Effective Date and Void After Date shown above. Any change in material, manufacturing process, marking or design without having first obtained the approval of the Product Certification Committee, or any evidence of non-compliance with applicable codes and standards or of inferior workmanship, may be deemed sufficient cause for revocation of this listing. Production of or reference to this form for advertising purposes may be made only by specific written permission of IAPMO Research and Testing, Inc. Any alteration of this certificate could be grounds for revocation of the listing. This document shall be reproduced in its entirety.

# IAPMO RESEARCH AND TESTING, INC.

## CERTIFICATE OF LISTING



Issued To: GUANGDONG RI ZHENG INDUSTRIAL CO., LTD.

Effective Date: January 2021

File Number: 12900

Revised Date: January 28, 2021

Product: Plumbing Fixture Fittings

Void After: January 2026

This certificate is not evidence of current listing. To verify listing status, visit the IAPMO R&T Product Listing Directory at [pld.iapmo.org](http://pld.iapmo.org)

### Identification:

Plumbing supply fittings shall be marked with the manufacturer's recognized name, trademark, or other mark or, in the case of private labeling, the name, trademark or other mark of the customer for whom the fitting was manufactured. The marking shall be accomplished by use of a permanent mark or by placing a permanent label on the product. Markings on plumbing supply fittings shall be visible after installation.

Showerheads and hand-held showers shall be marked with the manufacturer's specified maximum flow rate, in L/min and gpm.

Kitchen, lavatory, and metering faucets shall be marked with the manufacturer's specified maximum flow rate, in L/min and gpm or L/cycle and gpc.

Single-handle and single-control bath and shower mixing valves shall have their temperature control settings identified alphabetically, numerically, or graphically.

High-efficiency commercial pre-rinse spray valves shall be marked with the manufacturer's specified maximum flow rate, in L/min (gpm).

Listed products shall bear the cUPC® certification mark.

Packaging for plumbing supply fittings shall be marked with the manufacturer's name, trademark, or other mark as well as the model number or, in the case of private labeling, the name, trademark, or mark of the customer for whom the fitting was manufactured as well as the model number.

Packaging for showerheads and hand-held showers shall be marked with the manufacturer's specified maximum flow rate and either the manufacturer's specified minimum flow rate or the statement "For use with automatic compensating valves rated at xxx L/min (yyy gpm) or less", where xxx L/min (yyy gpm) is the manufacturer's specified minimum flow rate.

Packaging for kitchen, lavatory, and metering faucets shall be marked with the manufacturer's specified maximum flow rate, in L/min and gpm or L/cycle and gpc.

### Characteristics:

Fittings may include lavatory, sink, bath & shower, lawn and sediment faucets. Plumbing fixture fittings to be installed in accordance with the manufacturer's instructions and the requirements of the latest edition of the Uniform Plumbing Code and National Plumbing Code of Canada.

Products listed on this certificate have been tested by an IAPMO R&T recognized laboratory. This recognition has been granted based upon the laboratory's compliance to the applicable requirements of ISO/IEC 17025.

# Package list

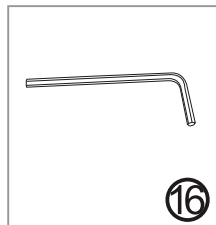
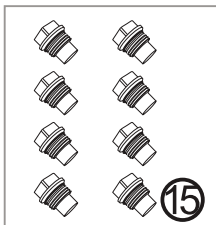
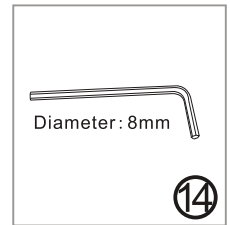
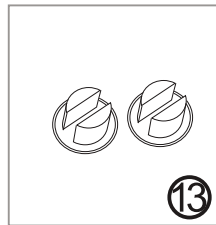
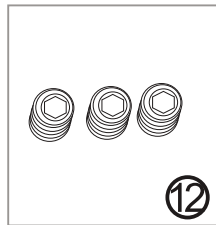
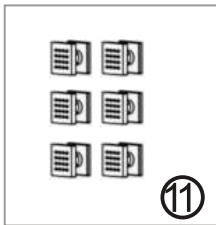
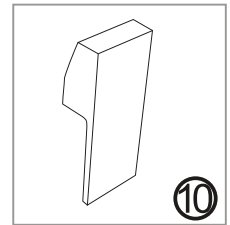
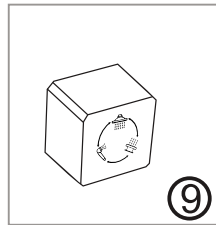
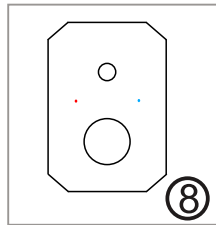
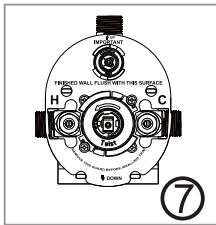
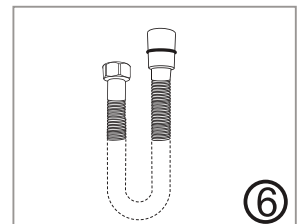
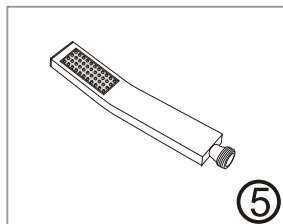
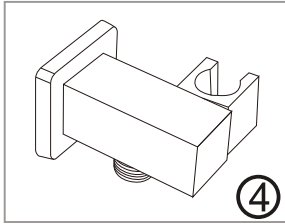
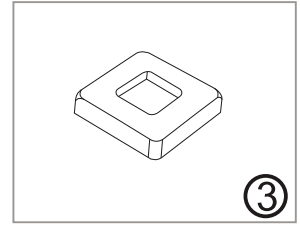
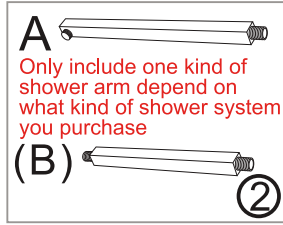
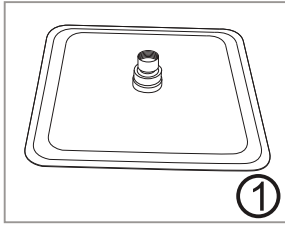

**WARNING: Choking hazard Please keep all small parts and plastic bags out of the reach of children.**

# Step 1: Install shower valve

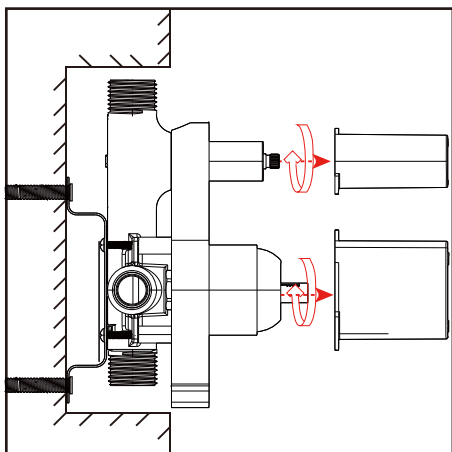
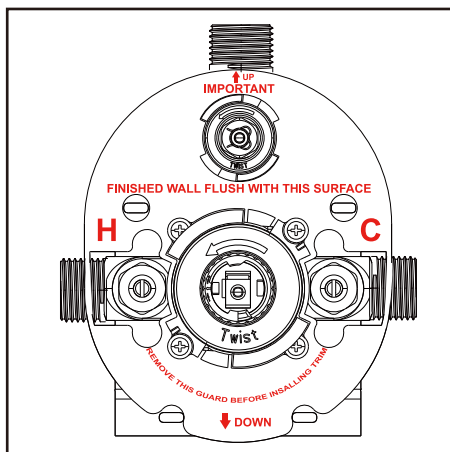
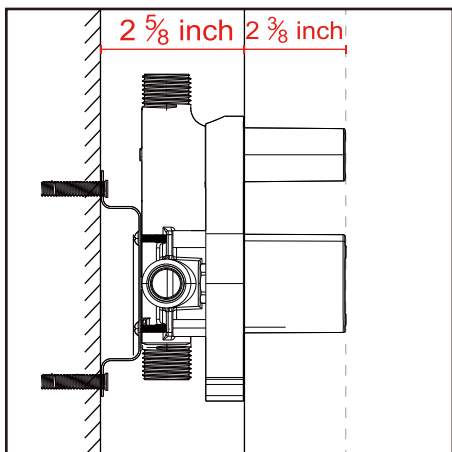

Before tiling

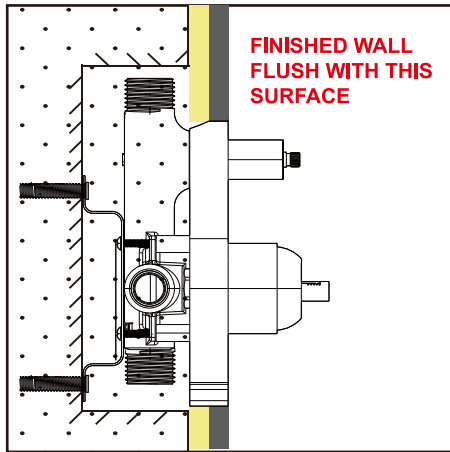

Finished Tiles

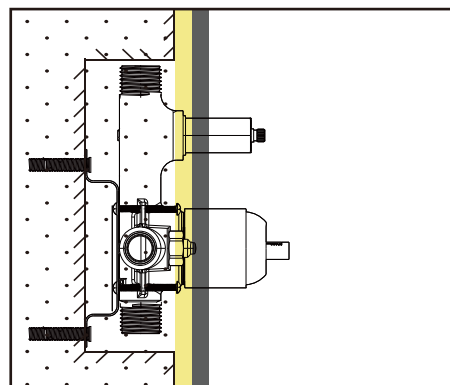
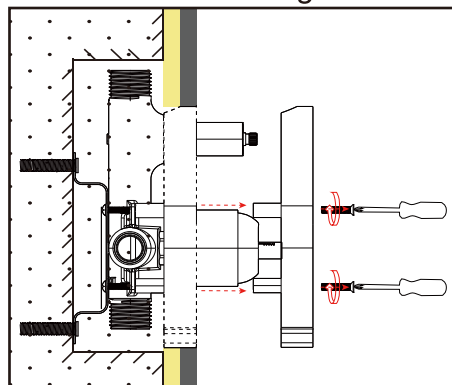

Finished Wall

**NOTE:** The depth of chisel wall for reference only.  
The actual depth is based on the customer's actual demand.



## Step 2 : Test for Leaks Before Installing Wall Board

1. Check the valve connector for leaks;
2. Open the valve and test the hot and cold water left and right;
3. Checking the Water diverter knob can correctly switch between the showerhead and handheld.

A style:

B style:

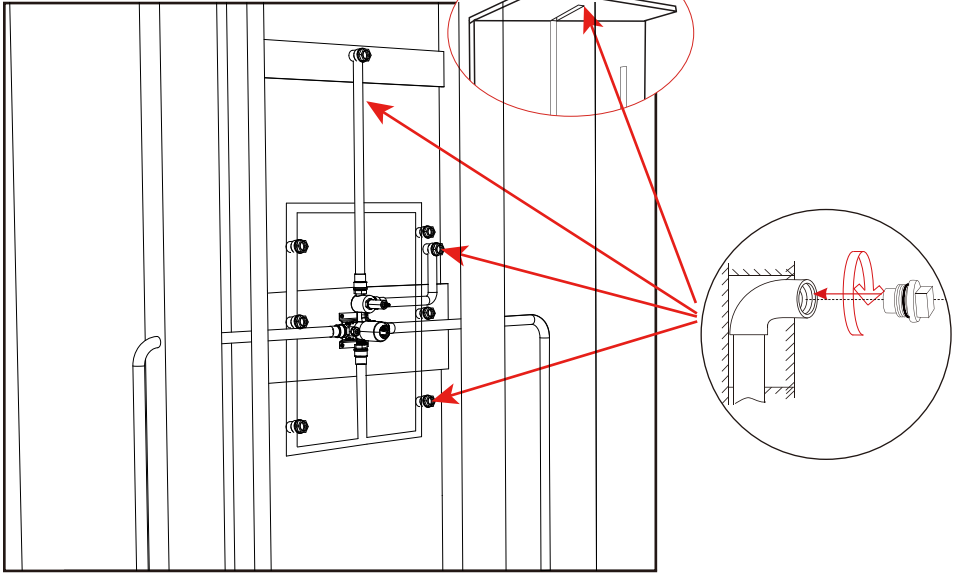

Both hot and cold water pipes must be open

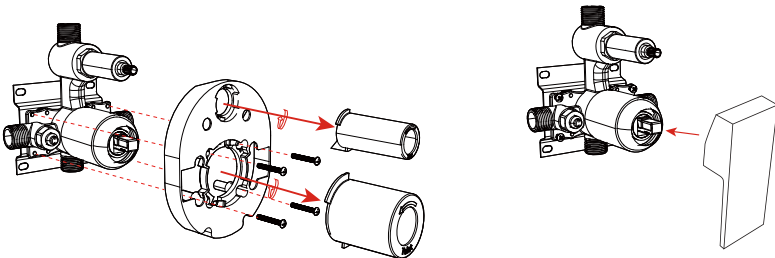

10

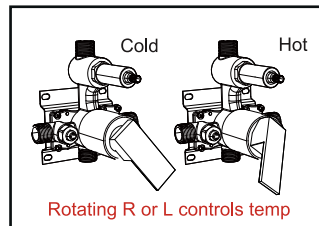
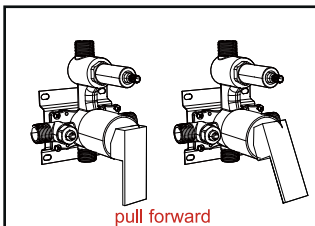

## Step 3 : Tile

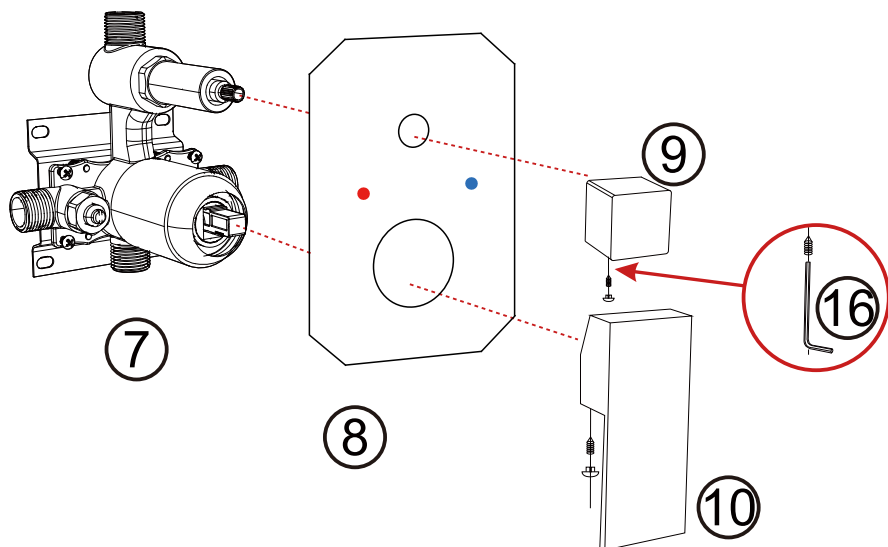
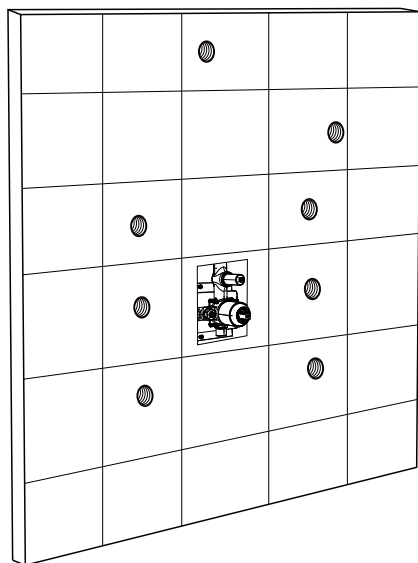

# Step 4: Install Body Jets

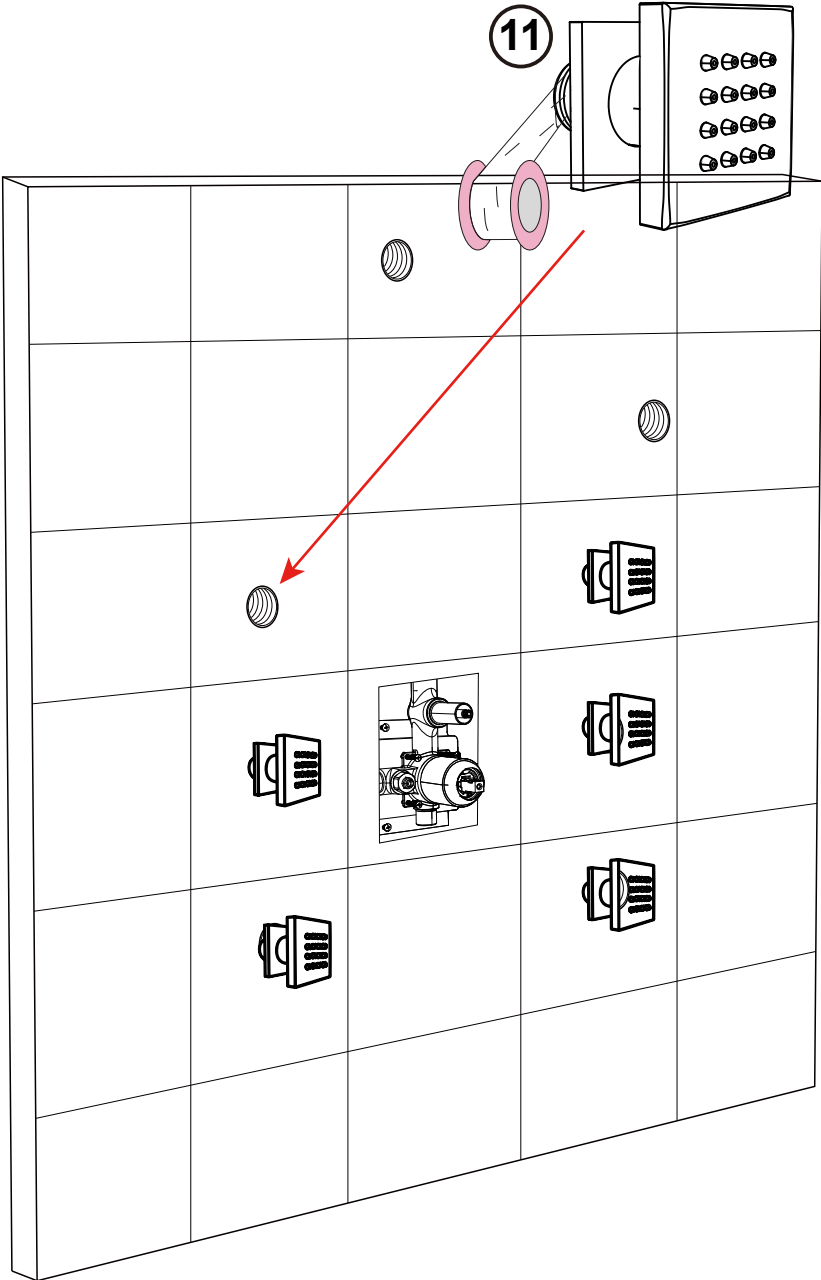

## Step 5: Install Shower Bracket

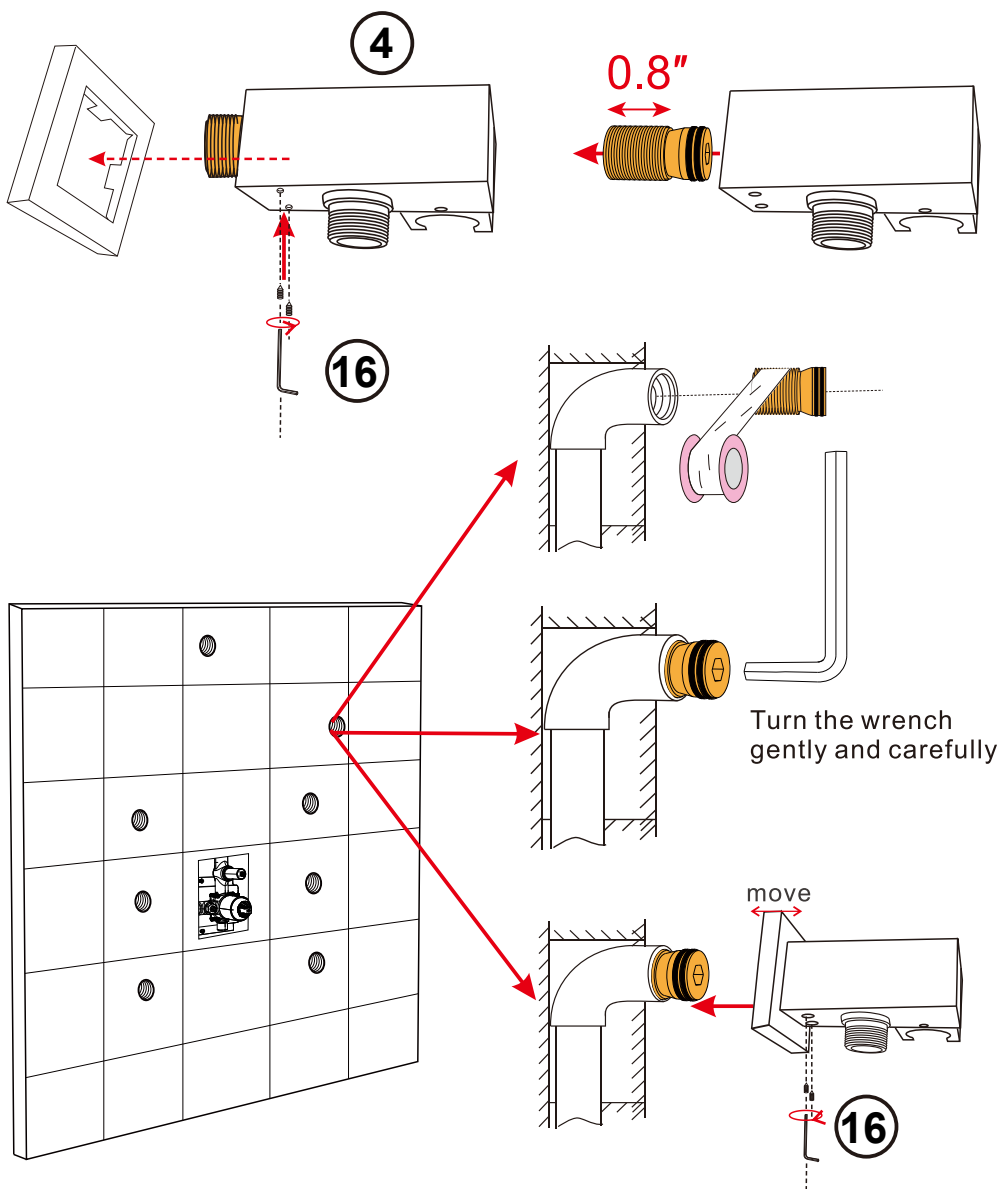

## Step 6: Install Handheld Shower Head & Shower Hose

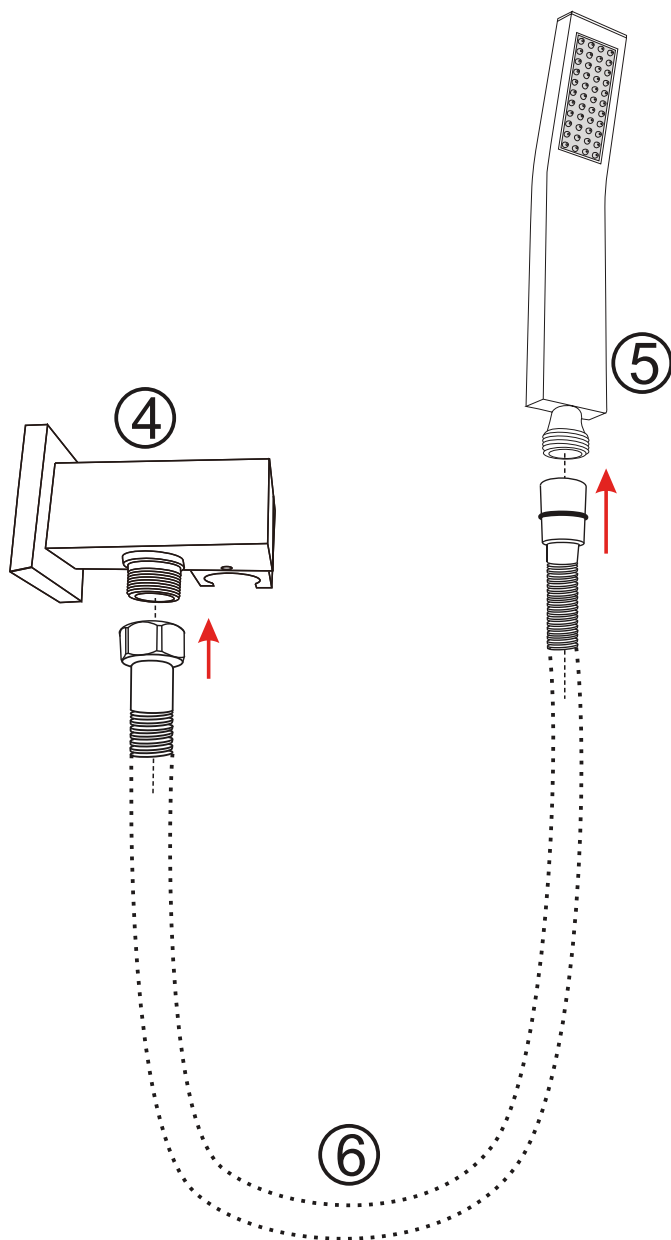



## Step 7: Install Shower Arm(B Style) & Shower Head

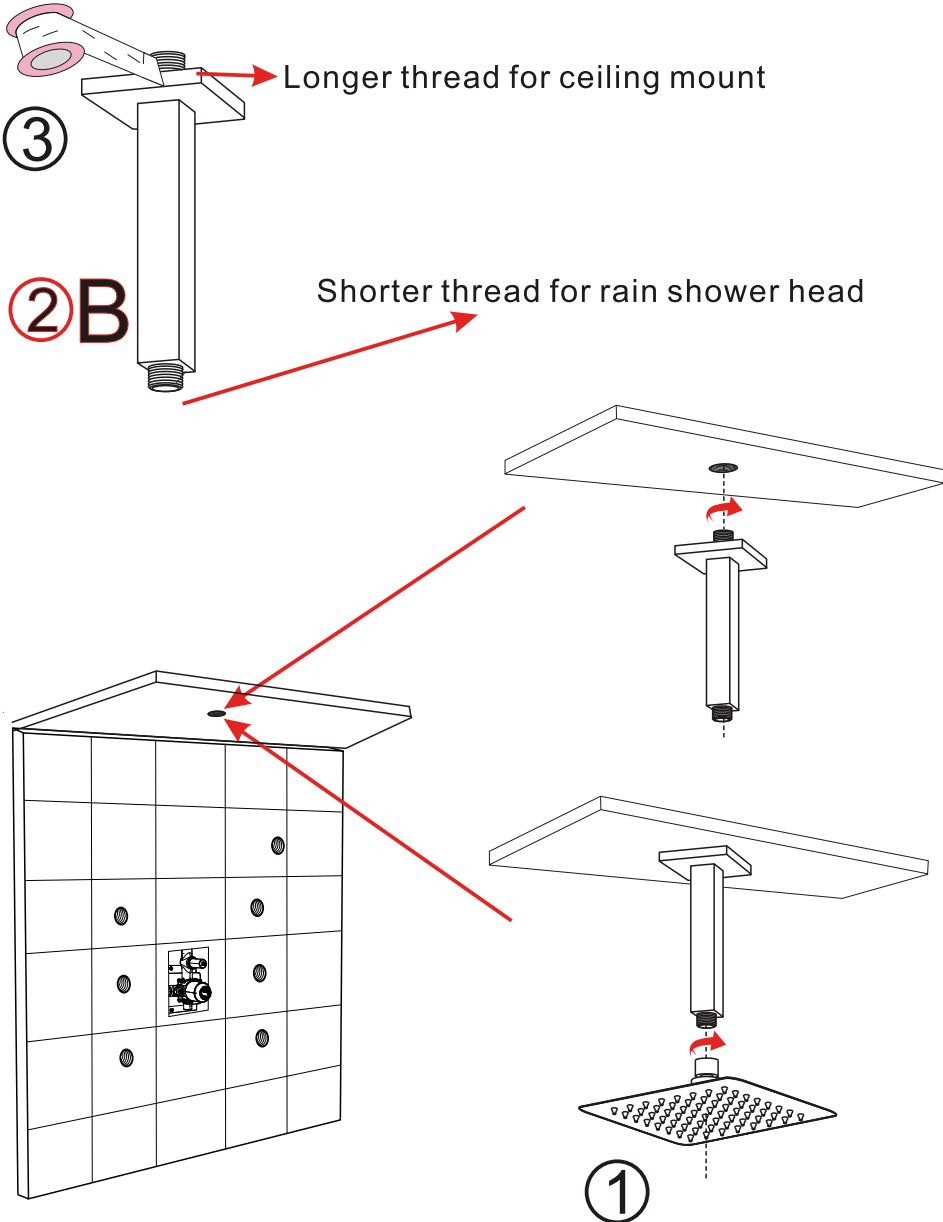

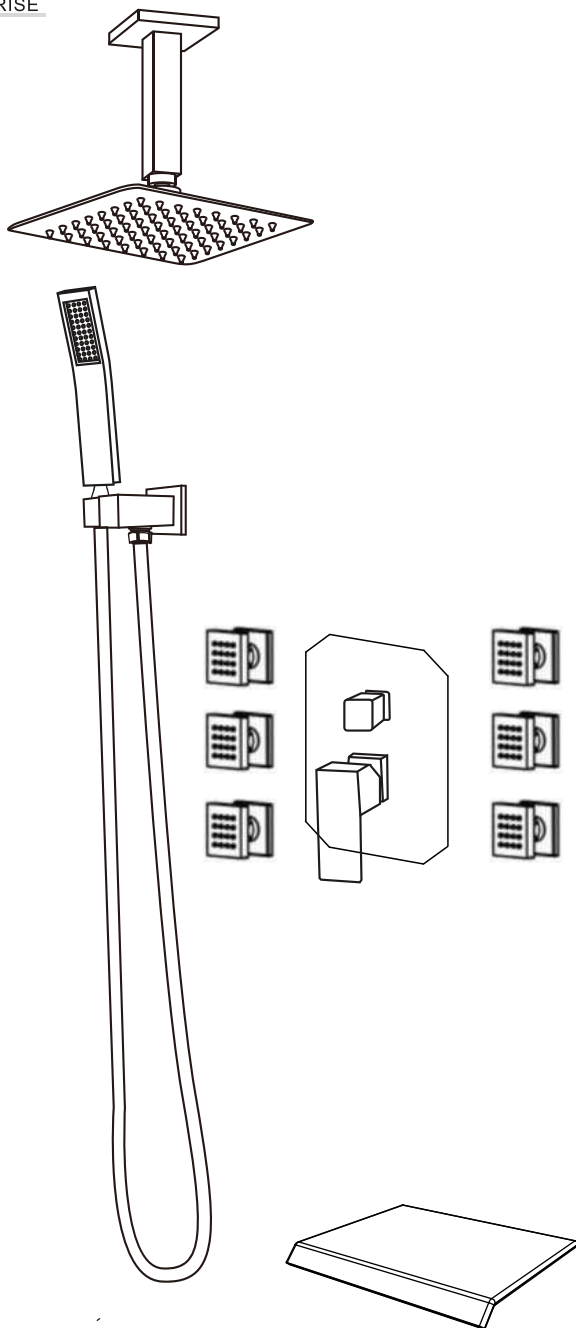

4-Function Shower System



# Package list

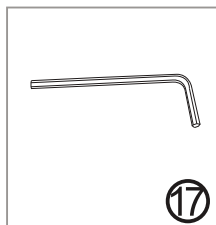
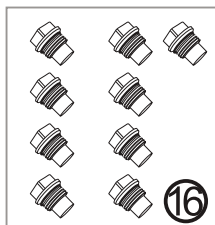
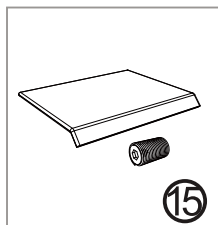
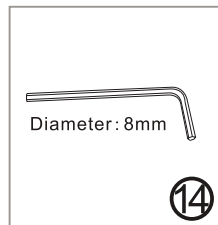
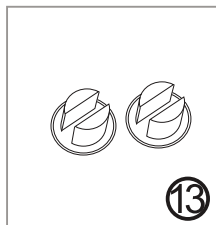
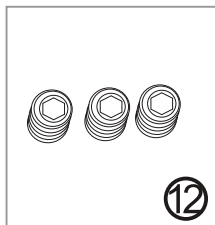
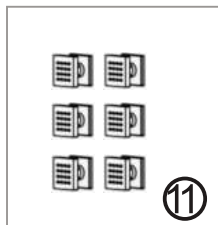
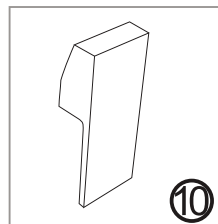
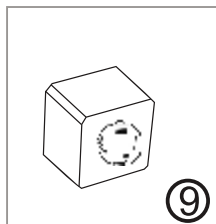
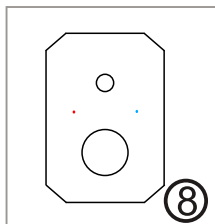
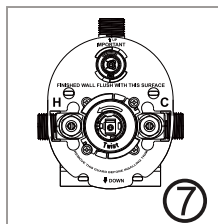
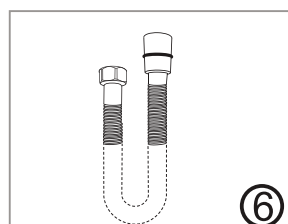
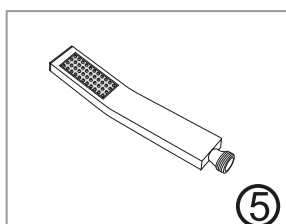
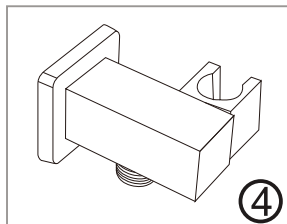
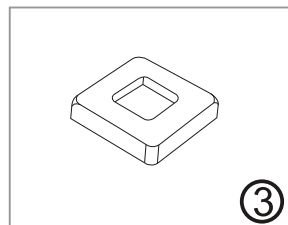
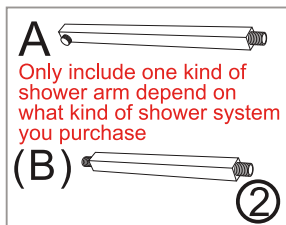
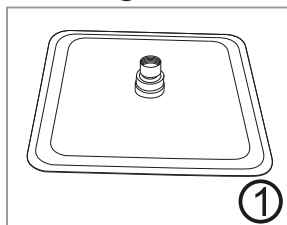

**WARNING: Choking hazard Please keep all small parts and plastic bags out of the reach of children.**

## Step 1: Install shower valve

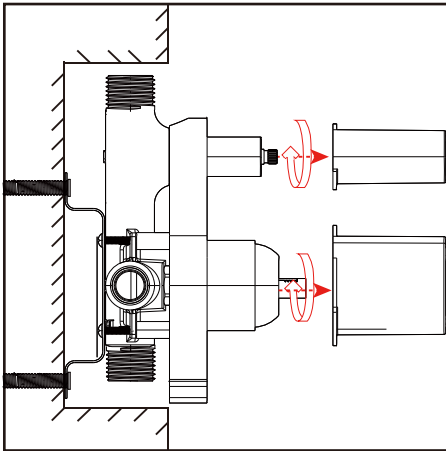
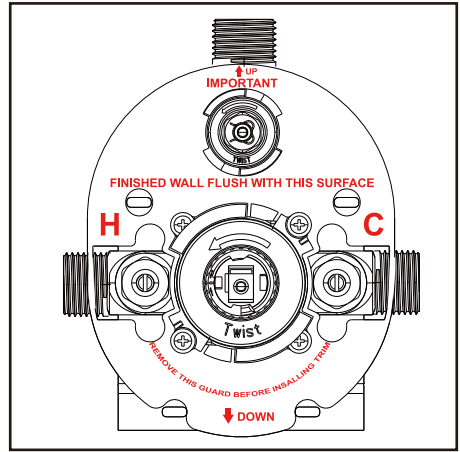
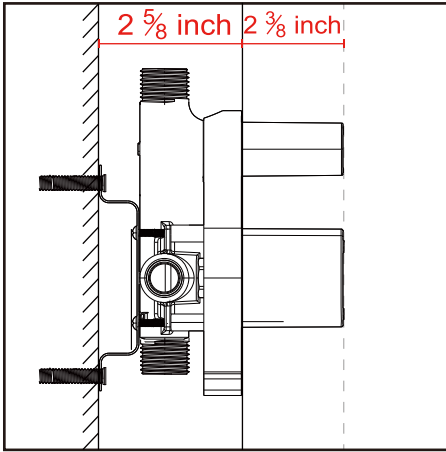

Before tiling

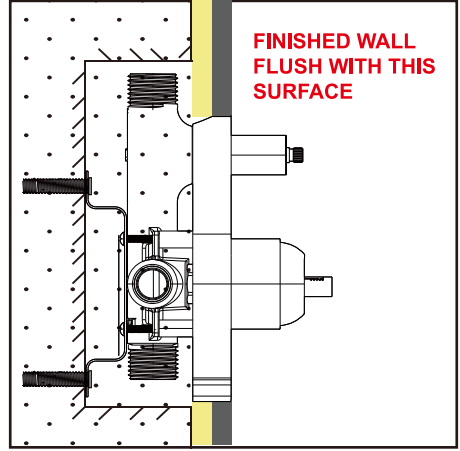

Finished Tiles

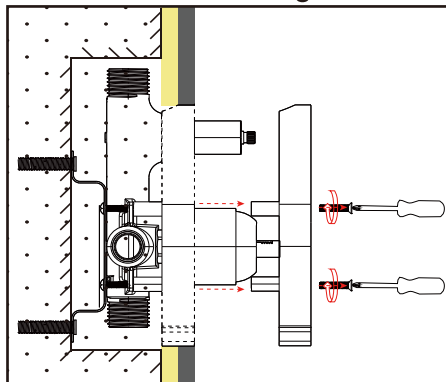

Finished Wall

**NOTE:** The depth of chisel wall for reference only.  
The actual depth is based on the customer's actual demand.

## Step 2 : Test for Leaks Before Installing Wall Board

1. Check the valve connector for leaks;
2. Open the valve and test the hot and cold water left and right;
3. Checking the Water diverter knob can correctly switch between the showerhead and handheld.

A style:

B style:

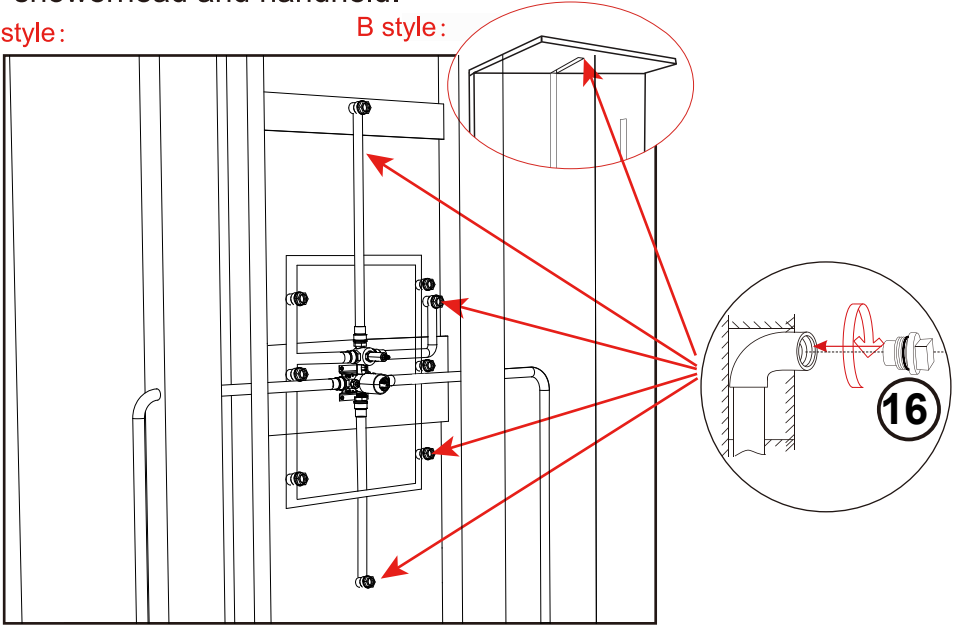

Both hot and cold water pipes must be open

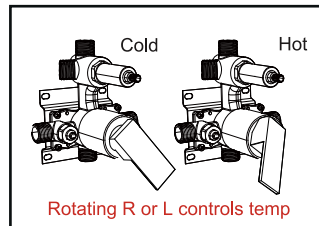
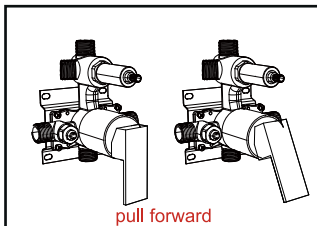
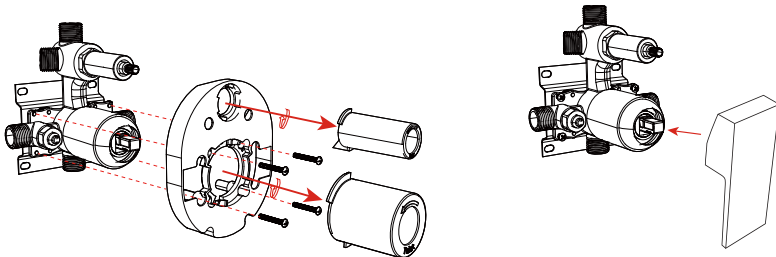

## Step 3 : Tile

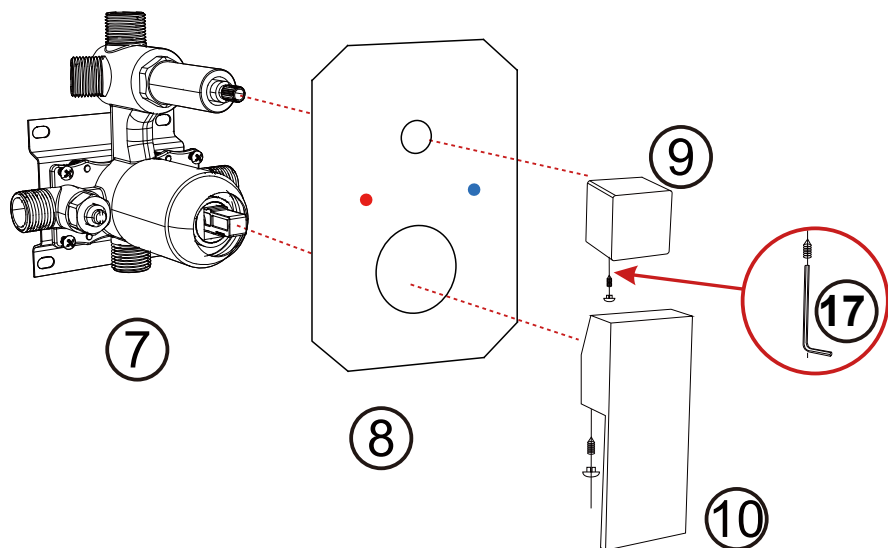
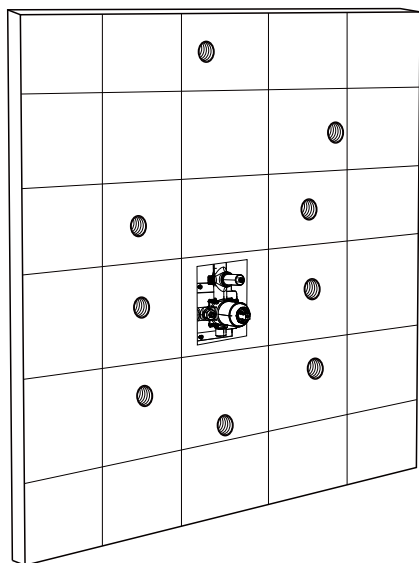

# Step 4: Install Body Jets

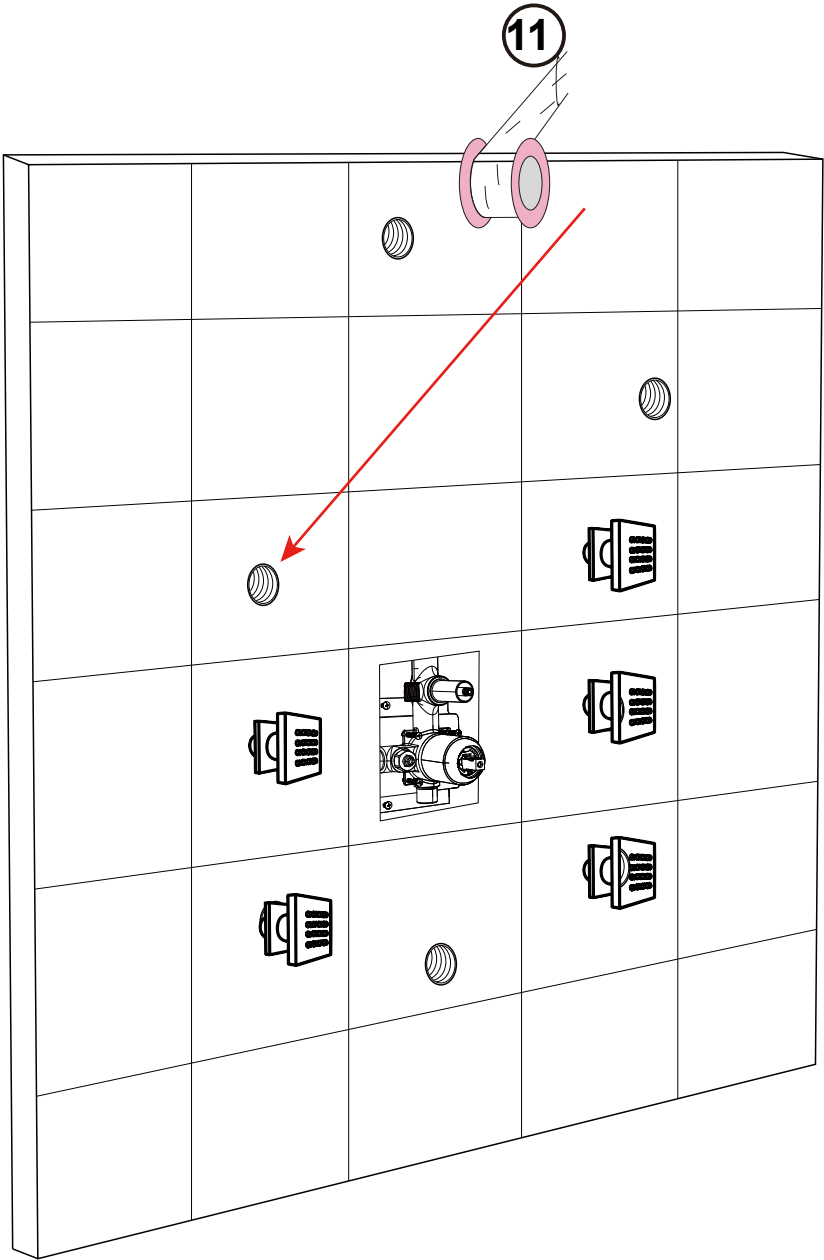

## Step 5: Install Shower Bracket

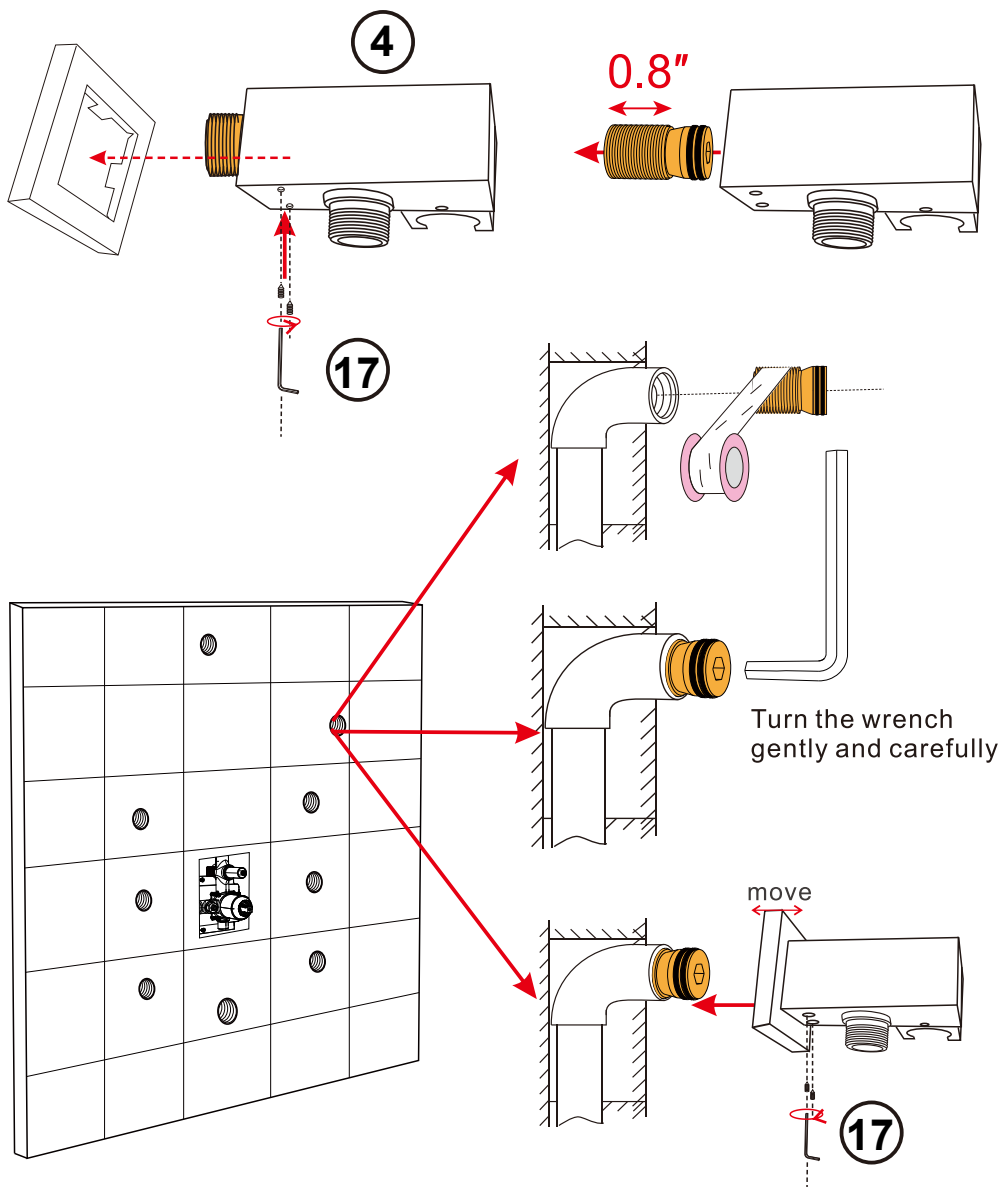

## Step 6: Install Handheld Shower Head & Shower Hose

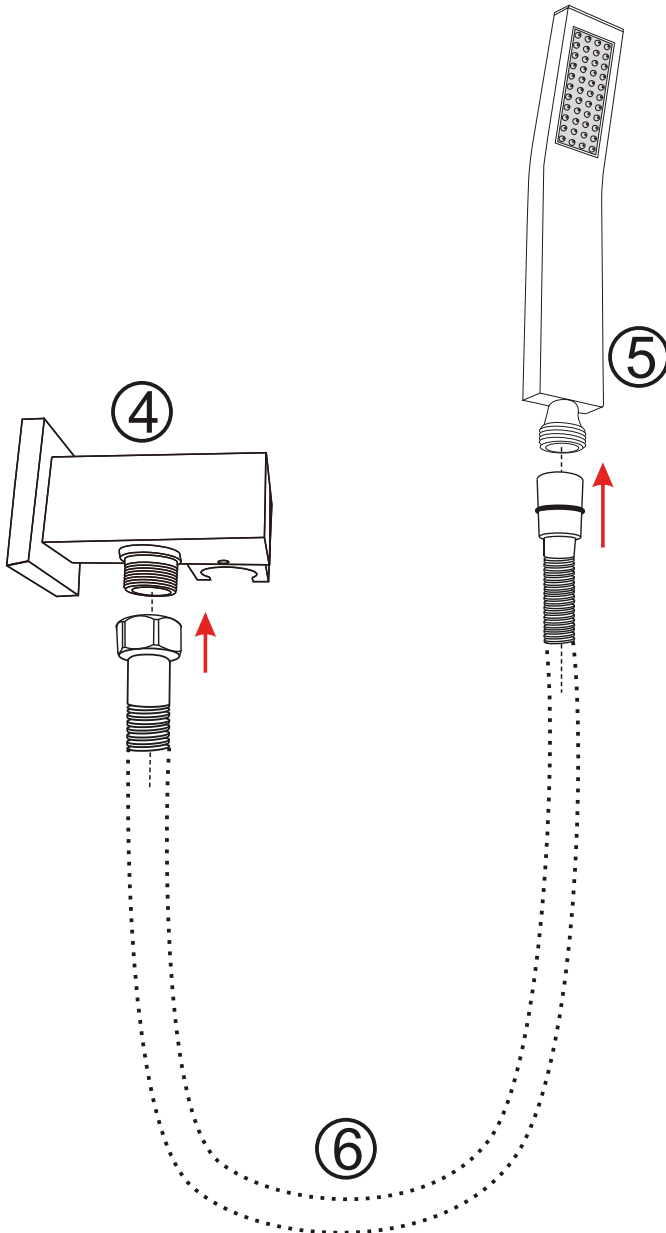

# Step 7: Install Shower Arm(A Style) & Shower Head

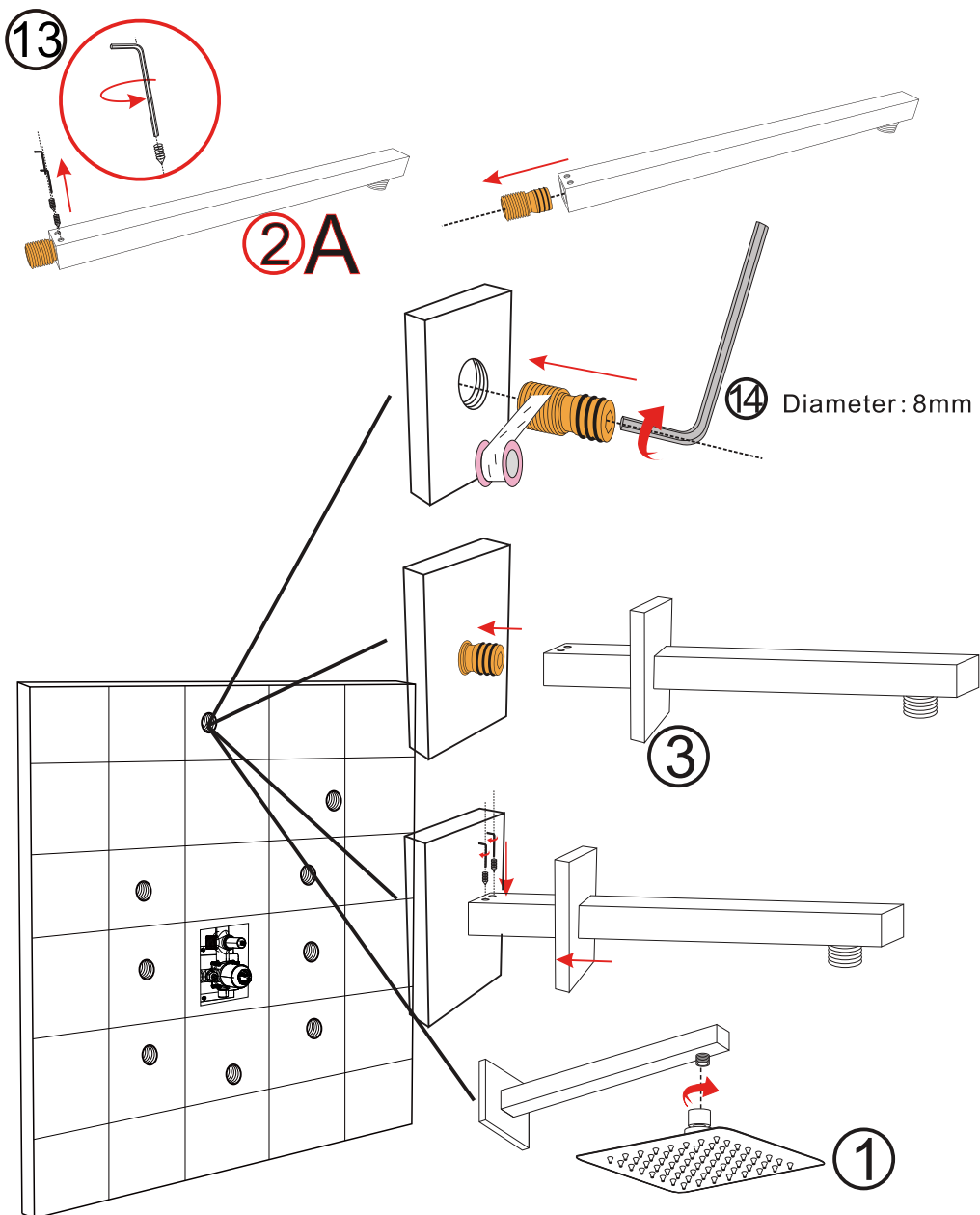



# Step 7: Install Shower Arm(B Style) & Shower Head

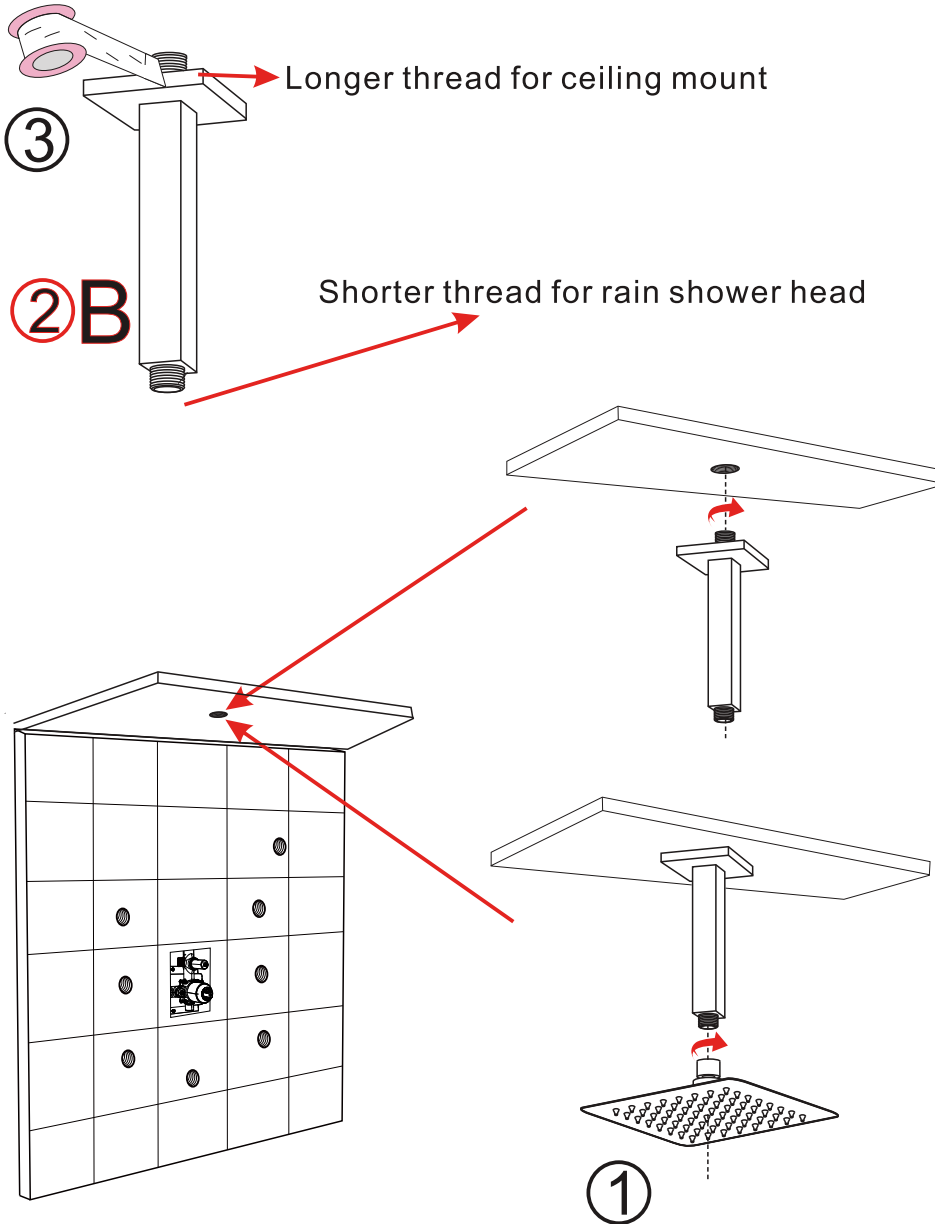

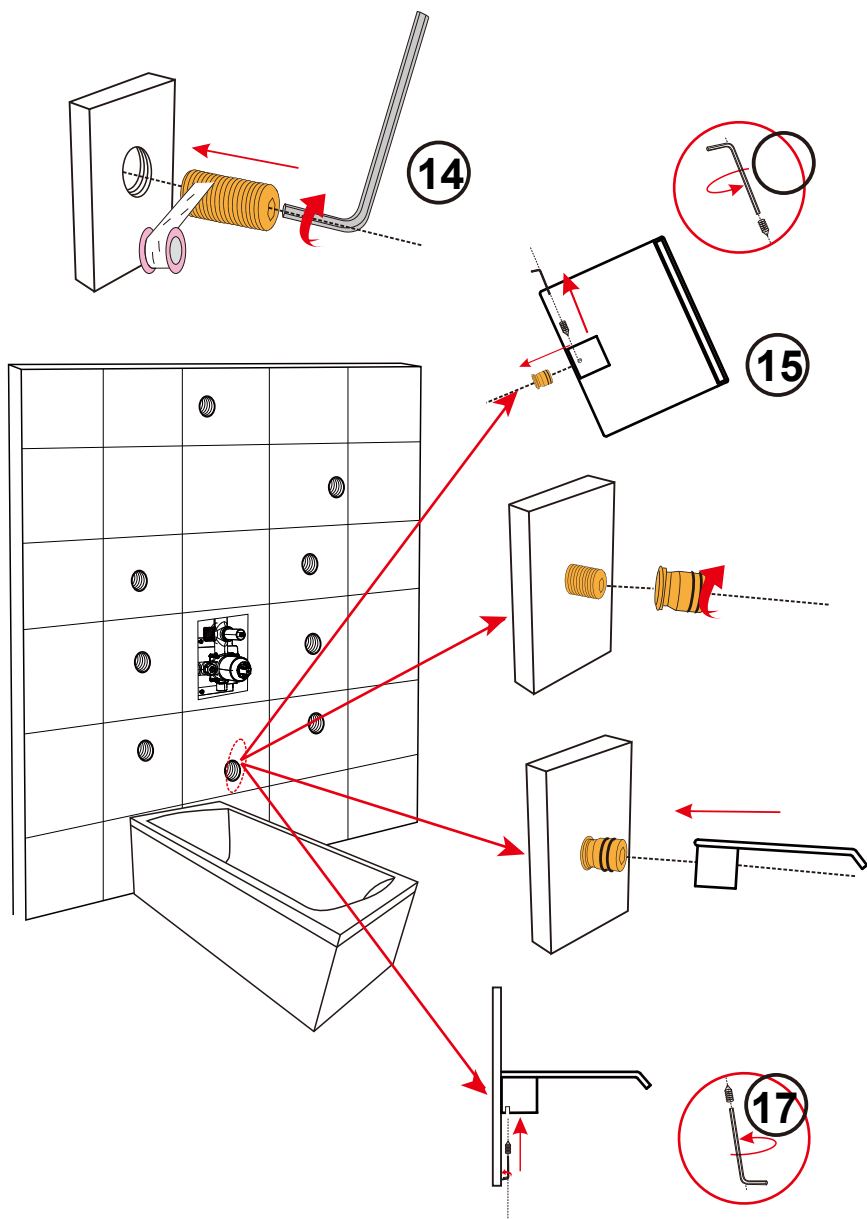

<b>Customer Name</b>	
<b>Retailer / Assembly Fitter</b>	
<b>Purchase Date</b>	
<b>Warranty Duration</b>	<b>5 years as of purchase date</b>

1.If the above contents are not complete, the warranty will be considered void, please confirm the above contents when you purchase.

2.The complimentary repairs are limited to instances mentioned on the warranty card only.

3.Within warranty period, if any technical faults occur, customer should present this warranty card along with the invoice to the retailer / assembly fitter.

#### Guarantee Repairs Claims

1. Within warranty period, SR SUNRISE SANITARY is responsible for repairing any defective product free of charge.

2. Please contact seller via email with this warranty card and invoice if repairs are needed during the warranty period.

3. SR SUNRISE SANITARY will not be responsible for any claims listed below:

3.1 The damage and/or malfunction caused by improper use an/or repairs; or any unauthorized reconstruction; including any damage caused by abuse (i.e. fall, throw... etc.)

3.2 Please engage the services of a professional plumber. SR SUNRISE SANITARY will not be responsible for any damage and/malfunction caused by wrongful installation.

3.3 The damage and/malfunction caused by removing after installation or other factors.

3.4 The damage and/malfunction caused by application beyond the scope of usage.

3.5 The damage and/malfunction caused by sand, dirt and other impurities.

3.6 The damage and/malfunction caused by improper/insufficient maintenance; rust on finishing etc...

3.7 The damage and/malfunction caused by fir, earthquakes, flood, lightning and other natural disasters, pollution, harmful gas, salts, abnormal voltage and other factors.

3.8 On occasions when the warrantee card or invoice is not presented.

4. The recommended water temperature of hand shower and rain shower is  $\leq 42^{\circ}\text{C}$ ; water pressure 0.1-0.3 Mpa. The highest temperature should not reach beyond  $70^{\circ}\text{C}$  and water pressure should not exceed the limits of 0.05-0.5 Mpa. Please keep any shower products away from the heating devices to avoid potential risks.

5. This limited warranty applies only to the original end-user or business. It expressly excludes labor charges, removal charges, installation, or other incidental or consequential costs. Any inappropriate application will void the warranty.

6. This warranty cannot be replaced if missed, please keep safe.

## Clean and maintain product

### How to clean shower head nozzles

1. Just rub the nozzles with your finger or a toothbrush to loosen any deposits, and then run hot water for a few minutes
2. Put the showerhead into a pot. Consider using a smaller container that just about fits the showerhead; this way, you will use less vinegar. You can also use a small bucket or plastic bin.

Fill the pot with enough white vinegar to cover the showerhead. The acids in the vinegar will help dissolve the white mineral deposits on the showerhead.

Let the showerhead soak in the vinegar for 30 minutes. The more soiled the showerhead is, the longer you will have to leave it in the vinegar.

### Maintain Chrome and Brushed nickel finished product

1. To clean the products all you need is a high quality microfiber cloth.
2. Apply a high quality chrome cleaner to a clean cotton cloth, and wipe over the chrome. Leave as per product instructions, and then rinse with warm water. Gently remove any product residue using a dry chamois or paper towel.
3. How to Clean Chrome: Homemade Solutions  
In addition to professional products, homespun solutions also have their place when breathing new life into dull chrome. Try this shortcut to achieving chrome cleaning nirvana:

Detergent and warm water! Submerge chrome-plated objects including pots and pans in a sink full of warm water. Add a half-cup of a high quality washing up detergent (Persil washing up liquid is good) and rub gently with a soft cotton cloth to avoid scratching the chrome. Use a scented detergent to leave kitchenware smelling fresh, as well as spotless.