

Pansonite

VIRTUAL REALITY GLASSES

USER GUIDE



Packing List



1 pcs manual

1 pcs remote

1 pcs device

Introduction

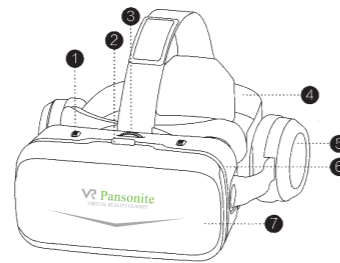

1. Focal Distance Adjustment
2. Device buckle
3. Pupil Distance Adjustment
4. Ergonomic Belt
5. Headset
6. Device body
7. Removable Panel

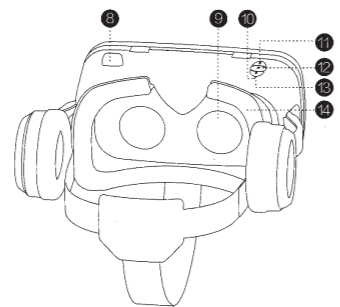

8. Touch screen button
9. Optical lens
10. Hidden microphone
11. Volume+
12. Multifunction button
13. Volume-
14. Leather Patch

User guide

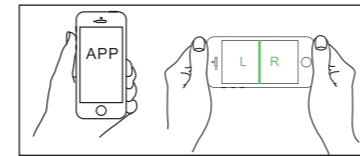

1 Download and play the video test

Enter Android market or IOS App store to download VR resources on mobile phone. (better under WIFI connection), select and install APP according to mobile system, then download the videos or games to test whether the device are split screen on the left & right sides and can play normally.

2 How to use

Open the cover plate (as shown in right picture), put your cell phone into the VR headsets, make sure the cell phone screen is in the middle, then close the cover. Adjust the screen to the right direction.

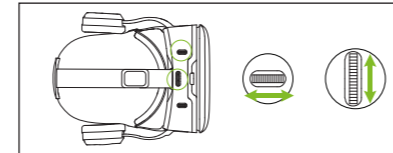
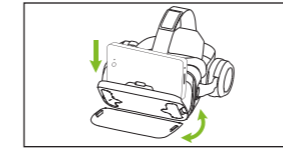

3 Adjustment function

Adjust the pupil distance once wear the VR headsets, adjust the focal distance to get the best experience. It's also compatible with nearsighted person.

4 Introduction of game play

Two ways to play VR games:

A: VR games can be controlled by gyroscope of smartphone, shaking your head or rotating to control the games(as shown in right picture)

B: VR games can be controlled by bluetooth gamepad,move all around or 360° rotate it.

Note: Most of VR games can be controlled by gyroscope, no need bluetooth gamepad, please refer to the game play tips to see if your device is necessary with it or not.



5 Introduction of multi-function button

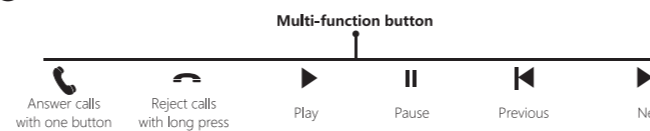

After-sales service:

- 1.Any quality problems within 7 days you bought VR PANSONITE, we accept sales return and refund the cost for you or change same item for free.
- 2.Any quality problems within 15 days you bought VR PANSONITE, we accept change same item for free.
- 3.Repair for free within 3 months.

Out of warranty:

- 1.Lack of valid invoice or not within the warranty period.
- 2.Not "Manual" require the use, maintenance, custody and led to the failure or damage.
- 3.Damages caused by fire, water flood, thunderstroke etc force majeure factors.
- 4.Malfunction as disassemble, refit.
- 5.Can not use suitable for your phone or network.

Important Note:

Please keep all the packaging and accessories when sales return.

If you encounter any problems in use, please contact us: pansonite1@outlook.com

Kindly remind: In order to improve your viewing comfort, the appropriate angle of back and seat is better to be 60°. In order to protect your vision, we suggest your viewing time should not be more than 30 minutes.

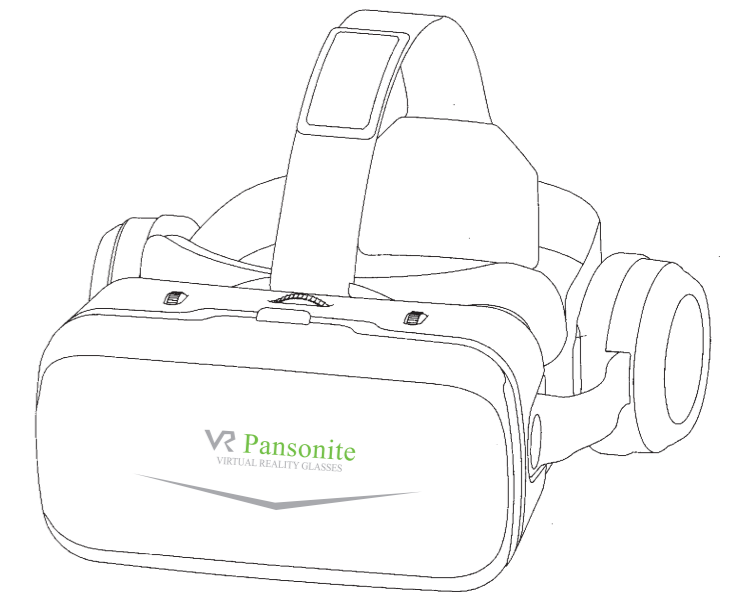

Without authorization in written of PANSONITE, to copy all or part of this manual is not allowed (Excluding comments on an article or simple reference for comment).



Pansonite

Bluetooth Remote

USER GUIDE

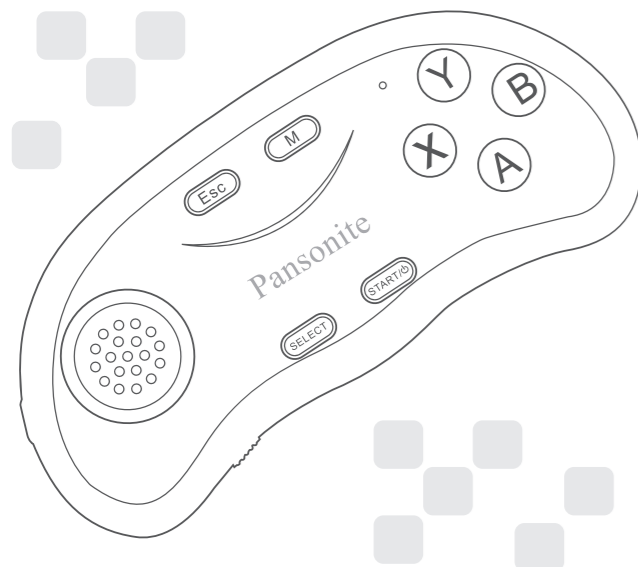

Many thanks for purchasing our product! This is a portable wireless controller, used for mobile phone, MID, TV box, smart TV, PC and so on. It can be used as gamepad, VR remote, wireless mouse, music control, E-book page, PPT presentation etc. and support iOS, Android, Windows and so on. Important Note: Products are subject to change without any notice. And this product has applied for patents, counterfeiting is not permitted.

Operating instructions:

1.Power On: Press **START** button until LED is on (about 2 seconds), (First put the batteries.)

2.Power Off: Press **START** button until LED is off (about 5 seconds). Note: If no connecting with wireless device after 5mins, system will power off automatically; after connecting with wireless device, if no any operation, system will power off after 30mins.

3.Pair and connect: after power on, LED indicator will flash, the device will enter into the wireless pair mode automatically to find the address and name of this device, click then can connect. Pair and connect successfully, LED indicator will turn off. Next power on, it can connect and match the last wireless device. Under turn off state, press **START** (over 8 seconds), LED will flash, then go to pair mode again, and can't connect last paired device automatically.

4. KEY Mode: Turn switch on side to KEY (there is "KEY" on the side), The device operation is one-hand vertical operation. (as shown to the right)

4.1 Music operation: After connecting with wireless, open mobile's music player (like Samsung's player), click play, then can use this device to operate, like music play, pause, changing songs and so on. There are some difference due to different software and system,

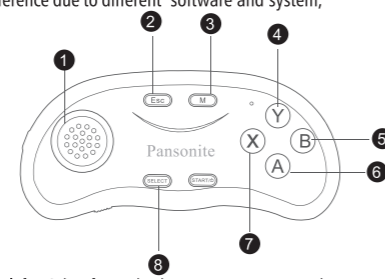

- 1.up / down / left / right / front / back
- 2.ESC
- 3.Mouse Mode
- 4.Menu
- 5.Mute / Shutter
- 6.Volume+
- 7.Volume-
- 8.Play / Pause

like: key is for mute under iOS, but for camera selfie under Android.

4.2 Selfie operation:

For iOS mobile, press **X** key to shutter; for Android Samsung mobile, then press **B** key to shutter, Volume key to adjust focus; for other Android mobile, please enter camera setup first, then set volume key to shutter or scan QR code to download camera software.

4.3 Mouse operation(just for Android):

When the controller is in the music operation function, Press **M**, then joystick can change to mouse function, **SELECT** is for mouse confirm key. Press **M** again, then can switch to music mode. If need move mouse function, please press the confirm key on the top and at move the joystick same time (Turn side switch to Game side). MENU function: press **Y** is MENU key function.

4.4 E-Book flip function:

In iReader: use Volume +/- to turn page up down; In Kindle or PPT for iOS, use joystick in Game mode to turn page.

5. GAME function: Turn side switch to Game side (there is "GAME" on side), now device is operated by two-hands horizontal.

5.1 Game function on Android:

In Menu, if joystick can move cursor, Key **A** is confirmation button, Key **B** is returning button, then means your mobile system can support international standard gamepad, just download game and play directly (If can't operate, then refer to part 6, Android MTK mobile operation)

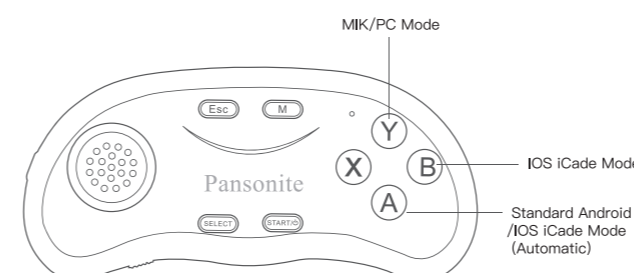

Users can also download simulator BIN files to Games file folder in mobile, then can use MIGAMEPAD software to open the game file, like many famous games: Super Mario, Metal Slug, Sangokushi and so on. Android games usually have gamepad type, download this kind of games, just connect with wireless then can operate with gamepad directly (please note, turn side switch to "Game"), this kind of games are like: Eternity Warriors 2, FIFA 15 and so on. (Some games maybe need set to use gamepad control when playing)

senior game combination key:
START + **A** = L1, **SELECT** + **B** = R1, **SELECT** + Joystick = Right Joystick
SELECT + **X** = L2, **SELECT** + **Y** = R2

5.2 IOS game:

Game download: Enter into iOS APP store or other Apple store, search "icade", then you can find games of iCade which support gamepad, download and install then ok, like Akane Lite, Brotherhood, TTR Premium and so on. Before play games, please set keyboard input mode to English input and can input English letters then ok. Next, please connect with wireless and enter games then can play (Some games maybe need set to use iCade when playing)

Combination keys: **SELECT** + **A** = L1, **SELECT** + **B** = R1

6. Android MTK mobile operation:

Like Redmi 3G version, Huawei Honor 3X, CoolPAD, Zhongxing, these old style mobiles use MTK CPU, due to MTK bad compatibility, they can't support international standard gamepad agreement. So if by standard Android connection method, unusual problems will happen. We preset MTK mode to support MIGAMEPAD games.

6.1 MTK Power on mode: under power off state, press key **Y** first, then press **START** at same time until LED light is on, the device turn on successfully. Next time, press key then default to MTK mode. If want to shift to standard Android mode, press key **A** and **START** then ok.

6.2 Function instruction on MTK mode Music, mouse and shutter are same with standard Android, just game mode is different. MTK mode can support MIGAMEPAD simulation directly, but can't support standard Android APK games.

7. VR 3D virtual reality game or video operation:

Browse the website to learn more: www.migamepad.com/english/index-ios-english.jsp

8. Battery:

Our product is need two 1.5V batteries of type size AAA, when power is low, LED will flash, please change the batteries.

Notes:

1. When accident cause not boot or unable to shutdown, please use needle to take out the batteries.
2. If already paired, but can't connect, please cancel the pair and boot the device and again.
3. If can't use input method, please download input software from the website above for Android, and press the M button for iOS.

Product Specifications

Item	Specifications
Size	130mmx60mmx14mm
Wireless Protocol	Bluetooth 3.0 compliant
Wireless Distance	2-10 Meters
OS	Android /IOS/PC
CPU	ARM968E-S Core
Battery	Type size alkaline AAA 1.5V x 2
Working time (Continuous game)	About 40 hours
Work current	0.5-8mA
Standby current	0.5-1mA
Shutdown current	<20uA