



Logistics Label Printer

User Guide

CONTENT

A

Overview

1. Quick Start Video
2. Product Overview
3. Printer Started
4. Label Loading
5. Feed Button
6. LED Status Light
7. Maintenance
8. Tips for Preparation
9. Safety Notices
10. Download the Driver
11. Download the APP
12. Windows PC Bluetooth connection

B

macOS

- Step 1: Security & Privacy Setting
- Step 2: Driver Installation
- Step 3: Printer Setup

C

Windows

- Step 1: Driver Installation
- Step 2: Printer Setup

D

Support

1. Adobe Use Tips
2. Labelife Use Tips
3. Solution for Not Finding the Printer

贴标区

1. Quick Start Video

A

The printer is a very capable printer. You can print barcodes, shipping labels, name badges, warehouse labels, food nutrition labels, amazon FBA labels and labels of all sizes with it. It's the perfect partner for your business with its economical, reliable and high-efficient features.



You can get a more comprehensive and detailed video tutorial in the following ways:
Method 1: Download the latest driver from official website
Method 2: Complimentary USB driver

Please kindly take a short time to watch the setup video. It will guide you through the setup process step by step.

2. Product Overview

A

Package contents

Printer*1, Power Cord*1, Power Adapter*1, USB Cable*1, USB Driver*1, Quick Start Guide*1, Start Label*1, TC Adapter*1

Printer components

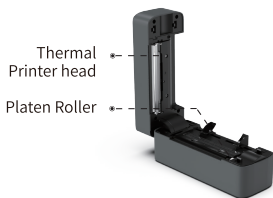
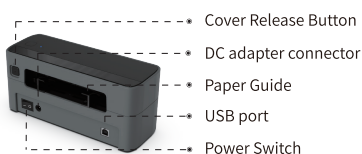
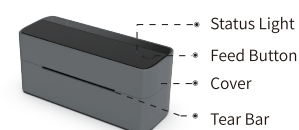

> **Please take a moment to thoroughly read this user guide.** Incorrect operation may result in damage to the printer or your physical injury.

3. Printer Started

A

1. Ensure that the printer is OFF. The power switch is switched to O. (I:On; O:Off)

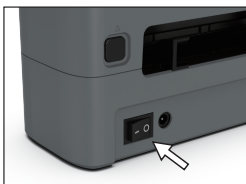

2. Attach the power cord to the adapter.



3. Plug the adapter cable into Circular DC adapter connector of the printer.



4. Plug the power cord into socket.



5. Connect the USB cable to the printer.



6. Connect the other end of the USB cable to the computer.



7. Turn the printer ON with the power switch. (I:On; O:Off)

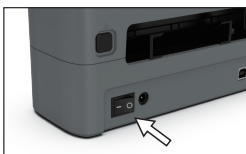

4. Label Loading

A

The printer is capable of working with label width range from 1" to 4.6" (25.4 to 117 mm). To print on different labels correctly, the printer needs to identify your label size before it starts printing.

> To run the automatic label identification, please follow these steps:

1. Turn on the printer. (I:On; O:Off)

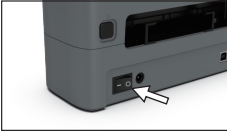

2. Adjust the paper guide to match the label size.



3. Insert label and ensure it is straight and smooth as shown.
Note: The print side should face up.



4. Make sure the label is automatically caught by the printer.



5. Press and hold Feed Button. After the blue light flashes 2 times, release the Feed Button.

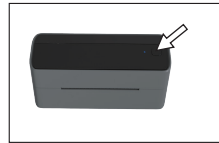

6. The printer will move the label back and forth to learn the gap size and other properties of your label.



NOTE: Please run the label size identification every time you change your label. (See picture 5 & 6)

If the learning fails and the indicator blinks blue, please calibrate the sensor. See 5.Feed Button for details.

> Continue to Driver Installation

5. Feed Button

A

Desired Action	Execution
Skip a label	When the printer is standby and ready (not in the middle of printing), press the Feed Button once.
Print test page	Insert the label, ensure it is straight and smooth. When the printer is standby, press and hold the Feed Button for about 4 seconds. After the blue light flashes 1 times , then release the Feed Button.
Run the automatic label identification (for labels with gaps)	Insert the label, ensure it is straight and smooth. When the printer is standby, press and hold the Feed Button for about 6 seconds. After the blue light flashes 2 times , then release the Feed Button.
Run the automatic label identification (for labels with black marks)	Insert the label, ensure it is straight and smooth. When the printer is standby, press and hold the Feed Button for about 8 seconds. After the blue light flashes 3 times , then release the Feed Button.
Restore factory setting	Insert the label, ensure it is straight and smooth. When the printer is standby, press and hold the Feed Button for about 10 seconds. After the blue light flashes 4 times , then release the Feed Button.
Sensor calibration	Unload the label. When the printer is standby, press and hold the Feed Button for about 12 seconds. After the blue light flashes 5 times , then release the Feed Button. Run the automatic label identification again after sensor calibration.
Pause printing	When the printer is printing, press the Feed Button once.
Resume printing	When the printer pauses printing, press the Feed Button once to resume printing.
Clear printing data	When the printer pauses printing, press the Feed Button twice to clear the printing data.

6. Led Status Light

A

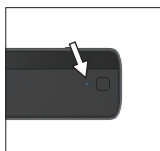

Light	Printer status
Solid blue	Standby and Ready
Blue flashing slowly	Label jams or label detection error
Blue flashing quickly	Wrong media tracking
Solid red	Printer head is over-heated
Red flashing slowly	Paper shortage
Red flashing quickly	Cover is not closed
Solid purple	Printing
Purple flashing quickly	Pause printing

7. Maintenance

A

▶ Printer head cleaning steps

1. **Turn the printer off**, remove the power cord and open the cover. (See picture 1)
2. **Wait until the printer head cools down**. (The printer head may be very hot after printing)
3. Completely **clean the printer head using an alcohol swap (Not with water)**. (See picture 2)
4. Wait **until the alcohol has completely vaporized**, then close the cover.
5. Connect the power cord and **print a test page** to check if it is clean.



Picture 1



Picture 2

NOTICE

Ensure power is off when performing maintenance.
Do not touch or scratch the printer head, the roller or the sensors.

8. Tips for Preparation

A

1. **Avoid using poor quality labels** as they may damage the printer.
2. **Clean the printer head** regularly.
3. Connect the printer to the **same USB port on your computer every time**. This can avoid creating duplicate copies on the printer.
4. **If paper is jammed**, please refer to "Printer head Cleaning Steps" in "7. Maintenance".

9. Safety Notices

A

1. Do not bend the power cord excessively or place objects on the cord.
2. Keep the printer **out of reach of children**.
3. Use only approved accessories and **do not try to disassemble or repair the unit by yourself**.
4. **Keep the printer away from water** and other objects that could penetrate the components.
5. **Unplug the printer when it is not in use for long periods**.
6. **Do not use the printer if you find any irregularities** as these could result in fire or electrocution.
7. **Do not touch the printer head**. The printer head can be over-heated after printing.

10. Download the Driver

A

Method 1:

Install the latest printer driver from the USB driver attached.

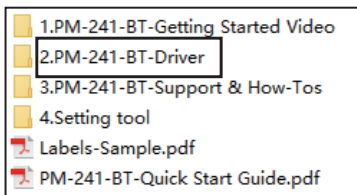

Method 2:

Download the latest driver from official website

> Please run the downloaded software and follow the hints to complete the installation.



Printer-1.3.1.pkg
(Mac Driver Installer)



Label Printer Driver
Setup_Release_v1.2.7.exe

Note: Before the installation, please ensure the printer is connected and turned on!

- ① Mac OS: For more details, see section B
- ② Windows: For more details, see section C

11. Download the App

A

1. Search "Labelife" on App Store or Google Play to get the app.



2. Or please scan the QR Code to download the App.



3. Turn on Bluetooth, connect the printer in two steps

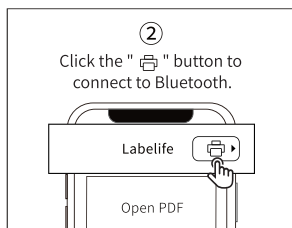
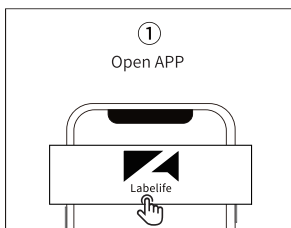

Note:

- 4. Due to the mobile phone system requirements (Android only), App needs access to location, you need to enable GPS and confirm authorization.
- 5. Make sure to select 4" x 6" file to print.
- 6. iOS cannot import PDFs directly. Open the files and share it to labelife app.

12. Windows Bluetooth connection

A

- 1. Connect USB cable
- 2. Feed paper
- 3. Calibrate printer
- 4. Install driver via USB firstly (not bluetooth)
(Please refer to "Step 4-1: Driver Installation" in "For windows")
- 5. Keep USB cable connected still
- 6. Set up Bluetooth:
 - ① Add bluetooth (Not necessary step)
 - ② Match COM port (Not necessary step)The video tutorial is on the complimentary USB drive.

macOS STEP 1. Security & Privacy Setting

B

- (1) Click on the "pkg" installer to begin.
- (2) If the driver can not be opened, please give permission to it first. Click "OK" and follow the steps below to allow the macOS system to process the installation.

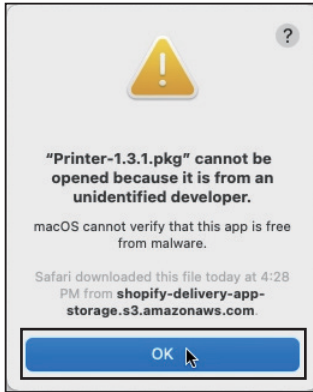

- (3) Click "Apple" and go to "System Preferences".

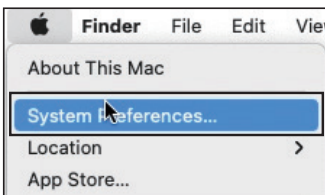

- (4) Select "Security & Privacy".



- (5) Under "General", click "Open Anyway" to set up.

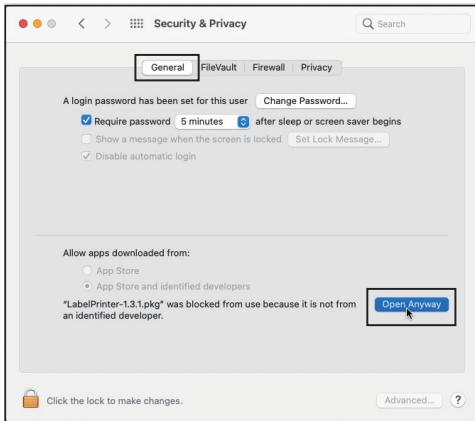

- (6) Input the password of your Mac. Then click "Modify Settings".
Note: If you didn't set a password, please skip this step.

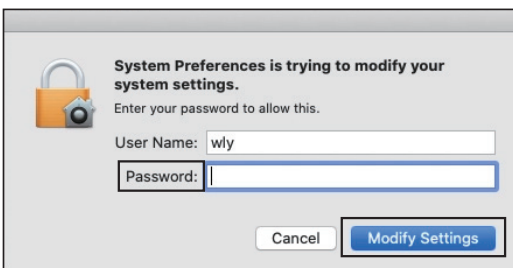

- (7) Click "Open" and continue to install the driver.

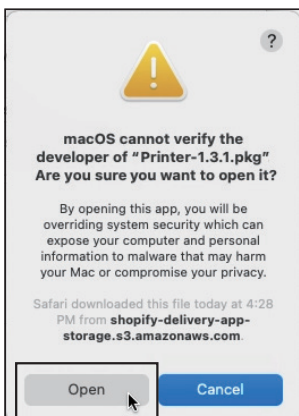

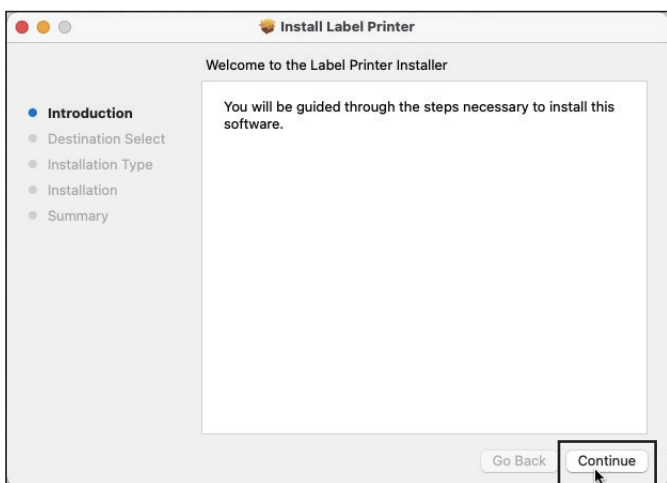

macOS STEP 2. Driver Installation

B

- (1) Follow the installation steps until you receive the "Installation was successful" message.

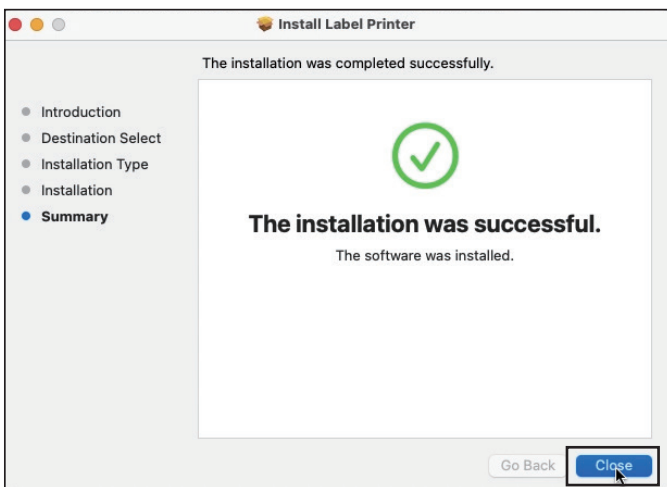

- (2) Click "Apple" and go to "System Preferences".

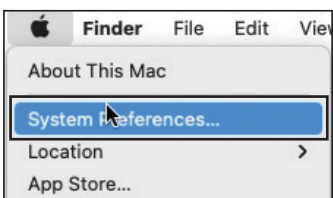

- (3) Select "Printer & Scanners".

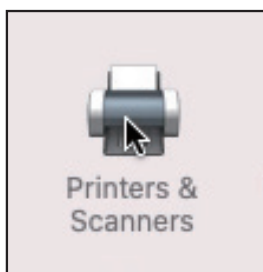

- (4) Click "+" to add a printer .

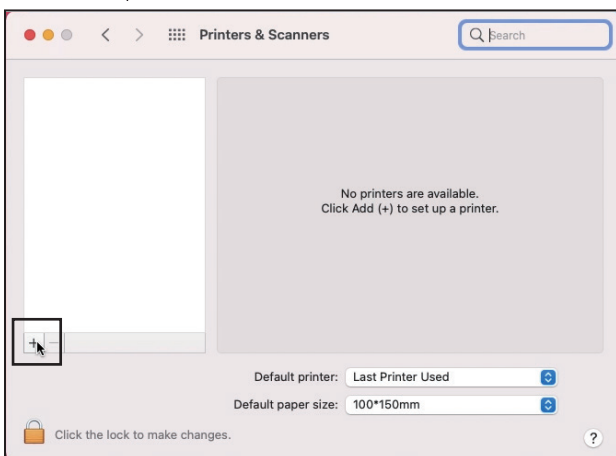

(5) Select "PM-241-BT" -> Click "Select Software" under "Use".

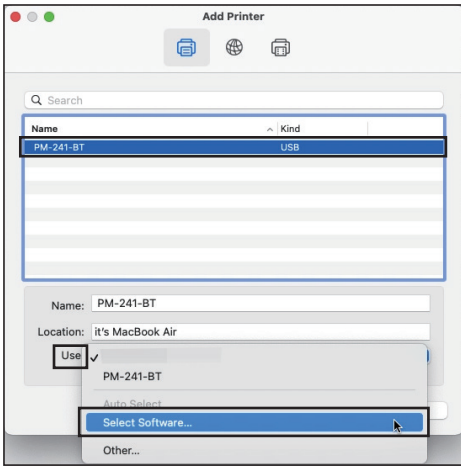

(6) Select "PM-241-BT" and click "OK".

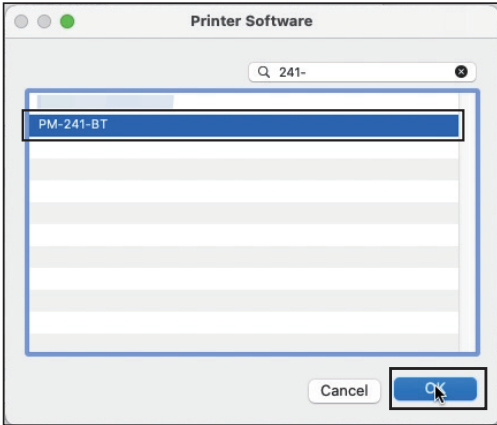

(7) Click "Add".

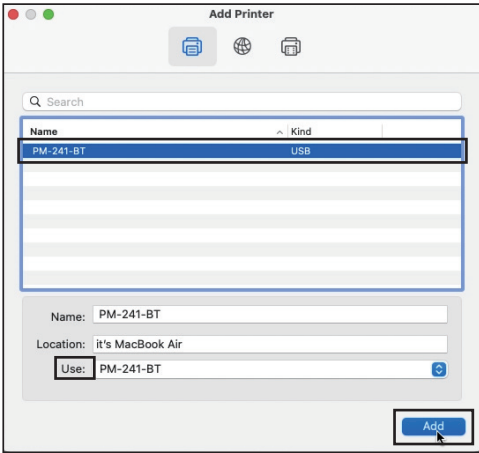

(8) Print test page

① Click "Open Print Queue..."

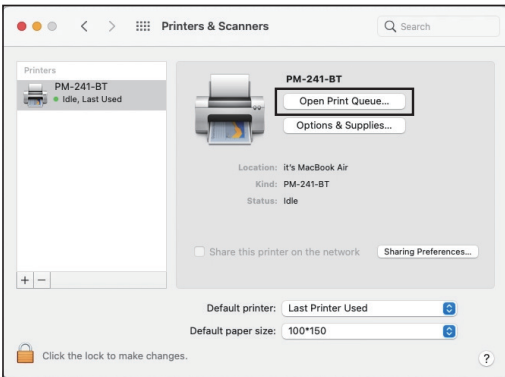

② Click "Printer" and "Print Test Page"

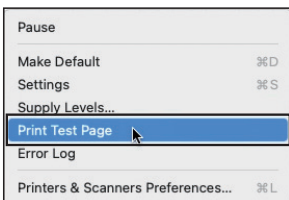

macOS

STEP 3. Printer Setup

B

(1) Print a sample label: Open a desired file (e.g. a PDF) through Preview .

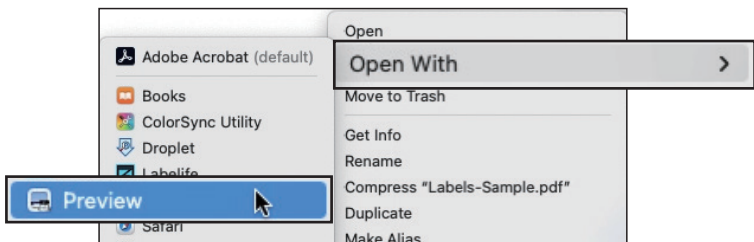

(2) Click "File" and choose "Print".

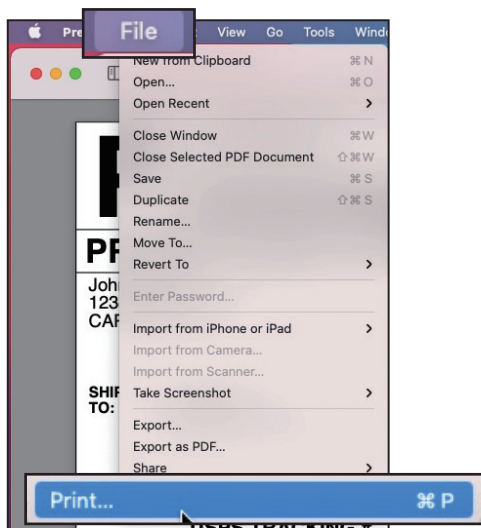

(3) Select "Show Details".

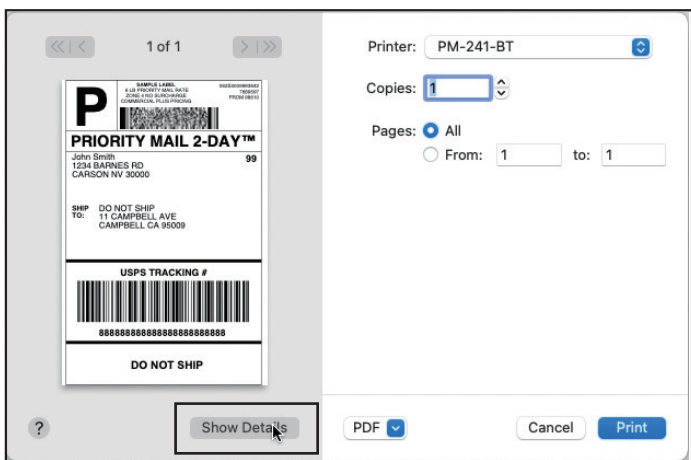

(4) Check your printer and choose a paper size from "Paper Size".

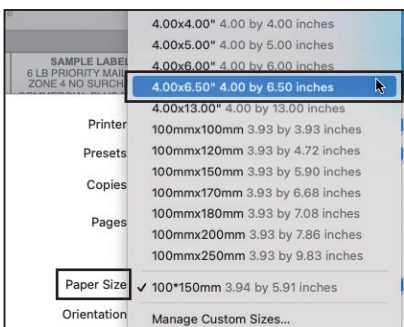
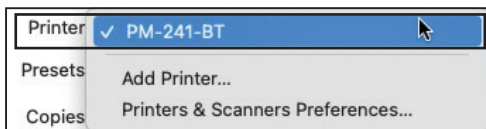

① If there is no suitable label size for you, please click "Manage Custom Sizes" to add the size.

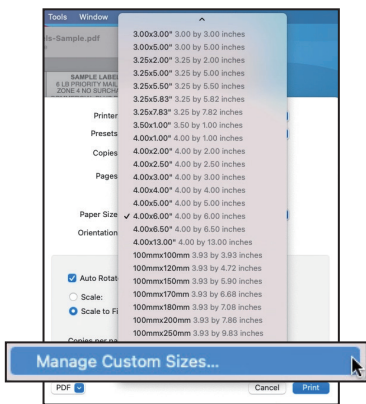

② Create a new label size, rename, input width and height and check Non-Printable Area, then click "OK".

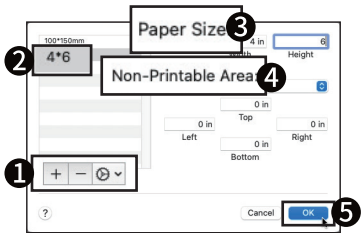

③ Choose the created size from "Paper Size".

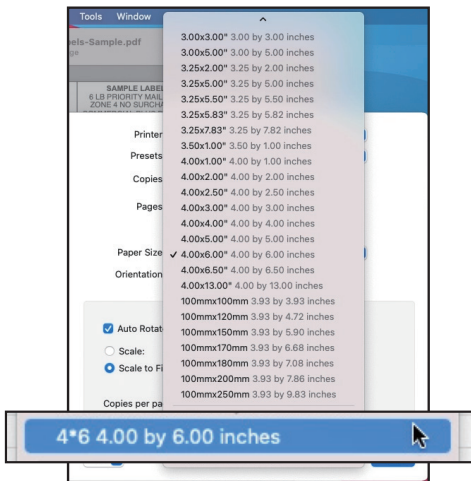

(5) Select "Printer Features" in "Preview", you can set up the printer properties here, such as "Media Tracking", "Darkness" and "Print speed".

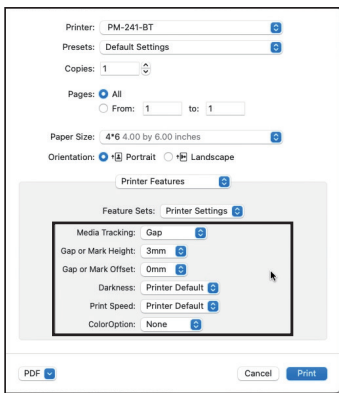
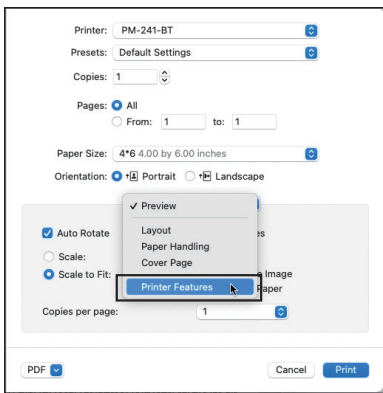

① Select paper type in "Media Tracking". Choose among "Continuous", "Gap" or "Black Line".

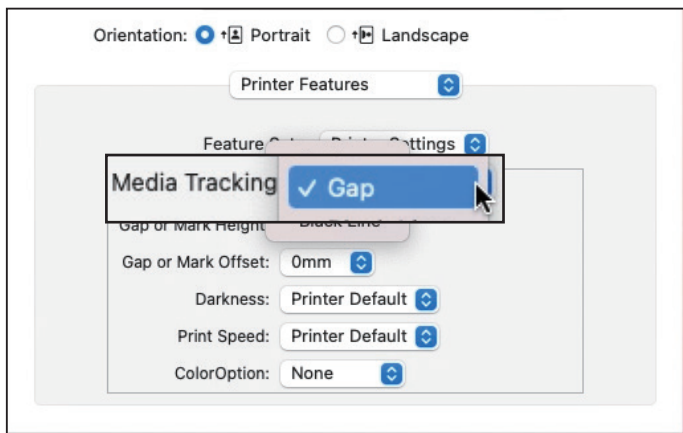

- ② You can change the Printing Speed and the Darkness of your printing (Larger number means higher Darkness).

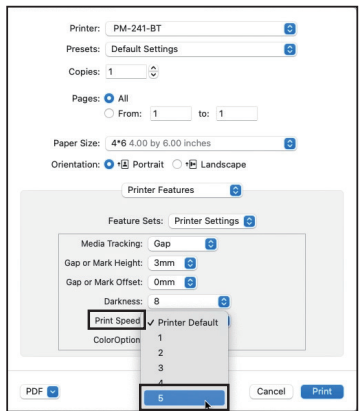
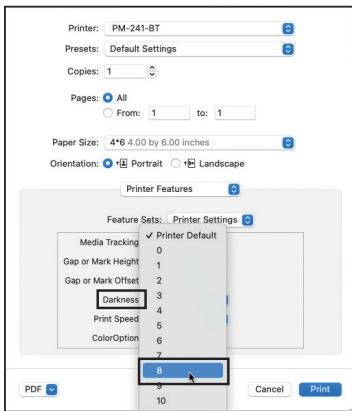

- (6) After setup, click "Print".

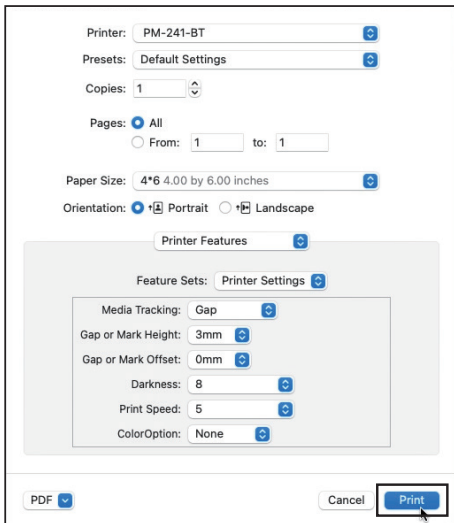

Windows

STEP 1. Driver Installation

C

- (1) Double click on the installer to begin. Follow the installation steps until finish.

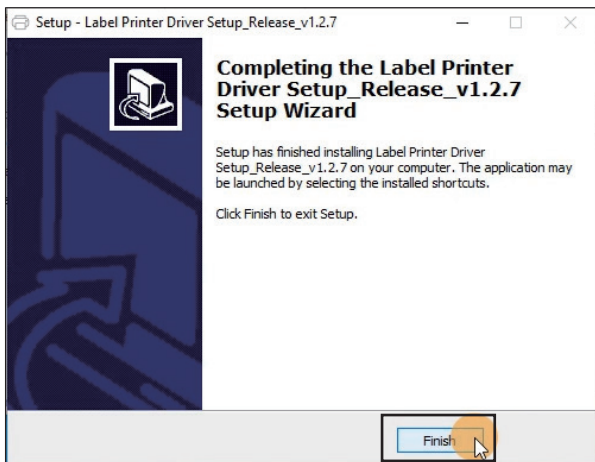

- (2) To check if the printer is connected successfully:

- ① Right click on "This PC", choose "Properties", then click on "Control panel" -> "Devices and Printers".

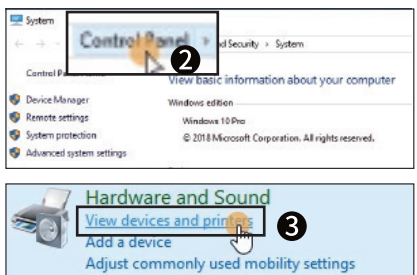
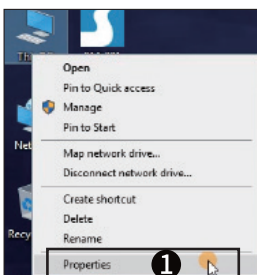

② Right click on "PM-241-BT" -> "Printer Properties"-> Click on "Print Test Page".

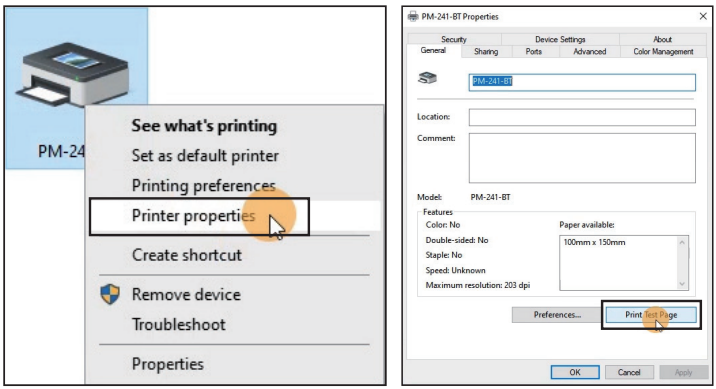

Windows STEP 2. Printer Setup

C

(1) Set as default printer

Right click on "PM-241-BT" -> "Set as default printer".

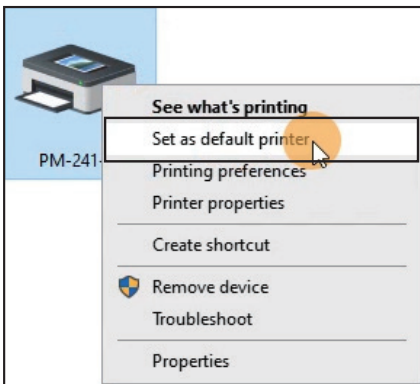

(2) Select a paper type

① Right click on "PM-241-BT" -> choose "Printer Preferences".

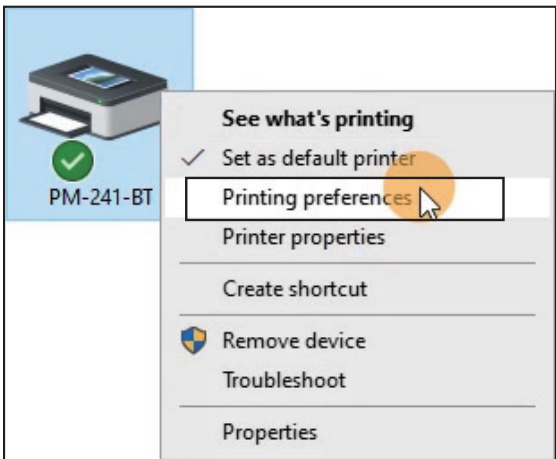

② Go to the "Page Setup".

You can choose the size you need in "Paper Name".

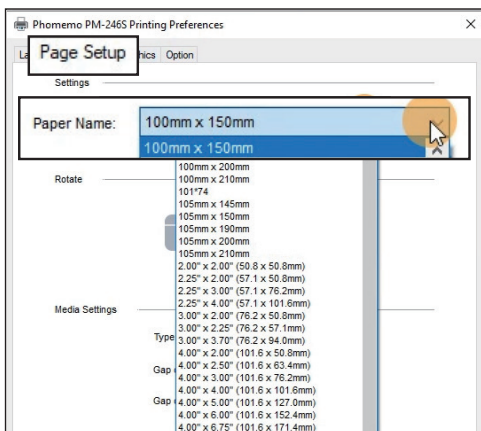

③ If there is no suitable label size for you, please click on "New" to create the needed size.

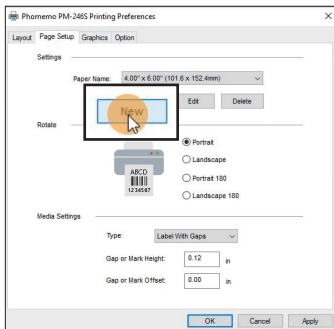

④ Change Paper name and input the width and the height, click "OK".

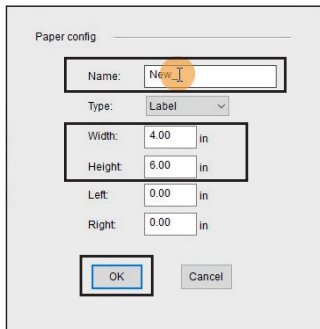

(3) Set up Print speed and Darkness

Go to "Option". You can change the printing speed and the Darkness of your printer (Larger number means higher Darkness) and click "Apply -> OK".

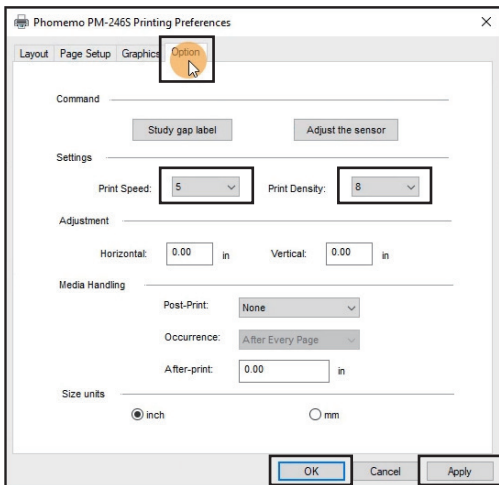

(4) Adjust the sensor and Study gap label.

Click "Adjust the sensor" to adjust printer sensor, then click "Study gap label" to let the printer learn the gap label.

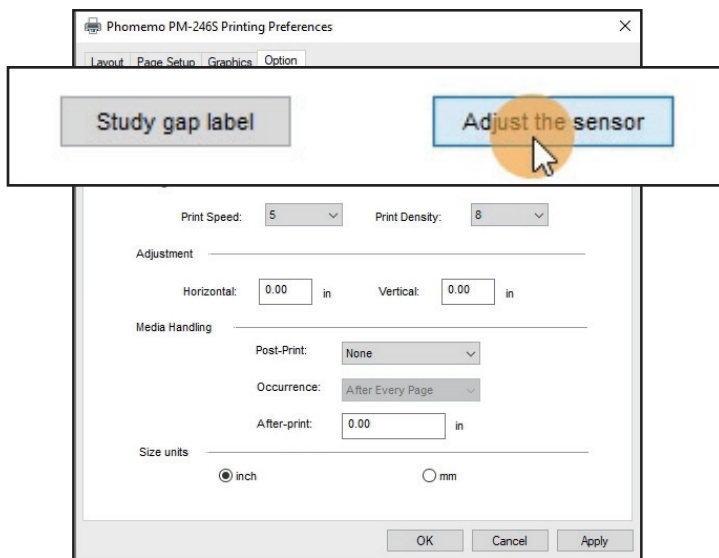

If printer flashes the blue light, it means that the learning has failed, then you need to repeat the above 2 button clicks again.

(5) Print a sample label: Open a desired file (e.g. a PDF).

① Click on "Print"

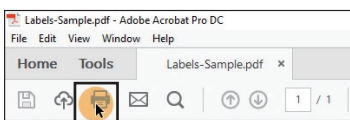

② Select the printer "PM-241-BT".

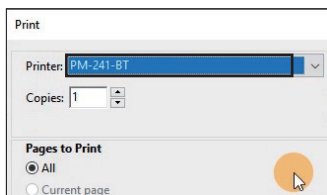

③ Preview and check the print size, then click "Print".



1. Adobe Use Tips

D

Adobe supports printing labels in both ways: Take Snapshot and Crop Pages (paid)
Position of function of Take Snapshot

(1) "View" -> "Show/Hide" -> "Toolbar Items" -> "show Edit Tools" -> "Take Snapshot"

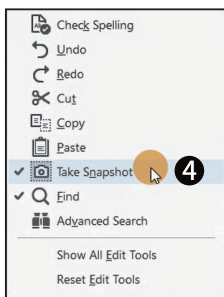
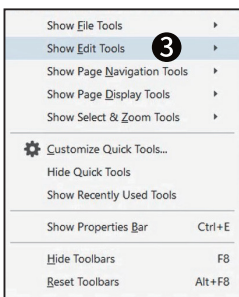
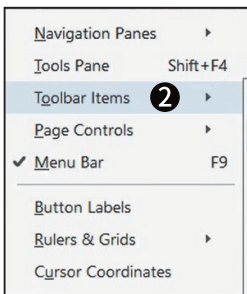
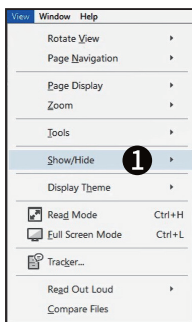

(2) "Edit" -> "Take a Snapshot" -> Drag the box over your label

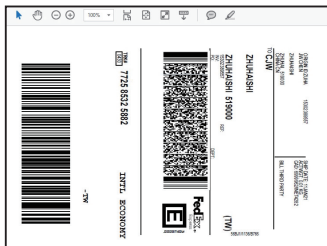

If you want to know more about detailed tutorial, you can get it in the following ways:
Method 1: Complimentary USB driver (USB driver -> Support & How-Tos & Platform Setup -> 4.How-Tos & Platform Setup)
Method 2: Search for brand names on YouTube

2. Labelife Use Tips

D

Labelife is a free and customizable label software. You can use "Labelife" software to customize and print barcode labels on your desktop.
Labelife PC can be used by connecting the computer with power cord and USB cable.
Labelife APP can be used by turning on the phone's Bluetooth to attach the printer

If you want to know more about detailed tutorial, you can get it in the following ways:
Labelife PC: Open Labelife PC -> Help -> Tutorial
Labelife App: Open Labelife App -> Setting -> Tutorial

3. Solution for Not Finding the Printer (Windows)

(1) Go to control panel -> Devices and Printers

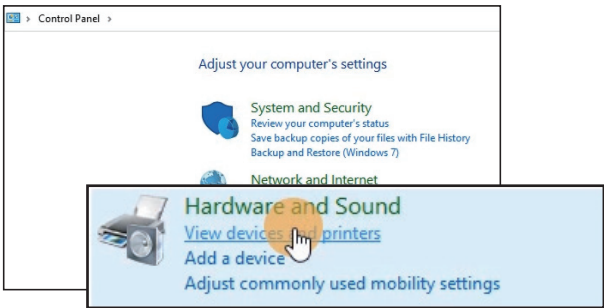

(2) Click "Add a printer"

(3) Click "The printer that I want isn't listed"

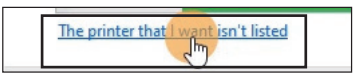
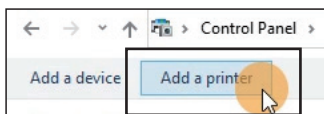

(4) Click "Add a local printer or network printer with manual setting" and click "next"

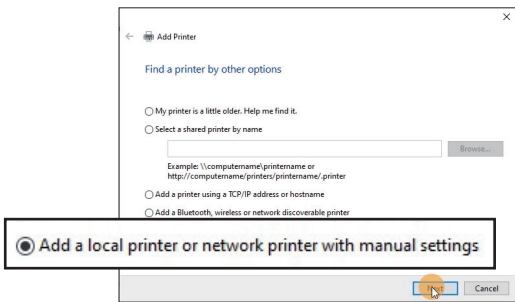

(5) To know which USB Port is connected, please right click on "This PC" and choose "Manage" -> "Device Manager" -> "Universal Serial Bus controllers" -> Double click on "USB Printing Support"

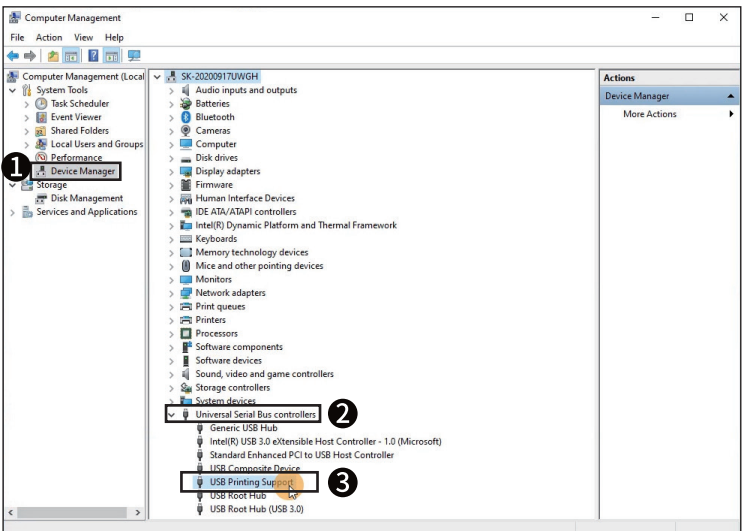
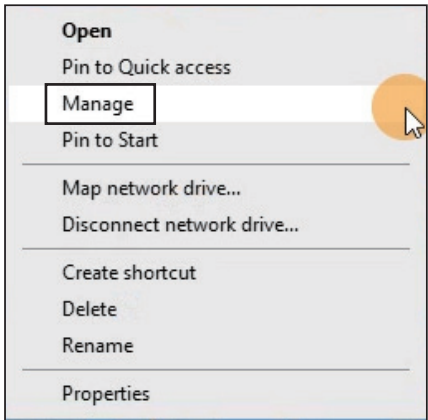
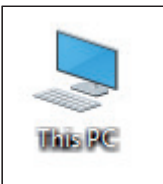

① ->Go to "detail", choose "Bus relations" to check which USB port is connected

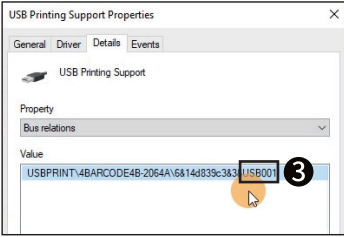
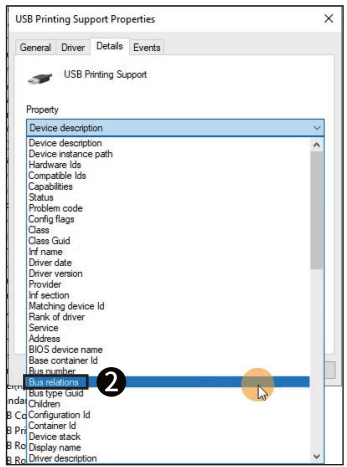
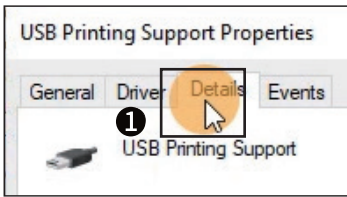

② Select "USB001(Virtual printer port for USB)"and click "Next"

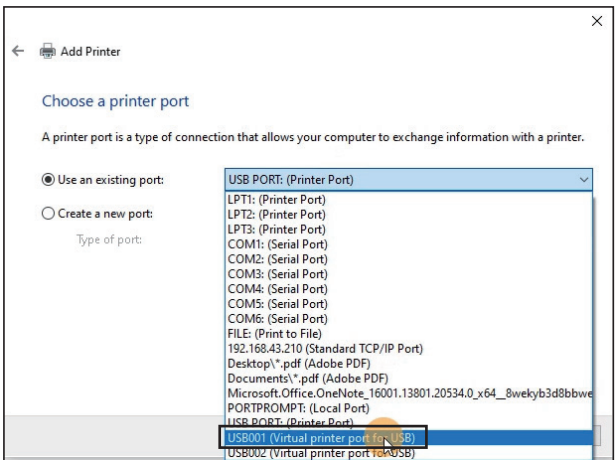

(6) Go back to the installation, click "Have Disk..."and click "Browse...". Select the file "QY.inf" in the installation path, then click "Open". (Default installation path: C:\Program Files\Label Printer\Label Printer\Driver)

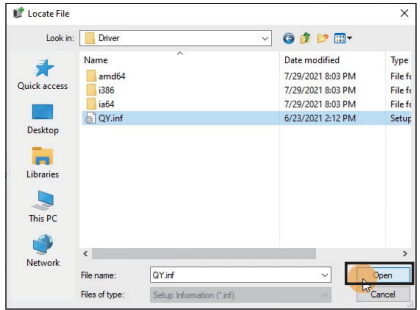
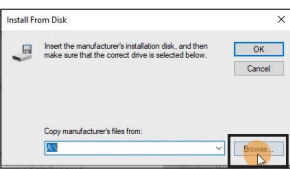
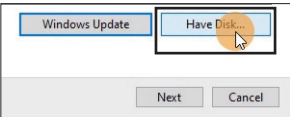

(7) Click "OK"and "Next".

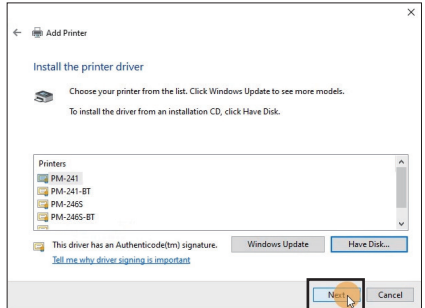
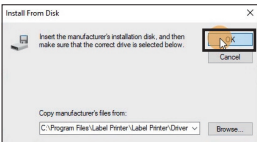

(8) Click "Print a test page"and "Close", then click "Finish".

