

IWISS HX-50BI Cable Lug Crimping Tools

General Information

- The HX-50BI is designed to crimp 8 AWG to 1/0AWG.
- Precise Gearing minimizes potential for tooth breakage, improving tool durability.
- Laser-Cut Dies More dimensionally accurate than stamped dies.
- Engraved Crimp Groove allows for easy verification the connection was made properly.



Tooling

Model	HX-50BI
Type	Crimper
Capacity	AWG 8/6/4/2/1/(1/0)
Weight	1.3kg
length	390mm

Model	LK-60A
Type	Cutter
Capacity	Up to 2/0AWG
Weight	0.48kg
Length	245mm

Instruction

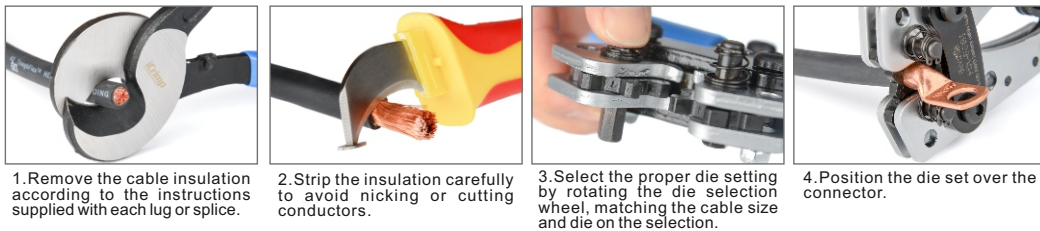

1. Remove the cable insulation according to the instructions supplied with each lug or splice.
2. Strip the insulation carefully to avoid nicking or cutting conductors.
3. Select the proper die setting by rotating the die selection wheel, matching the cable size and die on the selection.
4. Position the die set over the connector.

Important Safety Information

	⚠ WARNING A person who has not read and does not understand all operating instructions is not qualified to operate this tool. Failure to read and understand safety instructions may result in injury or death.		⚠ WARNING Electrical shock hazard: This tool is not insulated. Contact with live circuits can result in severe injury or death.
	⚠ WARNING Wear eye protection when using this tool. Failure to wear eye protection can result in serious eye injury from flying debris.		⚠ CAUTION This tool is intended for two-handed operation. Maintain a firm grip on both handles during operation. Using this tool in any other manner can result in injury or damage to the tool.

IWS-0801C & IWS-1040 MULTIFUNCTIONAL CRIMP TOOLS

Features

- Polished & tempered dies for increased durability and corrosion resistance.
- Loose parts free heavy duty crimp tool.
- The compact design allows for easy storage and handling.

Scope

Model	IWS-0801c	IWS-1040S
Crimp Wire Size	8-1AWG	1/0-4/0AWG
Crimping Profile	Hexagonal	Hexagonal
Die Configuration	Built-in	Built-in
Crimping Mechanism	Mechanical	Mechanical
Terminal Type	Battery Lug	Battery Lug
Highlight	Built-in Cutter	Large Crimping Capability



Instruction

IWS-0801C



1. Cut off certain length of wire with the built-in cutter.
2. Strip the insulation carefully to avoid nicking or cutting conductors.
3. Position the die set over the connector.
4. A perfect hexagonal crimping result.

IWS-1040S

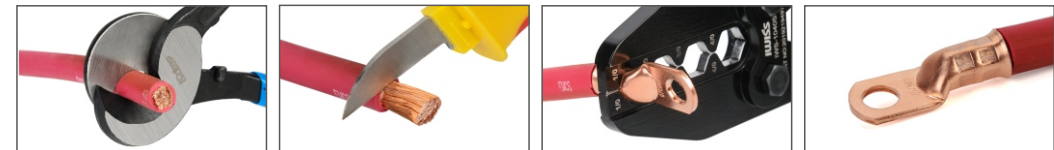

1. Cut off certain length of wire with the built-in cutter.
2. Strip the insulation carefully to avoid nicking or cutting conductors.
3. Position the die set over the connector.
4. A perfect hexagonal crimping result.

UL Listed Battery Lug Assortments



B0827K1BLV



B0827JXFYQ

Type
Ring
Comments
Heavy Duty
Termination Interface
Crimp or Compression

