

Quick Installation Guide

M100 Pro

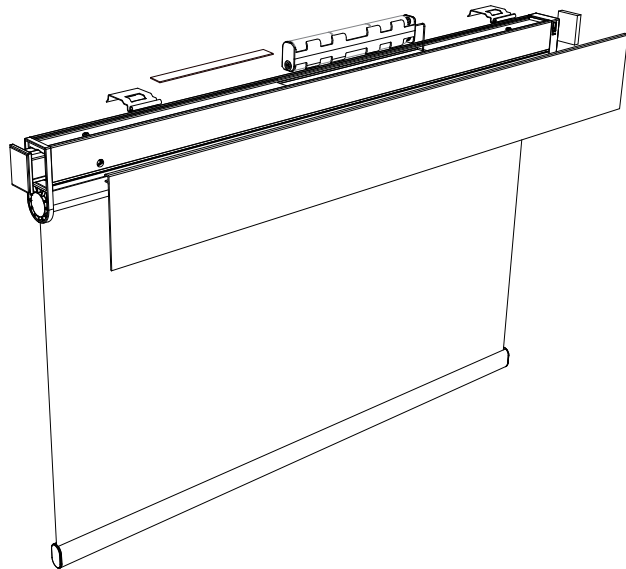

Tuya
Hub not included



Fast Setup



External Battery
Rod Supported



Quiet Motor

Details of Parts Included in Package

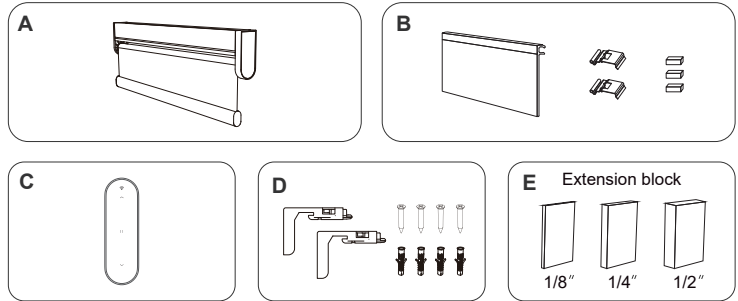

Battery installation

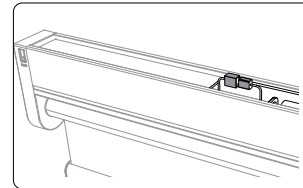

① Connect the battery.

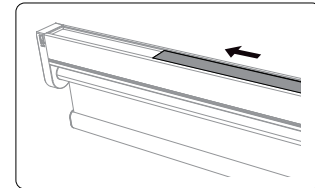

② Close the battery cover.

Change The Battery

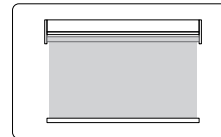

① Remove the shade.

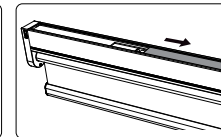

② Open the battery cover.

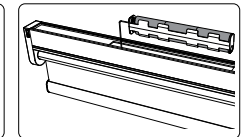

③ Replace the battery
(AA*6)

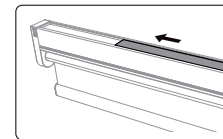

④ Close the battery cover.

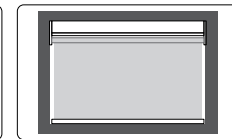

⑤ Install the shade
on the bracket.

Installation Guide

Inside Mount

Inside Mount: No Tools-No Drill design allow it no need to drill any holes on your window frame, easy to install

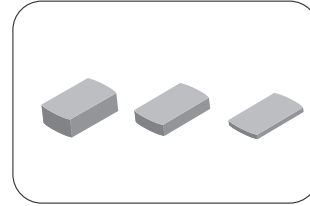
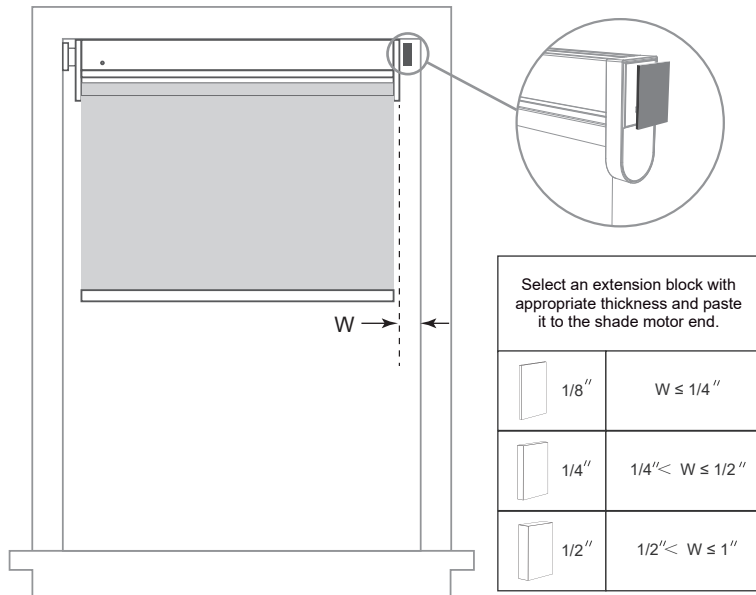

In case of the occasion that shade width is less than the window width we provide 3 widths of the extension block .

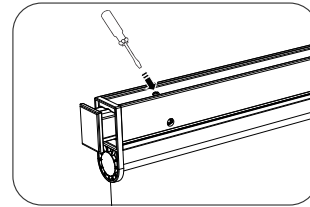

Before usage, the safety screw (protecting the nail-free structure) must be removed to achieve expansion and contraction.

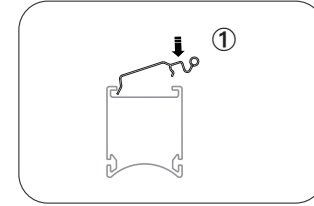

① Install the trim panel bracket.

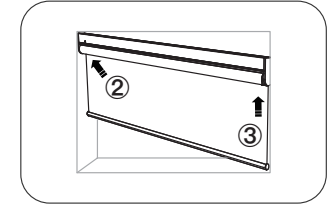

② Push the shade to the left and pressed against the wall.

③ Push up the right end of the shade and put it into the window frame.

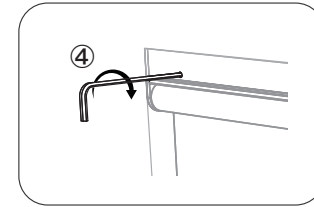

④ Tighten the safety lock.

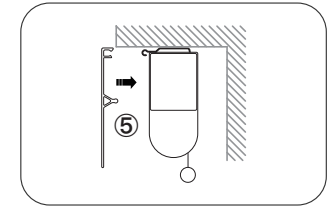

⑤ Install the trim panel.

Outside Mount

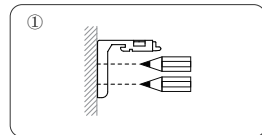
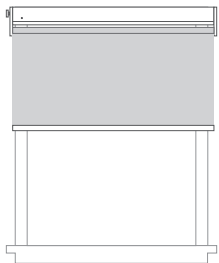

① Decide on and mark the positions of the two brackets with a pencil, using pencil marks as a guide.

(We suggest marking at 1/3 and 2/3 of the total length of the shade.)

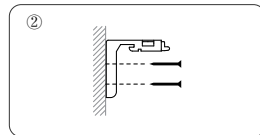

② Drill holes at marked locations.

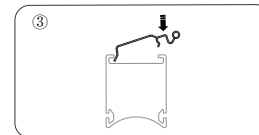

③ Install the trim panel bracket.

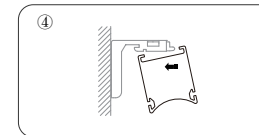

④ Hook the headrail of the shade into the front of the bracket, rotate the headtail until the back of it securely snaps into place.

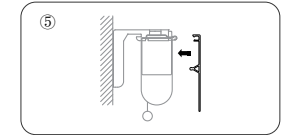

⑤ Install the trim panel.

NOTICE

Please read the installation instructions carefully to familiarize yourself with safe and effective usage before use. In addition, keep the installation instructions handy when using the product.

The brackets and screws apply to the wooden window frames, plasterboard walls and concrete walls, but they cannot be installed onto the window frames or ceiling which are not made up of wood, plasterboard and concrete.

Please check the materials and hardness of the window frames or ceiling before installation.

Make sure to comply with the quantity of brackets and installation location required in the installation instructions when installing the products. Improper installation could cause the shades dropping and bring damage to health or property.

Please do not hang any items on the product or pull the product roughly or fiercely.

The product is only suitable for indoor use and not for outdoor use.

Please do not use the product in a high heat or humid environment (such as saunas or furnace), or near an open flame.

Please close the window or push the shades up during high winds, otherwise the strong winds could cause the damage to the product or an accident.

Please do not place any items which can interfere with operating the shades within a range of moving up and down.

Function Key Description

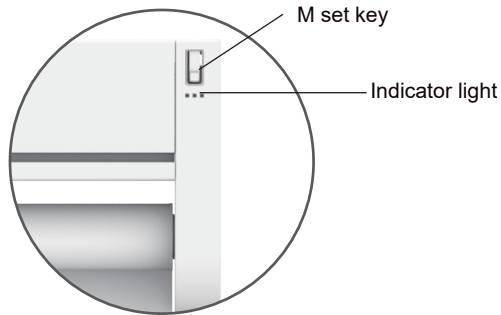

Motor

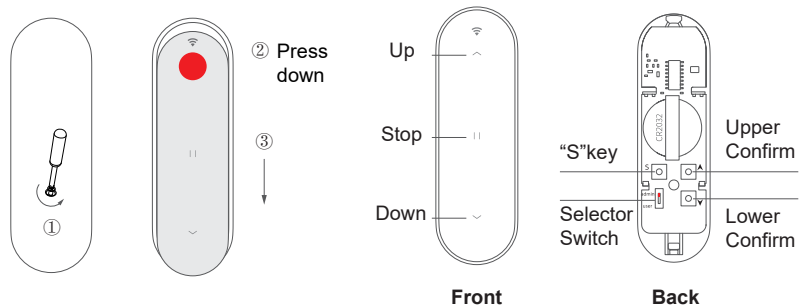

Emitter

The shade has been adjusted to the best condition before delivery, so it does not need to be adjusted again. If you want to adjust, please refer to the following advanced setting functions.

Quick Matching



Step 1
Install the dry battery. Make sure the motor is energized.

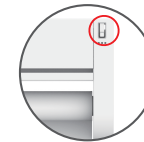

Step 2
Press the motor "M" button for 2", the motor rotates back and forth once. The motor enters the matching state, (Valid for 60 seconds)

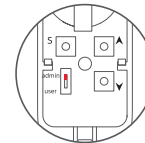

Step 3
The switch selects "admin" mode

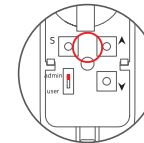

Step 4
Long press "S" for 2" The motor will rotate back and forth once. Match successfully

⚠ The running direction of the blinds is opposite to that of the emitter button. Refer to "motor reversing"



"admin" mode

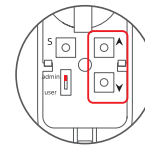

Step 1: Set Highest Point

Use the button on the front to adjust the shade at the position you want. Press for 2 seconds, the motor rotates once. This position is set as the highest point.

Step 2: Set Lowest Point

Use the button on the front to adjust the shade at the position you want. Press for 2 seconds, the motor rotates once. Then this position is set as the lowest point.

⚠ In admin mode, you can switch between inching operation and continuous operation, to adjust it more accurately.



Press 1 time, the shades will be in inching operation.

Press 2 time, the shades will be in continuous operation.

Advanced Settings



"admin" mode

Emitter channel shows slow flash

1. Motor reversing

The running direction of the blinds is oppsite to what shows on the emitter button.

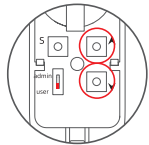

Method 1

- ▲ Press both together until the
- ▼ motor rotates once



Method 2

Press M key 10" motor rotates the third time

2. Delete emitter matches

- (1) The swich selects "admin" mode
- (2) Press "S" 5 times, motor rotates once. The match is deleted.

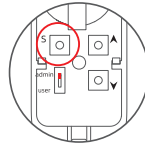

"user" mode

In user mode, you can operate and use this product normally without worrying about any misoperation to the motor.



Add a new emitters

A motor can match one or more emitters emitters need to be matched. See "emitter quick matching"

There's a quick way to copy it

- (1) The switch selects "user" mode.
 - (2) Operate mated emitter. (Select the channel you want to copy.)
Press "S" 1 time, motor rotates once
Press "S" 1 time again, motor rotates once
 - (3) Operate emitter to be added. (Select the channel you want to add)
Press "S" 1 time, motor rotates once
- Copy complete. Repeat 1-2, delete emitter.

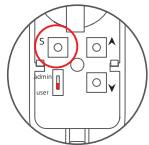

	Operation	The motor feedback	Function
 Motor "M" Key	Repeated short press	Turn-Stop-Turn-Stop Circular motion	Emergency use in case of travel
	Press for 2"	Motor rotates once	The motor enters the matching state
	Press for 5"	Motor rotates twice	/
	Press for 10"	Motor rotates three times	Motor reversing
	Press for 15"	Motor rotates four times	Restore the factory

	Indicator status	Reason
 Motoranzeige light	Slow flash	Low battery warning