

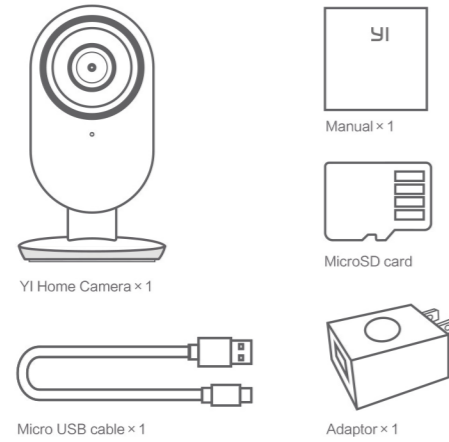

## 1. Camera Kit



Thank you for choosing YI Home Camera 2

## 2. Getting to Know the Camera

Resetting the camera: remove the back cover (see next section), and use a clip to long press the reset button until the yellow light comes on

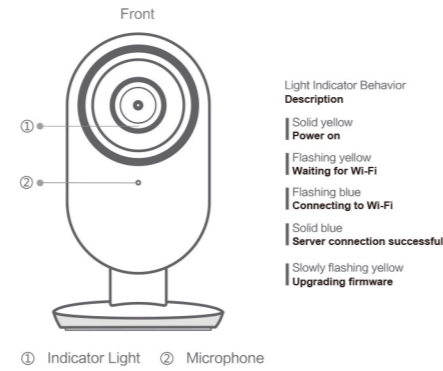

Removing the back cover: squeeze the right and left bottom corners and slide the cover up.

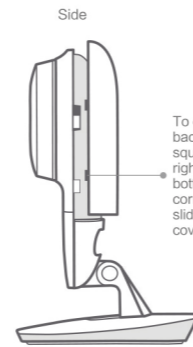

Inserting the MicroSD card: remove the back cover, and insert a MicroSD card from the side in the slot as shown below

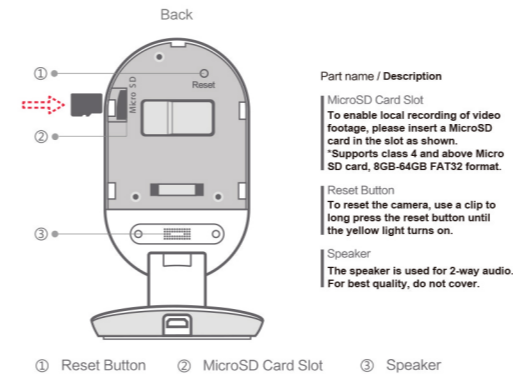

## 3. Download the APP

Download the app by searching "YI Home" on the App Store™ or Google Play. Alternatively, you can open a QR scanner app and scan the YI Home app QR code below to install the app



## 4. Sign Up and Login

- 1. Open YI Home app and select "North America" as your login location.
2. Enter your login credentials. If you do not have an account you can create one by pressing "Sign Up" and follow the instructions on the app to create your YI account. Alternatively, you can use your Facebook account to log in.

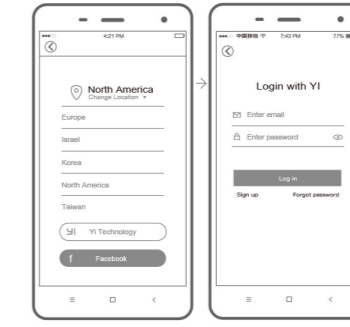

## 5. Power Up the Camera

Place the camera close to the router, and make sure Wi-Fi access is available, then connect the cable to the Micro USB port on the back of the camera to the power outlet as shown.

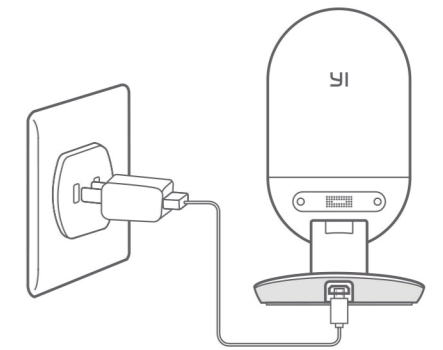

## 6. Connect the Camera to Your Phone

- 1. On the home screen, press the add icon "+" on the right upper corner to pair your camera.
2. Follow the simple set up instructions in the app. You can configure multiple cameras one at a time.



## 7. Preview Live Footage

1. Use the YI Home app to watch live footage on your phone. You can also record and save videos or images.

Attention: It is illegal in many jurisdictions to record an audio conversation without the consent of all individuals. Please comply with all laws when using your YI Home Camera.

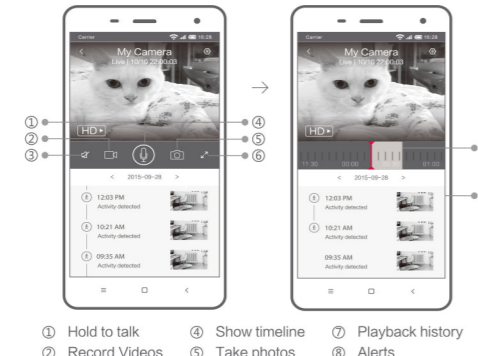

## 8. Switch Wi-Fi Networks

When you need to switch Wi-Fi networks or update your Wi-Fi password, follow the instructions below:

- 1. Use a clip to press the reset button on the back of the camera, and wait until the yellow light comes on.
2. Open the YI Home app on your phone, and complete step 6 Connect the Camera to Your Phone again. Your videos stored on your MicroSD card will not be affected.

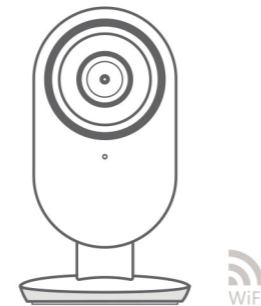

## Recommendations

- 1. Place the camera in open areas with Wi-Fi signals and away from metal objects.
2. Avoid placing the camera behind furniture, near microwaves, or in locations with cables twisted together.

This product is designed, manufactured, and assembled in China. The sale and intended operating environment of this product is limited to United States. As such, part or all of the services and functionalities are not guaranteed to be available when this product is used outside the United States.



## Important safety guidelines

- 1. Read these instruction.
2. Clean only with dry cloth.
3. This camera is for indoor use only.
4. Only use attachments/accessories specified by the manufacturer.
5. Unplug this apparatus during lightning storms or when unused for long periods of time.
6. To get the best usage out of this product, please consistently update to the latest versions of our app and firmware.

WARNING: Open flame sources such as candles should not be placed near or on the product.

Note: "Xiaoyi" and "YI" logo are trademarks of Shanghai Xiaoyi Technology Co.,Ltd.

This device complies with Part 15 of the FCC Rules / Industry Canada licence-exempt RSS standard(s). Operation is subject to the following two conditions: (1) this device may not cause harmful interference, and (2) this device must accept any interference received, including interference that may cause undesired operation.

Le présent appareil est conforme aux CNR d'Industrie Canada applicables aux appareils radio exempts de licence. L'exploitation est autorisée aux deux conditions suivantes : (1) l'appareil ne doit pas produire de brouillage, et (2) l'utilisateur de l'appareil doit accepter tout brouillage radio électrique subi, même si le brouillage est susceptible d'en compromettre le fonctionnement.

Congratulations! Your YI Home Camera is ready to use.

Changes or modifications not expressly approved by the party responsible for compliance could void the user's authority to operate the equipment.

This equipment has been tested and found to comply with the limits for a Class B digital device, pursuant to part 15 of the FCC Rules. These limits are designed to provide reasonable protection against harmful interference in a residential installation. This equipment generates uses and can radiate radio frequency energy and, if not installed and used in accordance with the instructions, may cause harmful interference to radio communications. However, there is no guarantee that interference will not occur in a particular installation. If this equipment does cause harmful interference to radio or television reception, which can be determined by turning the equipment off and on, the user is encouraged to try to correct the interference by one or more of the following measures:

- Reorient or relocate the receiving antenna.
• Increase the separation between the equipment and receiver.
• Connect the equipment into an outlet on a circuit different from that to which the receiver is connected.
• Consult the dealer or an experienced radio/TV technician for help.

Under Industry Canada regulations, this radio transmitter may only operate using an antenna of a type and maximum (or lesser) gain approved for the transmitter by Industry Canada. To reduce potential radio interference to other users, the antenna type and its gain should be so chosen that the equivalent isotropically radiated power (e.i.r.p.) is not more than that necessary for successful communication.

Conformément à la réglementation d'Industrie Canada, le présent émetteur radio peut fonctionner avec une antenne d'un type et d'un gain maximal (ou inférieur) approuvé pour l'émetteur par Industrie Canada. Dans le but de réduire les risques de brouillage radioélectrique à l'attention des autres utilisateurs, il faut choisir le type d'antenne et son gain de sorte que la puissance isotrope rayonnée équivalente (p.i.r.e.) ne dépasse pas l'intensité nécessaire à l'établissement d'une communication satisfaisante.

MPE Requirements: To satisfy FCC / IC RF exposure requirements, a separation distance of 20 cm or more should be maintained between the antenna of this device and persons during device operation. To ensure compliance, operations at closer than this distance is not recommended. Les antennes installées doivent être situées de façon à ce que la population ne puisse être exposée à une distance de moins de 20 cm. Installer les antennes de façon à ce que le personnel ne puisse approcher à 20 cm ou moins de la position centrale de l'antenne. La FCC des États-Unis stipule que cet appareil doit être en tout temps éloigné d'au moins 20 cm des personnes pendant son fonctionnement.

