



# Z2

Wireless  
headphones

ACTIVE NOISE CANCELLATION

## User's Manual

Please read this  
manual before  
using the product



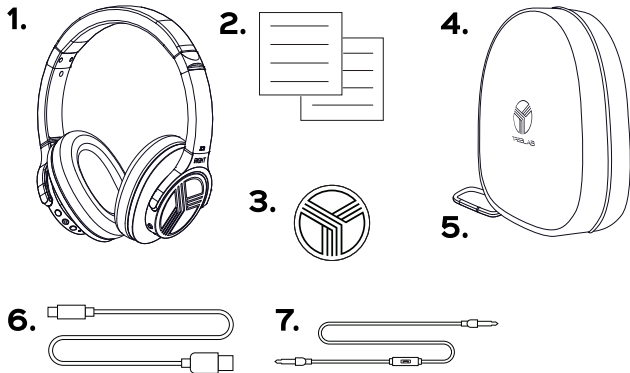

**Z2**

1. TREBLAB Z2 headphones
2. User's manual
3. Round TREBLAB sticker
4. Carrying case
5. Carabiner
6. Charging micro USB cable
7. 3.5 mm audio cable with mic

## Thank you for choosing TREBLAB Z2!

The over-ear headphones with Bluetooth® 5.0 and Active Noise Cancellation technology provide superior sound quality and the convenience of hands-free operation.

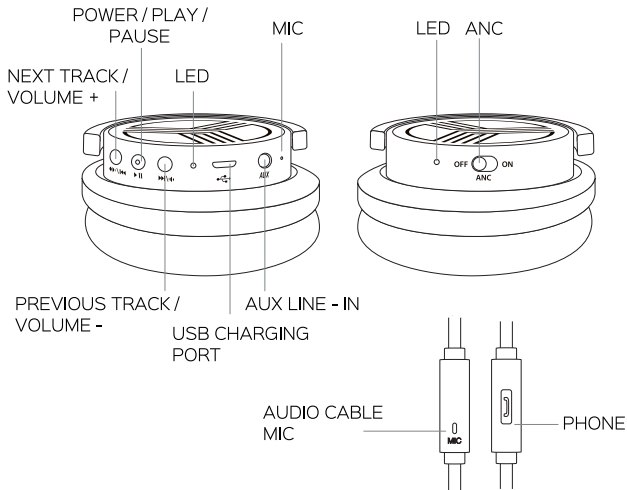

Function	Operation
Power On	Press the <b>POWER</b> button for 3 seconds
Power Off	Press the <b>POWER</b> button for 3 seconds
Gaming mode	Press the <b>POWER</b> button three times
Play / Pause	Press the <b>POWER</b> button
Volume +	Press the <b>Volume +</b> button
Volume -	Press the <b>Volume -</b> button
Next track	Press and hold the <b>Volume +</b> button for 1 second
Previous track	Press and hold the <b>Volume -</b> button for 1 second
Answer a phone call	Press shortly the <b>POWER</b> button during the incoming call
Reject a phone call	Press and hold the <b>POWER</b> button during the incoming call for 2 second
End a phone call (Hang up)	Press shortly the <b>POWER</b> button during the conversation
Voice assistant activation	Press the <b>POWER</b> button twice
ANC	Switch the <b>ANC</b> tumbler to the ON position

## SETTING UP YOUR TREBLAB Z2

### Turn ON

Press the **POWER** button for 3 seconds. You will hear the “Power ON” and, a few seconds later, “Pairing” voice prompts. The LED will start flashing blue and red.

### Turn OFF

Press and hold the **POWER** button for 3 seconds. You will hear a “Power OFF” voice prompt. The red LED light will appear for a second and go off.

## PAIRING

Make sure **TREBLAB Z2** are charged and the 3.5 mm audio cable is not plugged in.

1. Press and hold the **POWER** button for 3 seconds. You will hear the "Power ON" and, a few seconds later, "Pairing" voice prompts. The LED will start flashing blue and red indicating that **Z2** are in pairing mode.
2. Activate the Bluetooth option on your smart device and keep it within 3 feet / 1 meter from **TREBLAB Z2** while pairing.
3. Scan/search for available devices in your smart device.
4. Select **TREBLAB Z2** from the device list.
5. If prompted the password, enter “0000”.

6. Once **Z2** are successfully paired and connected, you will hear the “Connected” voice prompt, and the LED will start flashing BLUE slowly.

When you turn the headphones ON, they will try to reconnect with recently connected device/devices. If the reconnection does not happen automatically, the headphones will try to find the next device in the pairing list. The headphones can save the last 8 devices.

## GAMING MODE

**TREBLAB Z2** headphones support the gaming mode to reduce the audio latency up to 60ms. This allows to achieve better video/audio synchronization and improve your gaming and video watching experience.

1. To enable the gaming mode, press the **POWER** button three times. You will hear the one-tone sound prompt and feel the lower latency while gaming/watching videos.
2. To disable the gaming mode, press the **POWER** button three times again. You will hear two-tone sound prompt and the latency will go back to the standard 200ms.

**NOTE:** In the gaming mode, the connection range is much shorter than in standard one, so, if you are experiencing some connection issues or drops, please make sure to disable the gaming mode.

## AUX LINE-IN CONNECTION

You can connect **TREBLAB Z2** to compatible devices using the supplied 3.5 mm audio cable.

Plug one end of the 3.5 mm audio cable into the AUX LINE - IN port on the right earphone and plug the other end into the AUX jack on your device.

### NOTE:

Remote control for the functions NEXT, PREVIOUS, PAUSE and Volume adjustment by using the buttons on earcups is not supported when using the 3.5 mm audio cable. You will need to make all the adjustments using your smart device.

Some smart functions are supported by using the **PHONE** button on the 3.5 mm audio cable.

You can turn on iTunes on your notebook by pressing shortly the **PHONE** button. Press shortly the **PHONE** button to PLAY or PAUSE the music while iTunes is ON.

You can activate Voice Assistant on your smart device by pressing and holding the **PHONE** button for 1 second.

Press shortly the **PHONE** button to PLAY or PAUSE the music while your smartphone's music player is ON. Press the **PHONE** button twice to switch to the next track while listening. Press the **PHONE** button thrice to switch to the previous track while listening.



## AUDIO PLAYBACK

### Bluetooth mode

To pause and resume the playback when connected wirelessly, press shortly the **POWER** button.

To adjust the volume, press shortly the **Volume +** button to turn the volume up and **Volume -** button to turn the volume down.

To change tracks on **Z2**, press and hold the **Volume +** button for 2 seconds to play the next track and press and hold the **Volume -** button for 2 seconds to play the previous track.

### AUX line-in mode

Press shortly the **PHONE** button located on the 3.5 mm audio cable to play or pause the music while your music player is ON.

## ANC FUNCTION

The **TREBLAB Z2** headphones are equipped with Feedback Active Noise Cancellation (ANC) technology.

The headphones seal out background noise and sounds in your environment for an optimal acoustic experience.

To turn ON the ANC function, switch the **ANC** tumbler on the left earphone to the ON position. The LED indicator located next to the switch will turn RED.

## PHONE CALLS

**TREBLAB Z2** can be used to make and receive phone calls when connected wirelessly. Audio playback will be paused during the calls.

To answer a call: Press shortly the **POWER** button.

To reject a call: Press and hold the **POWER** button for 2 seconds.

To end a call: Press shortly the **POWER** button.

Multicalls: Press shortly the **POWER** button to answer the first call. When the second one is incoming, press the **POWER** button to pick it up. The first call will enter into the hold on status. Press the **POWER** button again to switch back and hold on the second call. Hold and press the **POWER** button to end the current call. Press shortly again to hang up the second one.

## VOICE ASSISTANT ACTIVATION

The **TREBLAB Z2** headphones support the voice assistant activation command. To use any of the voice assistants (supported voice assistants: SIRI® and Google Voice Assistant®)

while in the Bluetooth mode, press the **POWER** button twice. After the sound notification, you can transmit your voice commands using an inbuilt mic.

To activate the voice assistant while using the AUX LINE-IN connection, press and hold the **PHONE** button on the cable for 1 second.

## RESET THE MEMORY LIST

You can reset the **Z2** headphones to the factory default settings by cleaning up the pairing list with the last 8 connected to **Z2** devices.

Turn ON the **TREBLAB Z2** headphones. Press and hold the **Volume +** and the **Volume -** buttons at the same time for 5 seconds. The headphones will automatically turn off. The device memory is now returned to the factory settings.

## TROUBLESHOOTING

Problem	Solution
<b>Doesn't turn on</b>	Make sure the headphones are charged. Charge up to 4 hours until the battery is fully charged, if necessary. Press and hold the <b>POWER</b> button again for 3 second.

## **Music is not playing**

Make sure the headphones are charged. Make sure the 3.5 mm audio cable is correctly and firmly connected to the headphones if you are using the AUX mode.

Make sure the 3.5 mm audio cable has been removed from the headphones if you are using the Bluetooth connection.

Make sure the volume level is not set to a 0 level on both the headphones and the device.

Make sure that the distance between your device and the headphones is less than 30 feet / 10 meters.

Make sure your smart device's Bluetooth mode is ON and the device is not plugged into any kind of wired connection.

## **Headphones don't pair with my Bluetooth device**

Make sure the 3.5 mm audio cable is not plugged in.

Make sure the headphones are not paired with any other two devices, as it can only pair with two devices at a time.

Make sure that the distance between your device and the headphones is less than 30 feet / 10 meters. Make sure your smart device's Bluetooth mode is ON and

not plugged into any kind of wired connection.

**Headphones are visible on my device, but do not connect**

Make sure the headphones are not paired with any other two devices, as it can only pair with two devices at a time.

Make sure that the distance between your device and the headphones is less than 30 feet / 10 meters.

Disconnect the device from your headphones and remove **Z2** from your device's pairing list. Reset the headset by cleaning up the memory list. Try to pair again.

**I cannot find a wireless driver for on my laptop**

Make sure your laptop supports the wireless connection. If it doesn't, you will need an external wireless USB adapter compatible with your laptop.

For further details, consult with your laptop manufacturer.

**Frequent disconnection and noise**

Make sure that the distance between your device and the headphones is less than 30 feet / 10 meters.

Make sure that nothing is blocking the signal between your device and **Z2**.

Check if the music is paused.

Check if the headphones are running out of power.

## CHARGING AND BATTERY

To charge the headphones, plug the supplied cable into the micro USB charging port on the right ear-cup and the other end of the charging cord into a standard USB port. The LED light will turn RED. It takes up to 4 hours to charge **Z2** fully. The RED light will turn OFF when the headphones are fully charged.

One full battery charge provides up to 30 hours of playtime at medium volume and up to 22 hours at medium volume with the ANC activated function. When the battery is running low, you will hear the “Battery Low” voice prompt.

Be sure to use a 5V DC, 0.5-1A adapter or charger. Using a power source with lower power will increase the overall charging time. Unplug **Z2** from the charging cable and the cable from the power source when not in use. If left unused, a fully charged battery will lose its charge over time. We recommend charging **TREBLAB Z2** fully at least twice a month to maintain the sufficient battery life.

## SAFETY RULES

- ⚠ Don't disassemble or modify your headphones for any reason. Doing this may cause the headphones to malfunction or become combustible. The damage to your device can void your manufacturer's warranty.
- ⚠ Do not let your device get wet – liquids can cause serious damage. Damage to your device caused by water can void your manufacturer's warranty.
- ⚠ Make sure the headset is completely dry before charging.
- ⚠ Avoid exposing **TREBLAB Z2** to extreme temperatures (below 37°F / 3°C or above 112°F / 45°C). Extreme temperatures can cause the deformation of the **Z2** components, reduce the battery life and the lifespan of your new headset.
- ⚠ Don't put the device's LED lights close to humans' or animals' eyes
- ⚠ Do not use your **Z2** during a thunderstorm. Thunderstorms can cause serious malfunction and increase the risk of electric shock.

# RECYCLING

The earphones can be recycled, and they should be in order to keep our planet clean. Where should you bring them?

In the **US**, there are a couple of options:

**1.** Best Buy has a recycling program. Just take the broken headphones with you next time you visit a Best Buy store.

This link will help you find the best location:

<https://www.bestbuy.com/site/store-locator/>

**2.** Check for other possible locations next to you on these websites (just enter your ZIP to find a location):

<https://www.call2recycle.org>

<https://search.earth911.com>

<https://recyclenation.com/find>

<https://www.cta.tech/Consumer-Resources/Greener-Gadgets>

In **Canada**, please visit the links below:

<https://thinkreuse.net>

<https://www.call2recycle.ca>

In the **UK**, please visit the links below:

<https://www.recycle-more.co.uk/>

<https://www.recyclenow.com/local-recycling>



## SPECIFICATIONS

<b>Battery:</b>	620mAh 3.7V, rechargeable Li-Ion Input 5V / 1A
<b>Charging time:</b>	Up to 4 hours
<b>Voice assistant activation:</b>	Supported by the POWER button double press
<b>Bluetooth version:</b>	BT5.0, HFP v1.7, A2DP v1.3, AVRCPv1.5
<b>Audio playback support:</b>	AAC, SBC
<b>Signal Range:</b>	33ft / 10m
<b>Frequency response:</b>	20Hz – 20KHz
<b>Charging port:</b>	Micro USB
<b>Dimensions:</b>	203 x 162 x 82mm / 6.4 x 3.2 x 3.2in
<b>Weight:</b>	240g / 8.46oz / 0.53lb

## THANK YOU

We truly appreciate that you chose **TREBLAB** as your trusted brand of wireless ANC headphones. Our team sincerely hopes that you enjoy the great sound and seamless usability that **TREBLAB Z2** provide. We love making our customers happy by providing true value with our products. If for any reason you are not completely satisfied with your purchase or have any questions, please let us know by contacting us at [http://treblab.com/contact\\_us](http://treblab.com/contact_us). We care about our customers most of all and are always here to serve you.



**1 YEAR WARRANTY**  
**Parts and Labor Warranty.**

Please visit [www.treblab.com](http://www.treblab.com)  
to register YOUR product.  
Manufactured by Productech



TREBLAB

**Z2**

WIRELESS HEADPHONES

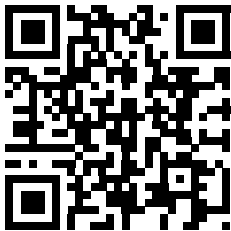

Made in China