

# USER MANUAL



# G17

## Customer Service

✉ Email: [service@gnmn.tech](mailto:service@gnmn.tech)

🌐 Web: [www.gnmn.tech](http://www.gnmn.tech)

📞 Phone Call: (781) 628-7817 [Mon. - Fri., 11am - 8pm EST]

## Packing List

Charging Case \*1

Ear Tips \*3 Pairs

Earbuds \*1 Pair

User Manual \*1

USB-C Cable \*1

## Specifications

- \* Model Name: G17
- \* FCC ID: 2A58W-G17
- \* Bluetooth Version: V5.3
- \* Support: A2DP/HFP/AVRCP/SPP/PBAP/BDR/BLE
- \* Transmission Range: ≤33feet (without obstacle)
- \* Headphones Battery Capacity: 50mAh
- \* Charging Case Battery Capacity: 3.7V 600mAh / 2.22Wh
- \* Input: DC 5V ⚡ 1A
- \* Charging Port: USB-C
- \* Wireless Charging Support: Yes (Charging pad not included)
- \* Music Time: 5H
- \* Phone Call Time: 4H
- \* Charging Time: about 1.5H

## Product Overview

Flexible Ear Hook

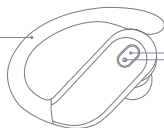

Button Control  
Earphone LED Light

Charging Contact

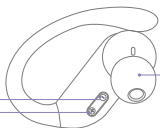

Ear Tip

Charging Case  
Power Display

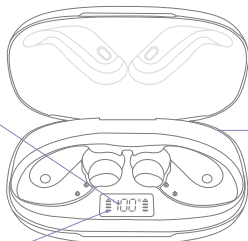

Earphones  
Power Display

Wireless  
charging Area

USB-C  
Charging Port



## Caution

1. Please remove the protective film before use, otherwise the headphone will not be able to charge.



Tear off the protective film

2. Choose suitable ear tips & Wear correctly to enhance sound quality.

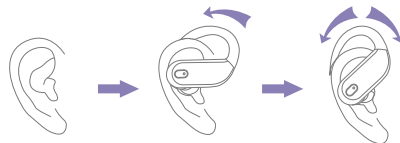

3. Please clean the magnet charging contact on earbud and charging pin on the charging case with alcohol wipes if the headphones can't be charged.



Charging Contact

Charging Pin

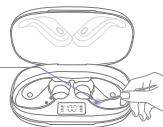

\* To fix charging issue

4. Please clean the protective grille of both earbuds if the sound becomes low.

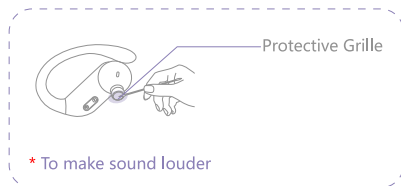

## How to Charge?

### Charge by USB-C cable

Place earbuds into charging case properly, then use the included USB-C charging cable to connect the charging case, and plug the other end into power supply with a 5V/1A adapter (not included), they will start charging.

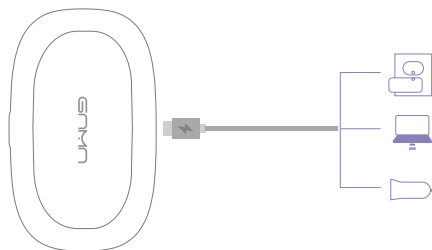

(\* The USB-C charging cable is in the black paper box.)

### Wireless Charging

Place the charging case on a wireless charging pad, it will start charging.

If the charging case doesn't start to charge, please try to reposition it.

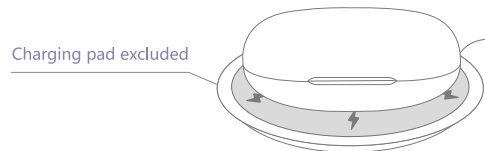



(We recommend you to use wireless charging pad with Qi certificate.)

#### Note:

1. If earbud's battery is lower than 10% (and the voltage is below 3.4V), you will hear voice prompt "battery low" four times and then "power off" in turns.
2. The fully charged charging case can recharge twins earbuds for 2-3 times without being plugged into power supply.

### LED Power Display

 Show the remaining battery percentage of charging case from 0-100. "0" means charging case need charging while "100" means the charging case is fully charged.

 Flash down and up when earbud is charging; Stop flashing when earbud is fully charged.

**Earbud's LED light:** Red light up means "being charged", Red light go off means "fully charged".

## Power On/Off & Pairing

### Automatically Power On/Off & Pairing

Prior to first use (or not in use for long time), please charge both earbuds and charging case fully.

1. Take twin earbuds out of charging case, they will automatically power on and enter pairing mode.

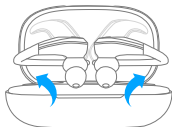

2. Activate the Bluetooth setting on your phone, search and connect "G17".



**Note:** If the earbuds are not connected to your device over 5 minutes, the earbuds will power off automatically.

3. Put the earbuds back into charging case, they will disconnect & power off automatically.

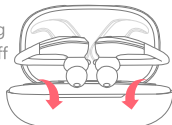

### Manually Power On/Off

If the earbud is out of the charging case and power off, then press & hold it for 2s, it will power on.

Disconnect the Bluetooth with your device, press & hold either earbud for 5s, both earbuds will power off at the same time.

### For Second Time Use

If the headphones have already connected with your device, and the Bluetooth setting of this device is on, in the second time using, when you take out the earbuds from the charging case, they will connect with your device automatically.

### Pair with Other Device

G17 headphones bluetooth has memory function, it usually auto connects with the last paired device.

Thus, if you want to pair them with other device, you should disconnect "G17" from the last paired device, and forget the pairing record on the last device.

Then try to connect it to a new device, it should work properly.

### Mono Mode (Only Left/Right Earbud is being Used)

You can use one earbud alone, leave another earbud in the charging case.

- When in Dual mode, put one earbud into the charging case.
- Or only take one earbud out of the charging case, then search & connect "G17" on your device.



## Factory Restore Setting

### When should I reset?

- When only one side play music.
- When you can't find "G17" on the device.
- When both earbuds fail to pair with each other or occur connection related issues.

### How to reset?

- Delete "G17" record from the Bluetooth menu on your device and deactivate the Bluetooth setting.
- Make sure the charging case has power or being plugged into a power supply.
- Insert both earbuds into the charging case to get charged.
- Quick-click on both earbuds 5 times simultaneously to clean the pairing record with the last paired device.

(\* During this period, both earbuds'LED will flash Red & Blue light 3 times, then turn to Red light to get charge again.)

- Now turn on the Bluetooth setting on your device, search and connect the earbuds, they will work properly.

**Note:** If it still doesn't work, please repeat the steps to try again.

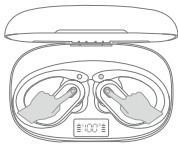

## Multi-Function Operations

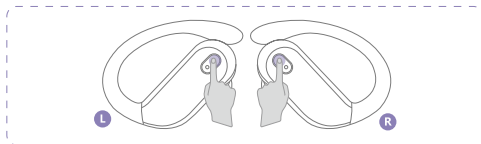

### For Call

Answer Call	Click Once on L/R earbud
End Call	Click Once on L/R earbud
Reject Call	Long Press 2s on L/R earbud

### Voice Assistance

Siri	Quick Triple- Click on L/R earbud
------	-----------------------------------

(\* Must in non-music mode or standby mode)

### Music Mode

Play/Pause	Click Once on L/R earbud
Next Track	Quick Double- Click on R earbud
Last Song	Quick Double- Click on L earbud
Volume+	Long Press & Hold on R earbud
Volume -	Long Press & Hold on L earbud

(\* In single mode, R Earbud only support next song and Volume+, L Earbud only support previous song and Volume-)

**Note:** Prompt sound 'Di' will be produced when the volume reach minimum or maximum level.

## How to sync volume on Android?

To protect users from potential hearing damage, Android's limit on max volume is quite low for Bluetooth audio devices.

If you feel the volume is too low, please access developer options and enable absolute volume, so you'll be able to max the volume at your own volition and to the full capabilities of your Bluetooth earphones.

(Scan this QR code to watch a video to learn more details.)



### Find Build Number Firstly

**Android 4.1 and lower:** the Developer options screen is available by default.

**Android 4.2 and higher:** the Developer options in Android phones are hidden, you must enable this screen through Build Number.

**Android 7.1 and lower:** Settings > About Phone > Build Number

**Android 8.0.0 and Android 8.1.0:** Settings > System > About Phone > Build Number

**Android 9 and higher:** Settings > About Phone > Build Number

### Enable Developer Options

Locate the Build number and tap it about 7 times in succession to enable Developer options.

You may also have to tap in your PIN for verification. Once developer options are activated, you will see a message that reads "You are now a developer".

Go back to the Settings pane, search Developer options as an entry. At the top of the Developer options screen, you can toggle the options as figure 1.

Developer Options

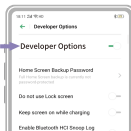

(figure 1)

### Enable Absolute Volume

Scroll down until you reach the Networking section. Once there, enable (toggle ON) the absolute volume options as figure 2.

**Note:** These options in the figure 2 may be different from the device you're using. Typically, the choices depend on the type and model of the device you are working with.

Enable absolute volume

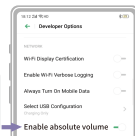

(figure 2)

### FCC Caution

Any changes or modifications not expressly approved by the party responsible for compliance could void the user's authority to operate the equipment.

This device complies with part 15 of the FCC Rules. Operation is subject to the following two conditions:

(1) This device may not cause harmful interference, and (2) this device must accept any interference received, including interference that may cause undesired operation.



www.gnmn.tech service@gnmn.tech

Thank you for purchasing the authentic product. For more newer products, parts and accessories, please visit: [www.gnmn.tech](http://www.gnmn.tech)  
For any assistance please contact Email: [service@gnmn.tech](mailto:service@gnmn.tech)

