

BRAUN

Silk-épil® 7

脱毛器



Type 5377

型号: 5377

www.braun.com

7-561

中文 6

English 13

Braun GmbH
Frankfurter Straße 145
61476 Kronberg/Germany
www.braun.com
www.service.braun.com

96824911/VI-14
China/UK



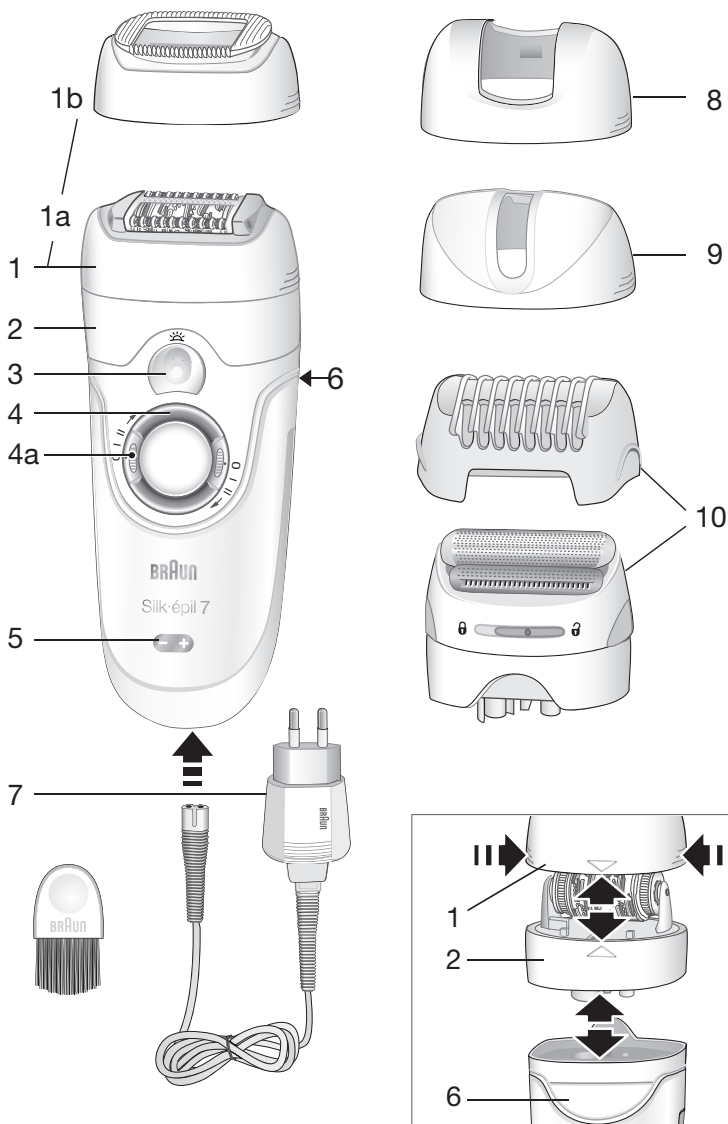

A

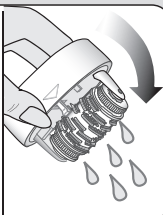
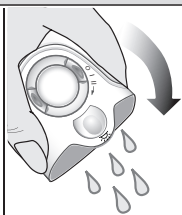
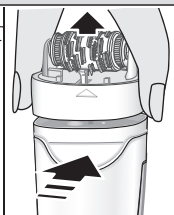
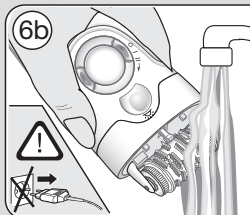
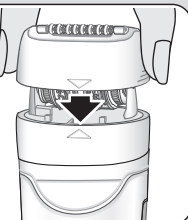
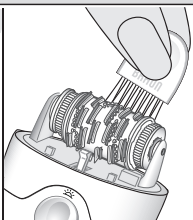
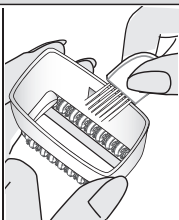
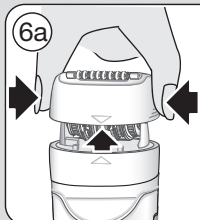
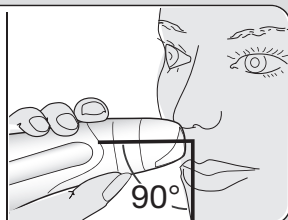
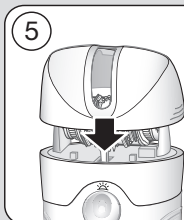
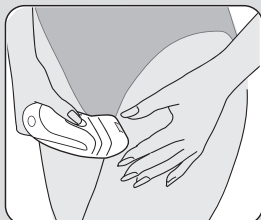
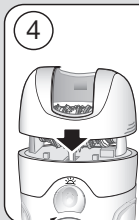
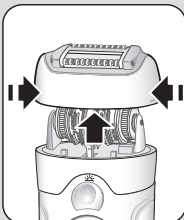
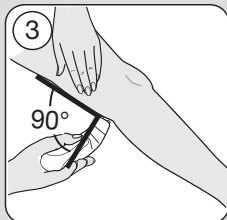
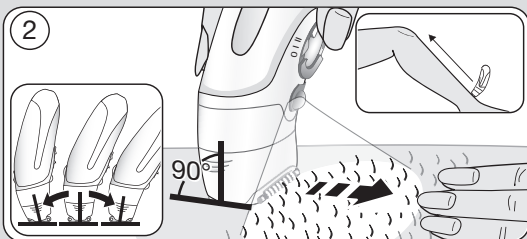
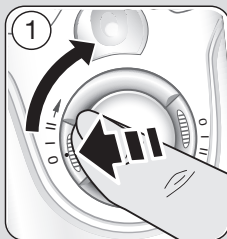

B

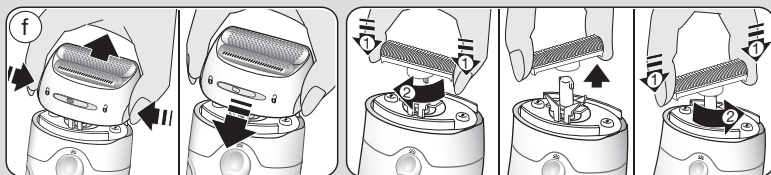
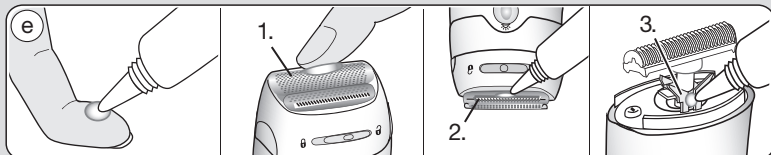
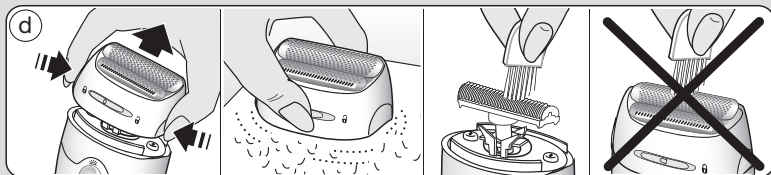
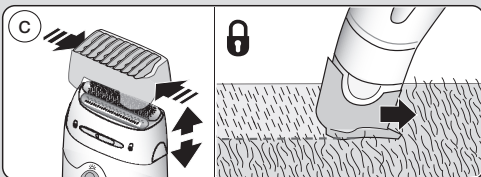
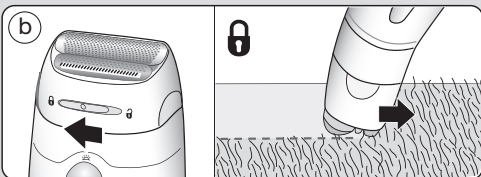
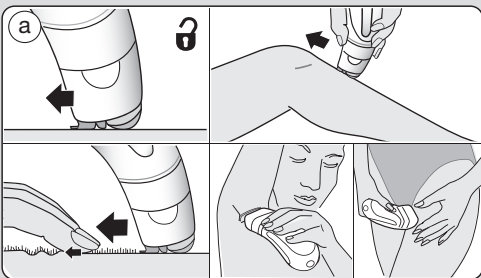
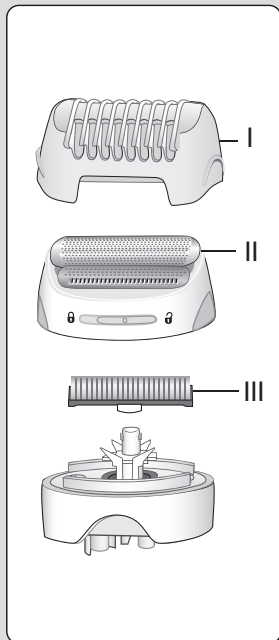

English

Our products are engineered to meet the highest standards of quality, functionality and design. We hope you thoroughly enjoy using your Braun Silk-épil 7.

Please read the use instructions carefully before using the appliance and keep them for future reference.

Braun Silk-épil 7 has been designed to make the removal of unwanted hair as efficient, gentle and easy as possible.

Important

- For hygienic reasons, do not share this appliance with other persons.
- This appliance is provided with a special cord set with an integrated Safety Extra Low Voltage power supply. Do not exchange or manipulate any part of it. Otherwise there is risk of electric shock. For electric specifications, please see printing on the special cord set. The special cord set automatically adapts to any world-wide AC voltage.
-  This appliance is suitable for use in a bathtub or shower. For safety reasons, it can only be operated cordless.
- This appliance can be used by children aged from 8 years and above and persons with reduced physical, sensory or mental capabilities or lack of experience and knowledge if

they have been given supervision or instruction concerning the safe use of the appliance and understand the hazards involved. Children should not play with the appliance.

Cleaning and user maintenance should not be made by children unless they are older than 8 years and supervised.

- When switched on, the appliance must never come in contact with the hair on your head, eyelashes, ribbons, etc. to prevent any danger of injury as well as to prevent blockage or damage to the appliance.

Description

- 1a High frequency massage cap
- 1b Efficiency cap
- 2 Epilation head
- 3 Smartlight
- 4 Switch with lock keys (4a)
- 5 Charging light
- 6 Release button
- 7 Special cord set
- 8 Sensitive area cap
- 9 Facial cap
- 10 Shaver head with trimmer cap

Charging

- Before use, charge the appliance. For best performance, we recommend that you always use a fully charged appliance. Using the special cord set, connect the appliance to an electrical outlet with the motor switched off. Charging time is approximately 1 hour.
- The charging light (5) flashes green to show that the epilator is being charged. When the battery is fully charged, the charging light shines permanently. Once

fully charged, use the appliance without cord.

- When the charging light flashes red, reconnect the appliance to an electrical outlet via the special cord set to recharge.
- A full charge provides up to 40 minutes of cordless operation time.
- Wet usage might reduce the operation time. We recommend that you recharge the appliance after each use.
- The best temperature range for charging, using and storing the appliance is between 15 °C and 35 °C. In case the temperature is far beyond this range, the charging time might be longer whereas the cordless operation time might be reduced.

Overheating protection

As a safety feature to avoid the unlikely event of the appliance overheating, it may happen that the charging light shines red for 8 seconds and then the appliance turns off automatically. In this case, turn the switch back to the position «0» (off) and let the appliance cool down.

How to operate the appliance

Switch on the appliance by pressing a lock key (4a) and turning the switch (4) clockwise to position «I» or «II».

The Smartlight (3) shines as long as the appliance is switched on. This provides better visibility of fine hairs or skin.

To remove the epilation head, press the release button (6). To change caps, press their lateral ribs and pull off.

A Epilation

Epilation tips

If you have not used an epilator before, or if you have not epilated for a longer period of time, it may take a short time for your skin to adapt to epilation. The discomfort experienced in the beginning will decrease considerably with repeated use as the skin adapts to the process.

When epilating for the first time, it is advisable to epilate in the evening, so that any

possible reddening can disappear overnight. To relax the skin we recommend applying a moisture cream after epilation. Epilation is easier and more comfortable when the hair is at the optimum length of 2–5 mm. If hairs are longer, we recommend that you shave first and epilate the shorter, re-growing hairs after 1 or 2 weeks. Alternatively, you can trim the hairs to 5 mm length.

Fine, regrowing hairs might not grow up to the skin surface. The regular use of massage sponges (e.g. after showering) or exfoliation peelings helps to prevent in-grown hair as the gentle scrubbing action removes the upper skin layer and fine hair can get through to the skin surface.

Dry usage: Your skin must be dry and free from grease or cream.

Wet usage: The appliance can be used on wet skin, even under running water. Make sure that the skin is very moist in order to achieve optimum gliding conditions for the appliance. After each wet usage, clean the appliance under running water.

How to epilate

Before use, always make sure that the epilation head (2) is clean and provided with a cap (1a or 1b).

- 1 Select speed «I» for a gentle epilation and speed «II» for an efficient epilation.
- 2 Always stretch your skin when epilating. Make sure that the epilation area is in contact with your skin.

Guide the appliance in a slow, continuous movement without pressure against the hair growth, in the direction of the switch. As hair can grow in different directions, it may also be helpful to guide the appliance in different directions to achieve optimum results. The massage cap (1a) ensures best skin comfort during epilation. If you are used to the sensation of epilation, you may replace the massage cap (1a) with the efficiency cap (1b) which provides a

closer skin contact and an improved adaptation to all body areas.

3 Leg epilation

Epilate your legs from the lower leg in an upward direction. When epilating behind the knee, keep the leg stretched out straight.

4 Underarm and bikini line epilation

The sensitive area cap (8) has specifically been designed for use in these areas. Place it onto the epilation head. Especially at the beginning, these areas are particularly pain-sensitive. Therefore, we recommend that you select speed setting «I» for the first few times. With repeated usage the pain sensation will diminish.

Before epilating, thoroughly clean the respective area to remove residues (like deodorant). When epilating the underarm, keep your arm raised up so that the skin is stretched and guide the appliance in different directions. As skin may be more sensitive directly after epilation, avoid using irritating substances such as deodorants with alcohol.

5 Facial epilation

For removing any unwanted hair from the face, use the facial cap (9) as an optional attachment to be placed on the epilation head (2).

For the first few usages, we recommend that you select speed setting «I» in order to get used to the epilation sensation in those sensitive areas.

Prior to epilation, we recommend cleaning the skin with alcohol to promote good hygiene. When epilating the face, stretch the skin with one hand and slowly guide the epilator with your other hand the direction of the switch.

6 Cleaning the epilation head

Regular cleaning ensures better performance.

a Brush cleaning:

Remove the cap and brush it out.

Thoroughly clean the epilator head from the rear side with the brush dipped into alcohol. While doing so, turn the tweezer element manually. This cleaning method ensures best hygienic conditions for the epilation head.

b Cleaning under running water:

After each wet usage, clean the appliance under running water. Remove the cap. Hold the appliance with the epilation head under hot running water. Then press the release button (6) to remove the epilation head. Thoroughly shake both, the epilation head and the appliance to make sure that remaining water can drip out. Leave both parts to dry. Before reattaching, make sure that they are completely dry.

General information on epilation

All methods of hair removal from the root can lead to in-grown hair and irritation (e.g. itching, discomfort and reddening of the skin) depending on the condition of the skin and hair. This is a normal reaction and should quickly disappear, but may be stronger when you are removing hair from the root for the first few times or if you have sensitive skin.

If, after 36 hours, the skin still shows irritation, we recommend that you contact your physician.

In general, the skin reaction and the sensation of pain tend to diminish considerably with the repeated use of Silk-épil. In some cases, inflammation of the skin could occur when bacteria penetrate the skin (e.g. when sliding the appliance over the skin). Thorough cleaning of the epilation head before each use will minimize the risk of infection. If you have any doubts about using this appliance, please consult your physician. In the following cases, this appliance should only be used after prior consultation with a physician: eczema, wounds, inflamed skin reactions such as folliculitis (purulent hair follicles) and, varicose veins, around moles, reduced immunity of the skin, e.g. diabetes mellitus, during pregnancy, Raynaud's

disease, haemophilia, candida or immune deficiency.

B How to use the shaver head

The shaver head (10) is designed for a fast and close shave of legs, underarms and bikini line, contour trimming and cutting hair to 5 mm length. With the shaver head attached, use the appliance only on dry skin and with speed setting «II».

- a Shaving: select «**II**».
- b Contour trimming: select «**I**».
- c Trimming hair to 5 mm length: select «**I**» and put on the trimmer cap (I).
- d Cleaning: Do not clean the shaver foil (II) with the brush as this may damage the foil.
- e The shaving parts need to be lubricated regularly every 3 months.
- f Replace the foil frame (II) and cutter block (III) when you notice a reduced shaving performance. Replacements parts can be obtained from your retailer or Braun Customer Service Centres or via www.service.braun.com. Do not shave with a damaged foil.

Disposal

This product contains batteries and recyclable electronic waste. To protect the environment, do not dispose of it in the household waste, but take it to appropriate local collection points.



Subject to change without notice.