

sunseeker

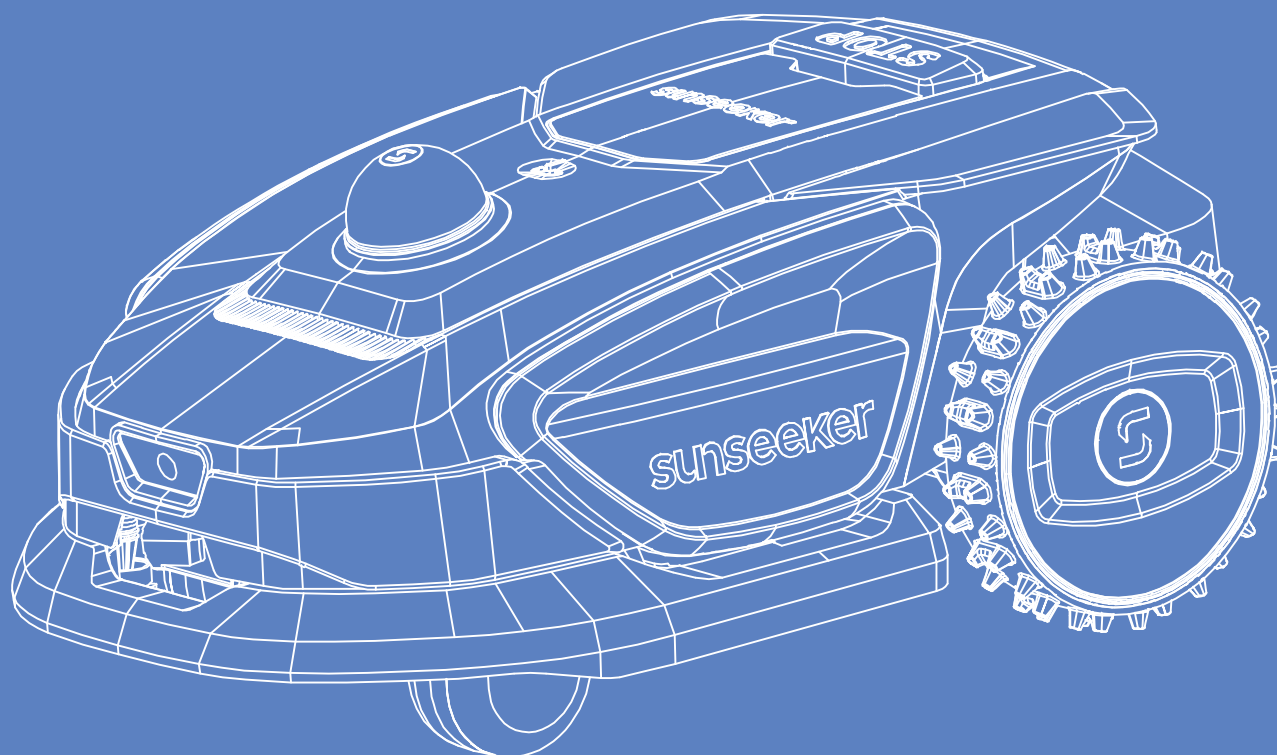

sunseeker S4

Instruction Manual

Original Instructions

Read the operator's manual carefully and make sure that you understand the instructions before you use the product.



EN

EN	2
DE	30
FR	59
IT	88
NL	116
DK	145
SE	173
NO	203
FI	231
PL	259
CZ	287
HU	315
ES	343
SI	371
RO	399
EE	427
LV	455
LT	483
BG	512
SK	544

Table of Contents



1. Safety and Regulations4

1.1 General4

1.2 General Safety Instructions4

1.3 Safety Instructions for Installation5

1.4 Safety Instructions for Daily Operation.....6

1.5 Safety Instructions for Maintenance6

1.6 Battery Safety6

2. Symbols and Decals 6

3. Contents and Specification7

3.1 Box Contents7

3.2 Parts and Functions8

3.3 Specifications9

4. Installation and Mapping 10

4.1 Preparations.....11

4.2 Install the Charging Station.....11

4.3 Activate the Mower12

4.4 App Connection.....12

4.5 Mapping.....13

5. Daily Operation..... 17

5.1 Display and Control on the Mower 17

5.2 Change the PIN code 17

5.3 Schedule Setting..... 18

5.4 APP Introduction.....19

5.5 IoT20

5.6 Obstacle Avoidance.....20

6. Maintenance..... 21

6.1 Cleaning21

6.2 Replace Blades22

6.3 Transportation23

6.4 Battery23

6.5 Power Supply.....24

6.6 Storage.....24

6.7 Recycling and End-of-life Disposal.....25

7. FAQ and Troubleshooting 25

7.1 Error message25

7.2 Trouble shooting26

8. Important Information 27

8.1 Data Privacy.....27

8.2 Limited Warranty27

8.3 Disclaimers28

8.4 Contact Us.....28



1. Safety and Regulations

1.1 General

IMPORTANT
READ CAREFULLY BEFORE USE
KEEP FOR FUTURE REFERENCE

Intended Use

This garden product is only intended for lawn mowing, automatically cutting garden grass at any time of the day. Any usage beyond the intended purpose may pose hazards, potentially causing harm to individuals or damage to property. It is imperative to adhere strictly to the specified guidelines to ensure safety and prevent accidents.

Not Intended Use

This garden product is not intended for use by children under the age of 14 or persons with reduced physical, sensory or mental capabilities, or lack of experience and knowledge, unless they have been given supervision or instruction concerning the use of the product by a person responsible for their safety.

Improper use encompasses, but is not limited to, transporting people, children, or animals on the machine; being transported by the machine; using the machine to pull or push loads; and employing the machine for cutting non-grass vegetation.

Residual risks- Wear protective gloves and eye goggles when conducting maintenance or replacing the blades in case of injuries.

Do not extend the cable between the power supply unit and charging station.



WARNING

- Do not touch hazardous moving parts before they have come to a complete stop.
- Keep the power cable, power supply unit, extension cable and all other electric cables which do not belong to the product outside the cutting area to maintain their distance from hazardous moving parts and prevent damage to cables which may come into contact with live parts. There is a risk of injury of death for operator or bystanders if the instructions in the manual are not obeyed.
- Automatic lawn mower! Keep away from the machine! Children must be supervised!
- Save all warnings and instructions for future reference.
- Read all safety warnings, instructions, illustrations and specifications provided with this product. Failure to follow all instructions listed below may result in electric shock, fire and/or serious injury.
- a warning to never allow children, persons with reduced physical, sensory or mental capabilities or lack of experience and knowledge or people unfamiliar with these instructions to use the machine, local regulations may restrict the age of the operator.

- a warning, not to allow children to be in the vicinity or play with the machine when it is operating.

1.2 General Safety Instructions

Work area safety

- A.** Do not operate machines in explosive atmospheres, such as in the presence of flammable liquids, gases or dust. Machines create sparks which may ignite the dust or fumes.
- B.** Read the instructions carefully. Be familiar with the controls and the proper use of the machine.
- C.** Never allow people unfamiliar with these instructions or children to use the machine. Local regulations may restrict the age of the operator.
- D.** The operator or user is responsible for accidents or hazards occurring to other people or their property.

Electrical safety

- A.** Mains plugs must match the outlet. Never modify the plug in any way. Do not use any charger plugs with earthed (grounded) devices. Unmodified plugs and matching outlets will reduce risk of electric shock.
- B.** Avoid body contact with earthed or grounded surfaces, such as pipes, radiators, ranges and refrigerators. There is an increased risk of electric shock if your body is earthed or grounded.
- C.** Do not abuse power cables. Never use the power cable for carrying, pulling or unplugging a device. Keep power cables away from heat, oil, sharp edges or moving parts. Damaged or entangled power cables increase the risk of electric shock.
- D.** If it is unavoidable to operate a mains-powered device in a damp location, use a residual current device (RCD) protected supply. The use of an RCD reduces the risk of electric shock.
- E.** Ensure the correct installation of the automatic perimeter delineation system as instructed.
- F.** Periodically inspect the area where the machine is to be used, and remove all stones, sticks, wires, bones and other obstacles.
- G.** Check the blades, blade bolts and cutter assembly regularly for wear or damage. Replace worn or damaged blades and bolts in sets to preserve balance.
- H.** On multi-spindle machines, take care as rotating one blade can cause other blades to rotate.

Personal safety

- A.** Do not allow persons unfamiliar with the machine or these instructions to operate the machine. Machines are dangerous in the hands of untrained users.
- B.** Stay alert, watch what you are doing and use common sense when operating the machine. Do not use the machine while you are tired or under the influence of drugs, alcohol or medication. A moment of inattention while operating the machine may result in serious personal injury.



C. Remove any adjusting key or wrench before operating the machine. A wrench or a key left attached to a rotating part of the machine may result in personal injury.

D. When controlling the machine manually, keep proper footing and balance at all times. This enables better control of the machine in unexpected situations.

E. Do not let familiarity gained from frequent use of machines allow you to become complacent and ignore machine safety principles. A careless action can cause severe injury within a fraction of a second.

Machine use and care

A. Disconnect the plug from the power source and/or remove the battery pack (if detachable) from the machine or other devices before making any adjustments, changing accessories, or storing. Such preventive safety measures reduce the risk of unintended starting.

B. Maintain machines and accessories. Check for misalignment or binding of moving parts, breakage of parts and any other condition that may affect the machine's operation. If damaged, have the machine repaired before use. Many accidents are caused by poorly maintained machines and accessories.

C. Use the machine and accessories in accordance with these instructions, taking into account the working conditions and the work to be performed. Use of the machine for operations different from those intended could result in a hazardous situation.

D. Never operate the machine with defective guards, or without safety devices.

E. Do not put hands or feet near or under rotating parts. Keep clear of the discharge opening at all times.

F. Never pick up or carry an machine while the motor is running.

G. Activate device lock/Set into "LOCK" to the machine
- before clearing a blockage;
- before checking, cleaning or working on the machine.

H. Do not leave the machine to operate unattended if you know that there are pets, children or people in the vicinity.

Service

A. Have your machine serviced by a qualified repair person using only identical replacement parts. This will ensure that the safety of the machine is maintained.

B. Keep all nuts, bolts, and screws tight to ensure the machine is in safe working condition.

C. Replace worn or damaged parts for safety.

D. Ensure that correct blades are replaced.

E. Ensure that batteries are charged using the correct charger recommended by the manufacturer. Incorrect use may result in electric shock, overheating or leakage of corrosive liquid from the battery.

F. In the event of leakage of electrolyte flush with water/neutralizing agent, seek medical help if it comes into contact with the eyes, etc.

G. Servicing of the machine should be according to manufacturers' instructions.

BATTERY tool use and care

A. Recharge only with the charger specified by the manufacturer. A charger that is suitable for one type of BATTERY pack may create a risk of fire when used with another BATTERY pack.

B. Only use power tools with specifically designated BATTERY packs. Use of any other BATTERY packs may create a risk of injury and fire.

C. When BATTERY pack is not in use, keep it away from other metal objects, like paper clips, coins, keys, nails, screws or other small metal objects, that can make a connection from one terminal to another. Shorting the BATTERY terminals together may cause burns or a fire.

D. Under abusive conditions, liquid may be ejected from the BATTERY; avoid contact. If contact accidentally occurs, flush with water. If liquid contacts eyes, additionally seek medical help. Liquid ejected from the BATTERY may cause irritation or burns.

E. Do not use a BATTERY pack or tool that is damaged or modified. Damaged or modified batteries may exhibit unpredictable behaviour resulting in fire, EXPLOSION or risk of injury.

F. Do not expose a BATTERY pack or tool to fire or excessive temperature. Exposure to fire or temperature above 130 °C may cause explosion.

G. Follow all charging instructions and do not charge the BATTERY pack or tool outside the temperature range specified in the instructions. Charging improperly or at temperatures outside the specified range may damage the BATTERY and increase the risk of fire.

1.3 Safety Instructions for Installation

A. Do not install the charging station, including any accessory, at a location that is below, or within 24 inch. from, any combustible material. In case of malfunction, heating of the charging station and the power supply may occur and create a potential risk of fire.

B. Do not put the power supply at a height where there is a risk it can be put in water. Do not put the power supply on the ground.

C. Do not encapsulate the power supply. Condensed water can harm the power supply and increase the risk of electrical shock.

D. Applicable to USA/Canada. If power supply is installed outdoors: Risk of Electric Shock. Install only to a covered Class A GFCI receptacle (RCD) with a weatherproof enclosure and access to insert or remove the attachment plug cover.



E. Do not install the charging station where there is a risk of standing water.

1.4 Safety Instructions for Daily Operation

- A. Keep your hands and feet away from the rotating blades. Do not put your hands or feet near or below the product when it is set to ON.
- B. Stop the product or set the product to OFF when persons, especially children or animals are in the work area.
- C. Make sure that there are no objects such as stones, branches, tools or toys on the lawn. The blades can be damaged if they hit such objects.
- D. Do not lift the product or move it when it is set to ON.
- E. Do not let the product collide with persons or animals. If a person or animal comes in the way of the product, stop the product immediately.
- F. Do not put objects on top of the product or the charging station.
- G. Do not use the product if the STOP button does not work.
- H. Always set the product to OFF when it is not in operation.
- I. Do not use the product and a pop-up sprinkler at the same time. Use the Schedule function at the same time.
- J. Do not let the product operate when there is standing water in the work area, such as an area with pools of water formed by heavy rain.

1.5 Safety Instructions for Maintenance

- A. Set the product to OFF when you do maintenance on the product.
- B. Do not use a high-pressure washing machine to clean the product. Do not use solvents to clean the product.
- C. Disconnect the plug from the charging station before you clean or do maintenance on the charging station.

1.6 Battery Safety

Lithium-ion batteries can explode or cause fire if disassembled, short-circuited, or exposed to water, fire, or high temperatures. Handle carefully and do not dismantle or open the battery or use any type of electrical/mechanical abuse. Avoid storage in direct sunlight.

2. Symbols and Decals

Please study the symbols on the product and labels carefully and understand their meaning:

	WARNING: Read the user instructions before operating the product.
	WARNING: Disable the product before working on or lifting the machine. Never touch the rotating blade.
	WARNING: Keep a safe distance from the machine when operating. Keep other persons out of the danger area.
	WARNING: Do not ride on the machine.
	Read the user instructions.
	CE conformity mark.
	Sound power level, determined by European outdoor noise directive.
	Do not dispose this product as normal household waste. Ensure that the product is recycled in accordance with local legal requirements.
	Class III
	DC
	Do not discard the battery into fire and do not expose the battery to a heat source.
	Do not immerse the battery into water.
	Recyclable mark.
	It is not permitted to dispose this battery pack as normal household waste. Ensure that the battery pack is recycled in accordance with local legal requirements.
	Replace with fuse in accordance with rating.
	Class II construction.



BFP	<i>BFP/Backfeed protection.</i>
------------	---------------------------------

IPX4	<i>Degrees of protection provided by enclosures (IP Code)</i>
IPX6	
IP67	
	<i>Detachable power supply part</i>
	<i>CAUTION-Do not touch rotating blade</i>

Symbols on robot screen

	<i>Power on/off</i>
	<i>Start button</i>
	<i>Home button</i>
	<i>OK button</i>
	<i>PIN code setting</i>
	<i>Times setting</i>
	<i>Bluetooth</i>
	<i>Wi-Fi</i>

3. Contents and Specification
3.1 Box Contents

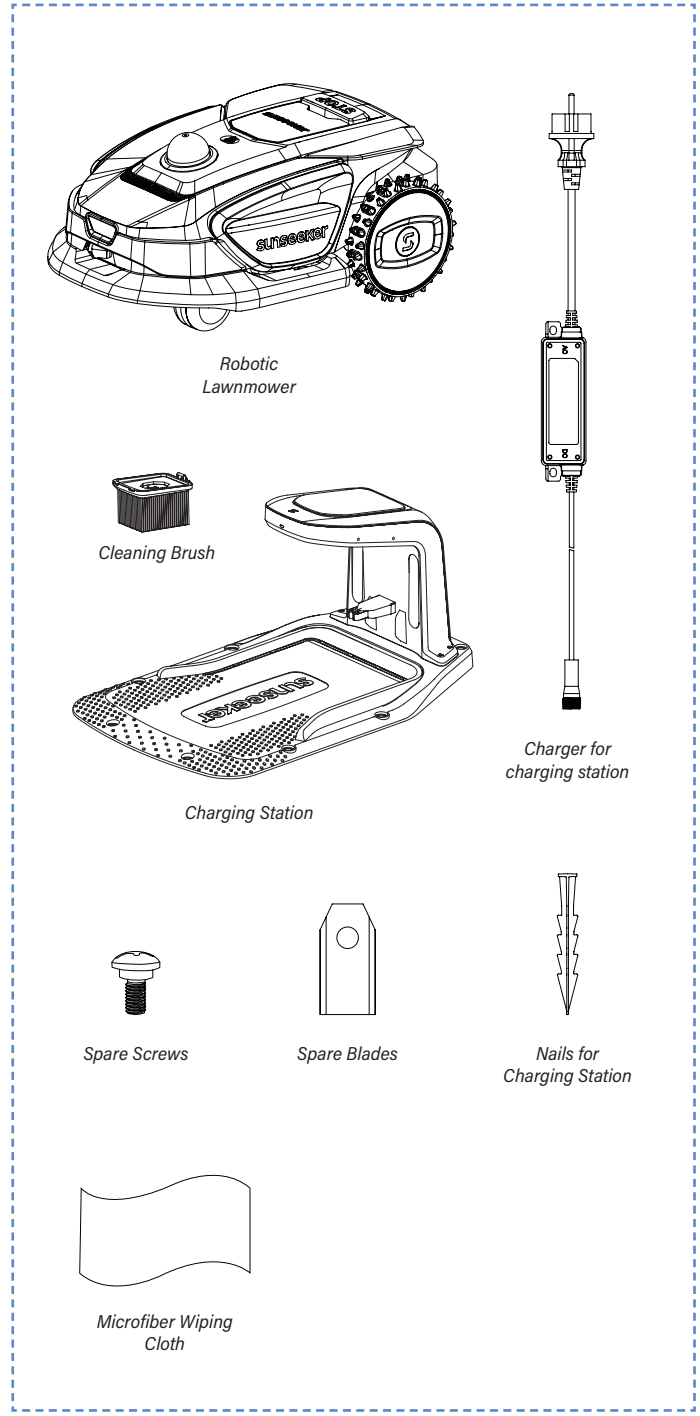



3.2 Parts and Functions

Top View

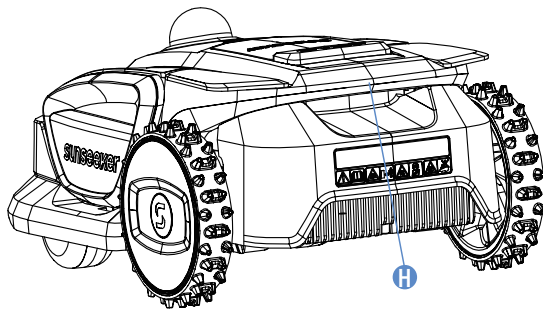
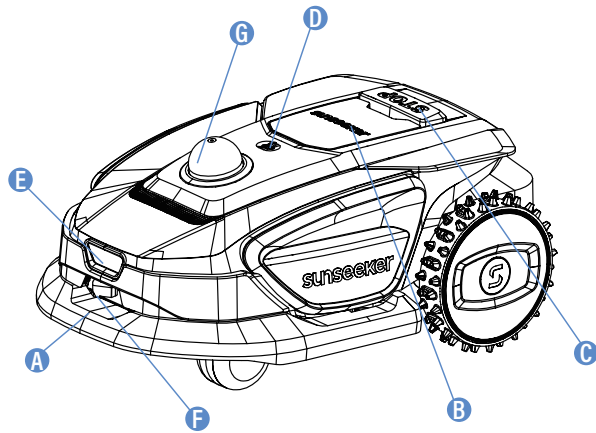

Bottom View

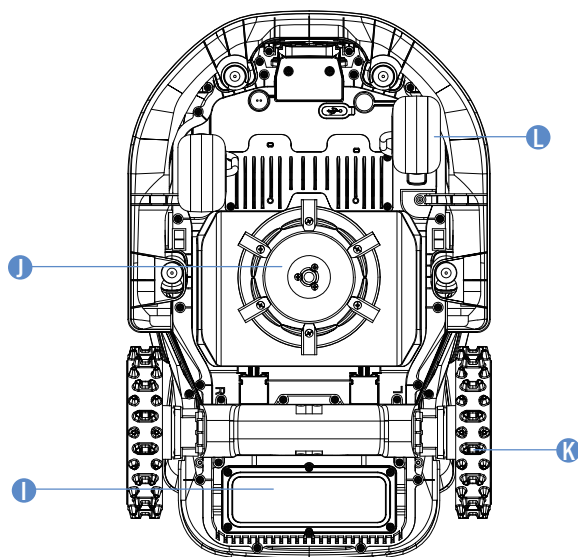

Note

Do not immerse the machine in water, as this may damage the components and void the warranty within the specified period.

A. Collision Bumper

When visual positioning is not available, the collision bumper can ensure the machine's normal operation.

B. Control Panel

The panel to turn the machine's power on and off, to command the machine to work or return; and etc. The panel is located beneath the protective cover. Please close the protective cover after using the control panel.

C. STOP Button

Emergency stop button to stop the machine in case of any urgent situation.

D. Rain Sensor

The rain sensor can detect rain and the machine can return to the charging station automatically to avoid rain according to the user's setting.

E. Monocular Camera

The AI-assisted monocular camera helps the mower detect and avoid obstacles.

F. Charging Electrodes

The charging electrodes on the machine connect to those on the charging station electrodes to charge the machine's battery.

G. LiDAR:

Obstacle Avoidance and Path Planning via Lasers.

H. Handle Bar

Comfort grip handle.

I. Battery Compartment

The compartment for storing the battery.

J. Rotating Cutting Plate

Device for trimming the lawn when the machine is in operation.

K. Drive Wheels

Power output for movement with excellent off-road capabilities.

L. Caster wheel

Rotates to assist with movement and direction.

3.3 Specifications

TECHNICAL SPECIFICATION	S4 (RMR1001M20V)
Boundary wire	Wireless / boundary free
Max mowing area	1000 m ²
Cutting height min/max	20 - 60 mm
Height adjustment	Manual
Cutting width	180 mm
Battery Capacity	4 Ah
Charging Station	Model: CB10A Input: 20V DC, 3.0A Output: 20VDC, 3.0A
User interface	LED Display
Max slope	42% (22°)
Robot dimensions	638 * 422 * 274 mm
Certificates	CE RoHS REACH
Net weight	11 kg
Sound power level LWA	60 dB(A)
Sound Power Uncertainties KWA	3 dB(A)
Sound Pressure Level LpA	52 dB
Sound Pressure Uncertainties KpA	3 dB(A)
FEATURES	
Wifi / Bluetooth	Y
Wire-free mapping	Y
Path planning	3 options
3D Lidar-SLAM	Y
VSLAM	Y
Super Wifi	Y
FOTA	Y
Quick return to charging station	Y
Multi-zones	Up to 100
Working schedule	Schedule setting in APP
Bump sensor	Y
Water wash	Y
GPS and 4G module	Optional
Google assistant & Amazon Alexa	Y
PIN code	Y
Lift & Tilt sensor	Y
Rain sensor	Y
ACCESSORIES	
Spare Blade & Spare Screw	6 pcs
Nails for Charging Station	8 pcs
Charger for Charging Station	3 A (CGF253)
WiFi and Bluetooth - Frequency Band(s)	BT: 2402~2480MHZ WiFi 2.4G: 2412~2472MHZ WiFi 5.2G: 5180~5240MHZ WiFi 5.3G: 5260~5320MHz WiFi 5.6G: 5500~5700MHz WiFi 5.8G: 5745~5825MHZ
WiFi and Bluetooth - Max Output Power	BT BDR+EDR: 8.99 dBm Max. BT BLE: 7.35 dBm Max. WiFi 2.4G:18.98 dBm Max. WiFi 5.2G: 15.68 dBm Max. WiFi 5.3G: 15.26 dBm Max. WiFi 5.6G: 16.04 dBm Max. WiFi 5.8G: 13.07 dBm Max.



4. Installation and Mapping

Sunseeker's advanced hardware and software (intelligent algorithms) significantly enhance the mower's environmental recognition, positioning accuracy, and overall performance. With Sunseeker AllSense (Allsense 3D sensing system) a seamless fusion of 3D Lidar-SLAM and VSLAM visual technology, the robotic lawnmower can perform positioning and navigation tasks in various scenarios, including complex environments, ensuring high-quality lawn maintenance.

3D LiDAR-SLAM and VSLAM technology, which scans the garden environment in real time to generate a 3D map and performs real-time positioning, enables users to set virtual boundaries for their lawnmowers, eliminating the need for traditional boundary wires. With the 3D map and real-time positioning, the lawnmower can plan its mowing paths with high precision and efficiency, achieving optimal mowing coverage.

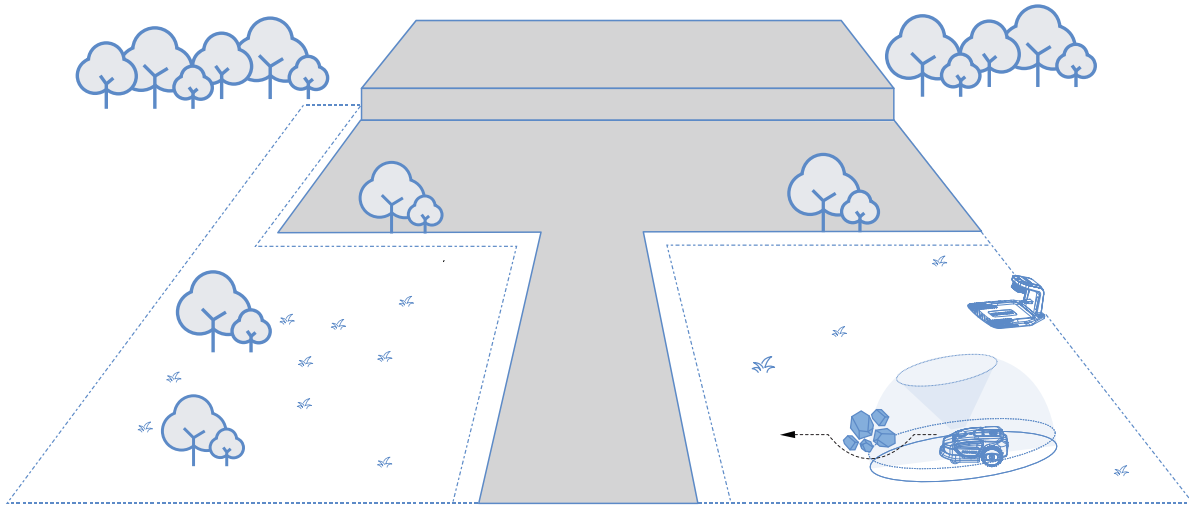



4.1 Preparations

Install Sunseeker APP

Note

When necessary, the App will request access to Bluetooth and Wi-Fi networking, to ensure proper setup and future functionality, grant access to these features.

Scan the QR code to download the Robotic Mower App, or search for "Sunseeker Robot" in the Google Play Store (Android) or the Apple App Store (iOS). After installation, please create a new account and sign in.



iOS



Android

Prepare the mower

Ensure that Bluetooth on your phone is turned on, and scan the machine's SN QR code to identify the model and proceed with the corresponding installation guide.

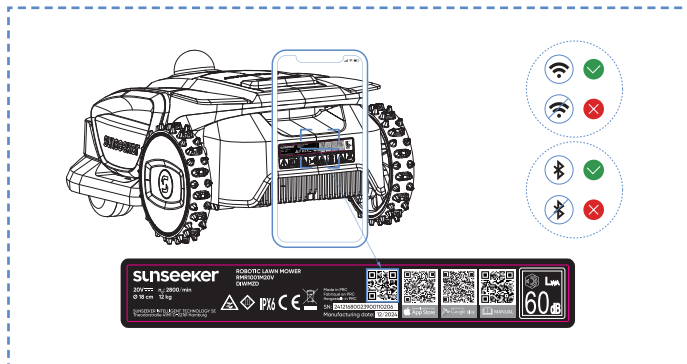

Prepare the lawn

- A.** Clear away any debris, piles of leaves, toys, wires, stones, or other obstacles.
- B.** To ensure safety, please make sure that children and pets are off the lawn.
- C.** Please cut your lawn to a height of no more than 80 mm before using the robotic mower.
- D.** The working area specifications for the robotic lawn mower are as follows: 1000 m² (S4).
- E.** If there are narrow passages within the working area, ensure the passage width is greater than 80 cm.

Recommended lawn types are shown in the pictures below:

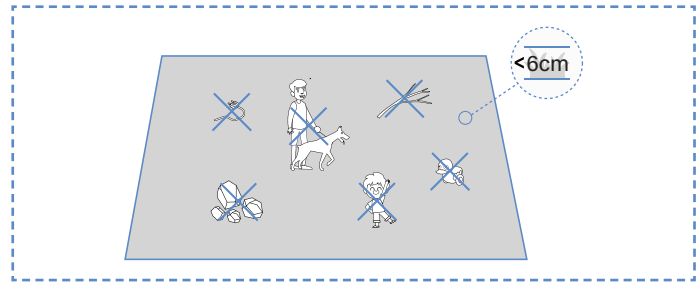

4.2 Install the Charging Station

Find a proper location

- A.** To ensure that the lawn mower can successfully exit and return to the charging station, install the charging station on an open flat non-hardened ground.
- B.** The charging station should be within the coverage area of the household Wi-Fi and close to a power source.
- C.** The charging station can be placed either inside or outside the mower's working area. For safety reasons, it is recommended to keep the charging cable outside the mowing area.
- D.** There should be no obstacles within 1.5 m in front of the charging station.
- E.** If there is grass, it should be lower than 6 cm.

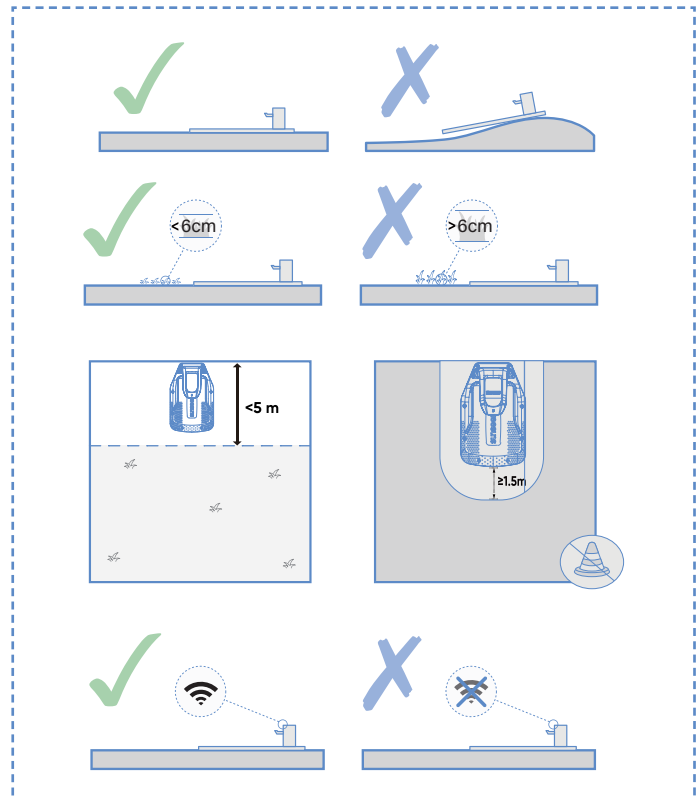

- F.** Ensure that the area above the charging station is as open as possible, free from trees, buildings, or other obstructions.



Install the charging station

A. Use the supplied screws and hex wrench to secure the base plate to the ground.

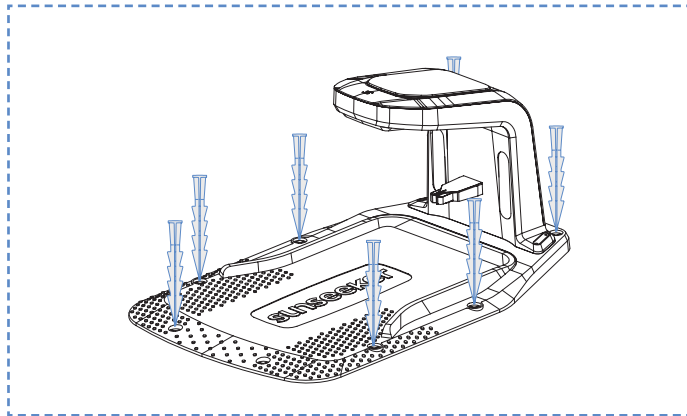

B. Align the cleaning brush with the charging dock slot and insert the charger.

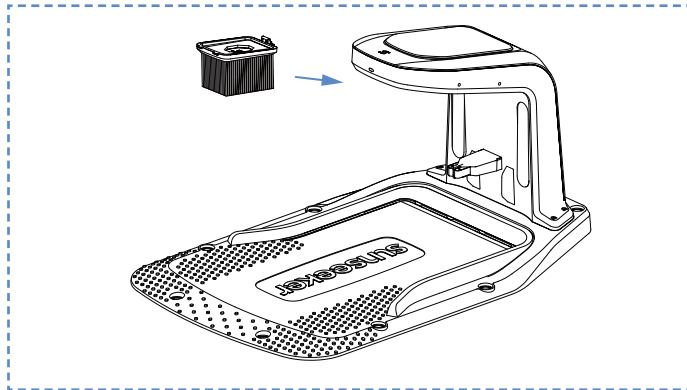

C. Connect the power cord to an extension cord, then plug it into a power outlet. Please keep the power cord at least 30 centimeters above the ground.

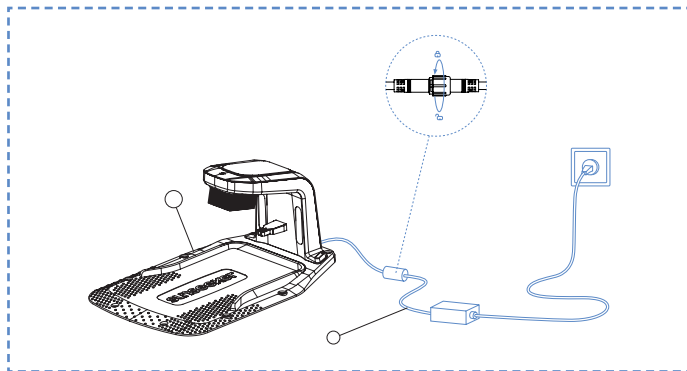

Note

The LED indicator light on the charging dock will remain steadily lit in green when powered on.

D. Remove the LiDAR protective cover, and place the robot into the charging dock to charge. Ensure that the charging contacts of the robot and the charging dock are properly connected.

Note

If additional protection is needed, you can purchase the matching SUNSEEKER charging station, which is available for purchase at both local stores and online platforms. Using a non-SUNSEEKER certified charging station may

cause charging malfunctions.

4.3 Activate the Mower

Preparation

Please make sure that the charging station has been properly installed and connected to the power supply.

Activate the mower

A. Push the mower into the charging station, ensure that the charging electrodes connect properly. The green light on the charging station flashing indicates normal charging. When the mower is fully charged, the indicator light will remain solid green.

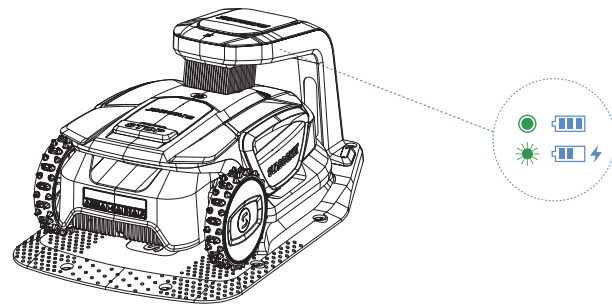

Note

If the indicator light remains off even when there is power supplied properly, please contact customer service.

B. Once the machine charges successfully on the charging station, it will power on automatically. You can also manually power it on by pressing and holding the power button.

C. Enter the default Pin code "0000". Press OK each time you enter "0" to complete the process.

D. If you want to change the password, long press the START and HOME button at the same time to change the password. For more detailed information, please refer to 5.2 Change the PIN Code.

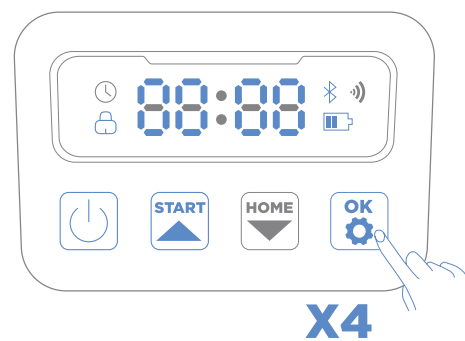

4.4 App Connection

Note

The following illustrations regarding the App are for demonstration purposes only. Options available may vary



depending on software version.

Preparation

- A.** Make sure that the machine is on the charging station, charging properly, powered on, and the PIN code has been entered.
- B.** Ensure that Bluetooth on your phone is turned on. For easier network configuring, we recommend that your phone and the mower remain connected to the same Wi-Fi network.

App Connection

A. Scan the machine's SN QR code to add your robotic lawn mower. If scanning is not available, you can also connect via Bluetooth.

If you have already scanned the QR code during the "Prepare the Mower" step, the mower will automatically bind to the APP when Bluetooth is enabled on your phone, eliminating the need for another scan.

B. After successful pairing, enter the default PIN code "0000". PIN code can be changed on the phone.

C. Configure your Wi-Fi for the machine in the App.

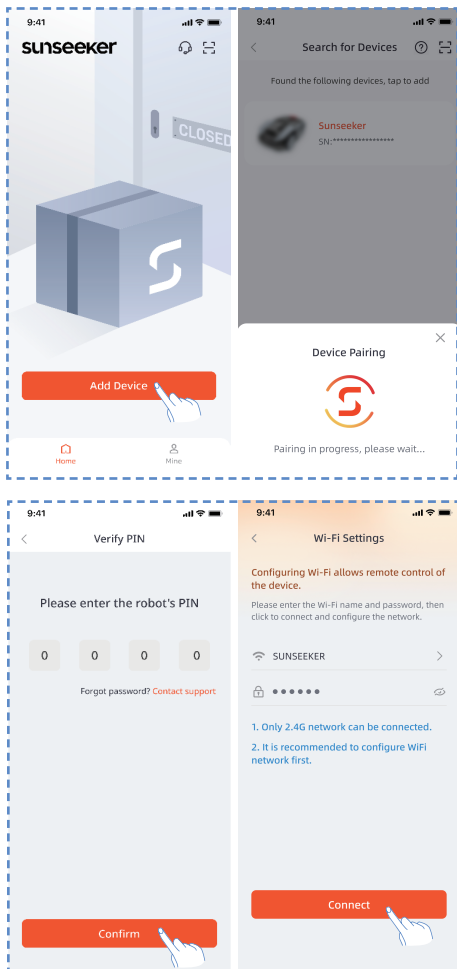

4.5 Mapping

Note

The following illustrations regarding the App are for demonstration purposes only. Options available may vary depending on software version.

Preparation

To have the robot mow the lawn, you first need to scan and map your yard to create a virtual map in its memory.

Check and prepare for mapping:

- A.** The robot has entered the charging dock and is powered on.
- B.** The battery level is above 50%.
- C.** You have connected to the robot via the SUNSEEKER app.
- D.** The LiDAR protective cover is open.
- E.** The robot's front camera is clean and unobstructed.

Be sure to remove the protective film from the front camera before use. If the lens gets dirty during subsequent use, wipe it with a soft cloth.

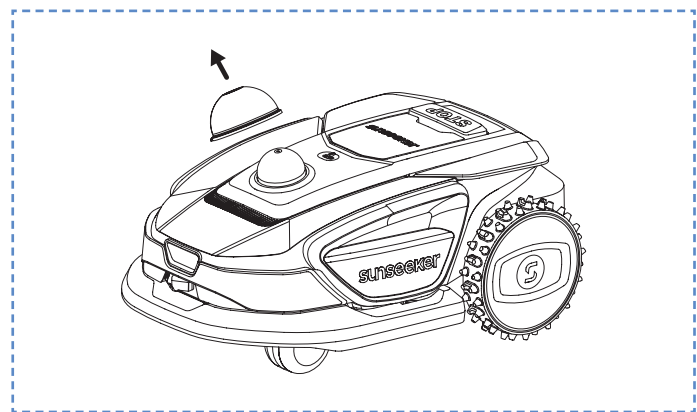

Automatic mapping

The robot adopts advanced 3D LiDAR scanning combined with visual recognition technology, enabling it to independently detect and map your lawn. It will:

- Identify boundaries: Precisely recognize the lawn edges
- Scan the terrain: Cruise along the boundaries to collect environmental details
- Generate a virtual map: Create an accurate digital layout for efficient mowing

Start Automatic Mapping

Before mapping:

- A.** Clear the weed-covered lawn boundaries to ensure they are clearly visible.
- B.** If there are cliffs or step areas along your lawn boundaries, be sure to take control of the robot before it reaches these areas while boundary-searching, and navigate through these sections using manual remote-controlled mapping.
- C.** For lawns without clear boundaries, manual remote control mapping is required to draw the map boundaries.
- D.** The robot cannot pass through narrow spaces or passages less than 0.8 meters wide. Please ensure there is a passage space of more than 0.8 meters inside the

boundaries of the lawn you want to map.

Through the following two methods, you can quickly start mapping.

A. On the robot's operation panel, press START and OK successively.

B. Open the app and tap "Start Mapping" to activate the automatic mapping function.

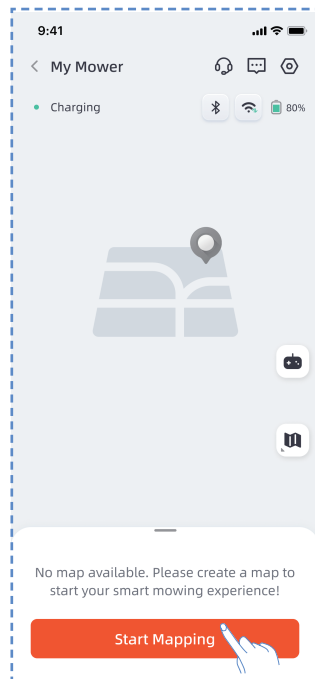

Pause/Resume Automatic Mapping

Under the following scenarios, automatic mapping will be paused:

- A.** The emergency stop button (STOP) on the robot is pressed
- B.** The "Pause" button is tapped on the APP interface.
- C.** Robot anomalies: such as wheels getting stuck, excessive tilting of the body, or body overturning.

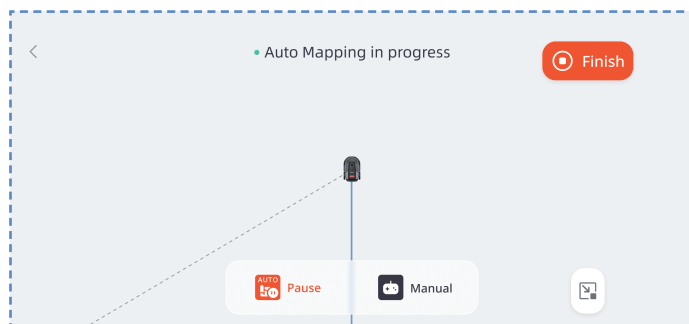

After checking and ensuring the robot is functioning normally without errors, you can resume automatic mapping by tapping the "AUTO" button on the APP interface.

We recommend following the robot during mapping. If the robot fails to detect the boundaries accurately, you can

exit the automatic mapping mode and switch to manual control at any time.

Manual Remote-Controlled Mapping

The robot's ability to automatically recognize boundaries is limited by system performance and the lawn environment. There may be scenarios where the robot cannot successfully complete automatic mapping. In such cases, you need to resort to manual remote-controlled mapping to help the robot finish scanning and mapping the lawn.

Entering Remote-Controlled Mapping Mode

You can enter manual remote control mapping mode from automatic mapping mode in the following ways:

A. During the automatic mapping process, if the robot fails to recognize the lawn boundaries for an extended period, it will automatically switch to manual remote-controlled mapping mode, prompt you to take over, and remotely control the robot to continue mapping.

B. You can also proactively switch to manual remote-controlled mapping mode by tapping the "Remote-Controlled Mapping" button on the automatic mapping interface.

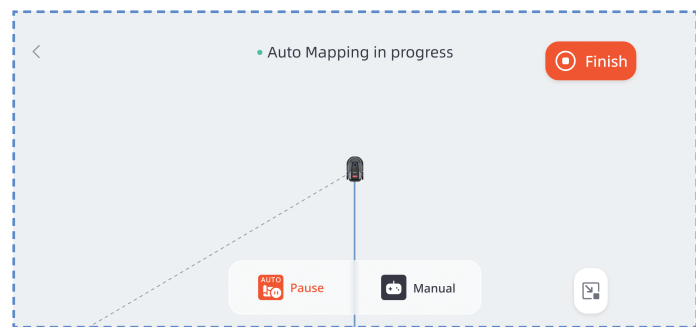

Start Remote-Controlled Mapping

Ensure the robot is near the lawn boundary. Otherwise, first remotely control the robot to get near the lawn boundary, and ensure the boundary is on the robot's right side.

Operate the remote control panel on the APP interface to remotely control the robot to drive along the lawn boundary for mapping.

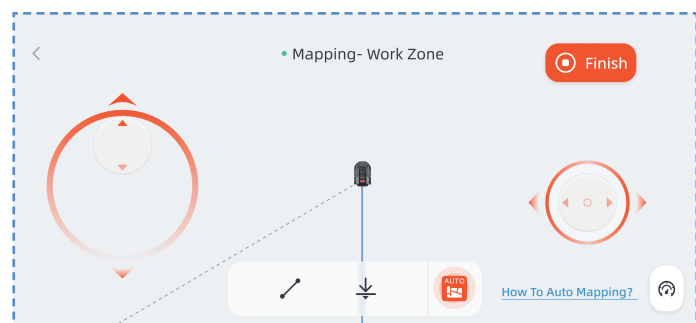

Important Notes:



- A.** Do not manually move the robot when creating the boundary; otherwise, it may result in mapping failure.
- B.** When starting mapping, do not remotely dock the robot to the charging dock before the mapping process is completed. Otherwise, the LiDAR may be blocked, leading to mapping failure.
- C.** When using remote control, stay within 5 meters behind the robot.
- D.** The robot can navigate slopes with a gradient of up to 42% (22°). Please keep the gradient of the working area below this limit.
- E.** If the lawn is more than 4 cm higher than the adjacent ground, keep the robot at least 5 cm away from the edge. If your lawn is flush with the adjacent ground, the robot can cross the boundary line to achieve the best mowing results for the edge areas.
- F.** Ensure the turning angle is greater than 90°; angles less than 90° may cause the robot to have difficulty achieving clean cuts.

Create No-go Zone

If your work area contains a pool or other no-mow zones, it is recommended to create a No-Go Zone to generate a virtual boundary and protect these areas.

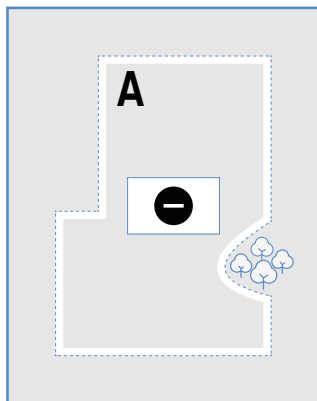

A. Click No-go zone.

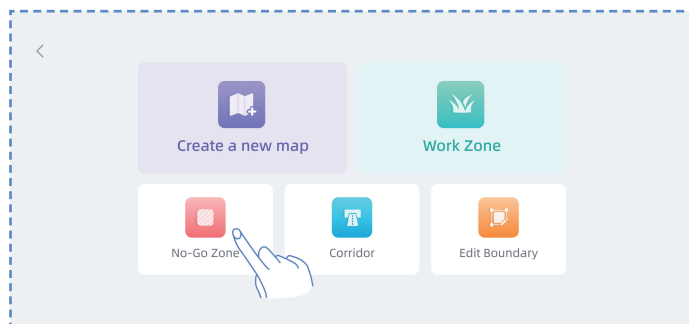

- B.** Remotely control the mower to the starting point where the No-Go Zone needs to be created, then click Start Mapping.
- C.** Remotely control the mower to close the area, then click Finish.



Create multi-zone

If your lawn needs to be divided into multiple work zones, you can create multiple work zones and passages.

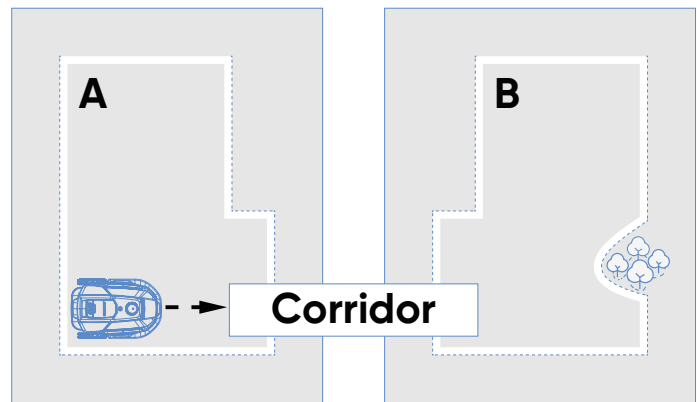

After creating the first work zone, you can add a corridor and then create the second work zone:

- A.** Click Corridor.
- B.** Remotely control the mower to the location where the corridor needs to be created, then click Start Mapping. Make sure the corridor overlaps with the first work zone.
- C.** Remotely control the mower to the end of the corridor, then click Finish.
- D.** Create the second work zone, ensuring that the corridor overlaps with the second work zone.

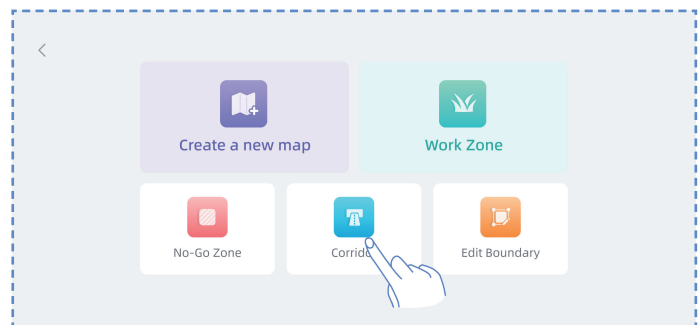

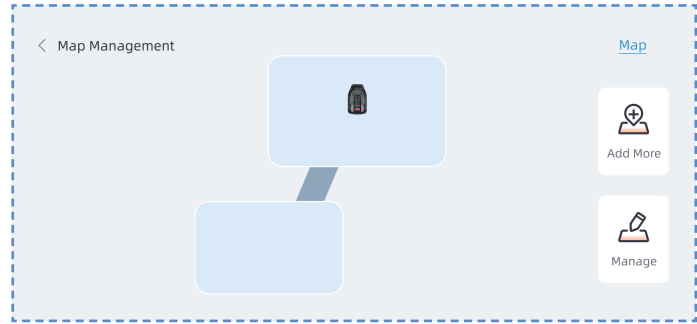
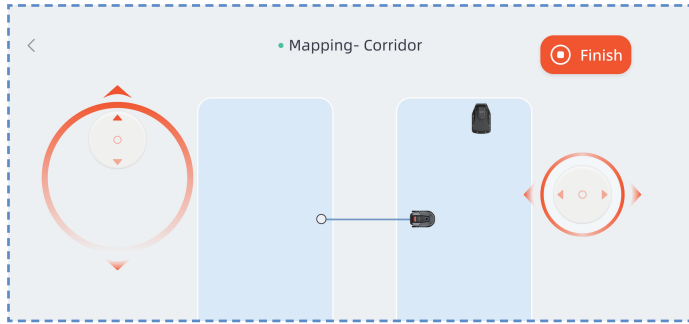

After creating the first work zone, you can add the second work zone and then create the corridor:

- A.** Click Work Zone.
- B.** Remotely control the mower to the location where the second work zone needs to be created and create the second work zone.
- C.** Create a corridor between the two work zones, ensuring that the corridor overlaps with both work zones.

Note

- When creating multiple work zones, it is best not to have the second work zone overlap with the first. If the overlap is too large, the two zones will be automatically merged into one work zone.
- If the corridor does not overlap with the work zone or if no corridor is established between the two work zones, the mower may have difficulty returning to the charging station or completing its tasks.

Manage

You can also merge, split, rename, and delete work zones, and delete corridors or no-go zones. These operations can be performed under Details > Map Management > Management.

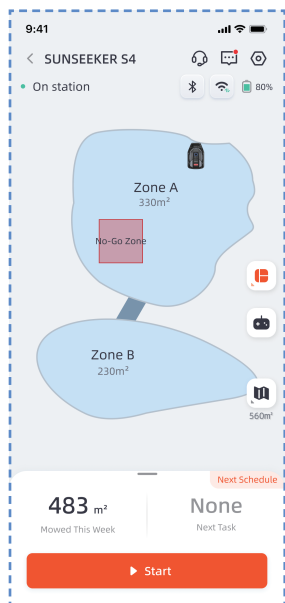

5. Daily Operation

5.1 Display and Control on the Mower Display

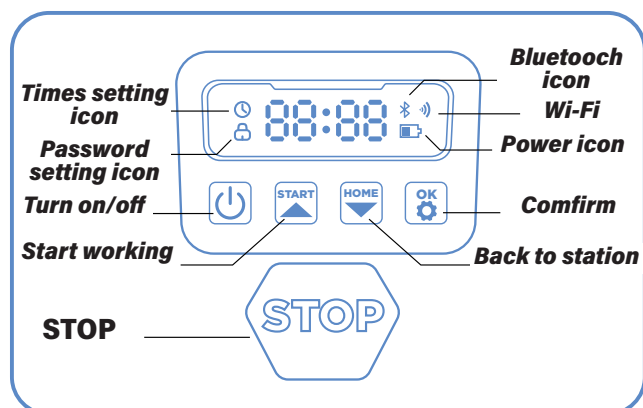

Power icon: The battery power icon shows the remain power of the machine. This icon displaying 1 bar indicates that the power is 30% or under, displaying 2 bars indicates that the remain power is between 31-66%, and displaying 3 bars indicates power of 67% and higher.

Wi-Fi icon: The Wi-Fi icon indicates whether the machine connects successfully to the Wi-Fi or not.

Bluetooth icon: The Bluetooth icon indicates whether the machine is connected to Bluetooth successfully or not.

Time setting icon: The time setting icon indicates that the machine has entered the time setting mode.

Password setting icon: The lock icon lighting up indicates that you need to enter the password or change the machine's password.

Dashboard display: The dashboard display shows the different states and modes the machine is in:

- . **idle:** The machine is in standby mode and there are no tasks in execution at this time.
- . **Running light:** The machine is in working mode. At this time, the disk is rotating at high speed. Please keep away from it.
- . **----**: When the rain delay is turned on, the machine recognizes that it is raining at this moment, ends the current work and returns to the charging station.
- . **stop:** The emergency stop button was pressed on the machine.

Basic Control

Turn on: Press and hold power button for 2 s.

Turn off: Press and hold power button for 3 s.

When the mower is turned off, you will see the word "bye" displayed on the dashboard and then the screen will turn off.

Start working: Press START button and then OK.

Back to station: Press HOME button and then OK.

Stop mower operation: Press STOP.

Exit STOP mode: Press START button and then OK, or press HOME button and then OK.

Time setting: Press and hold START button for 3 s.

Restart the mower: Press and hold the power button for 10s to turn off the machine, then turn it on again or directly push the machine into the charging station and connect it to the charging electrodes on the station.

Note

- If the mower restarts, make sure there is at least 1.5 meters of flat, obstacle-free space in front of it.
- If the work area includes drop hazards such as pools or elevated edges, it is recommended to keep the mower on the charging station during restart, or let it return to the station after restart for position calibration.

5.2 Change the PIN code

If the mower is in lock status, enter the PIN code before manually operating the mower. The default code also be changed via the SunseekerRobot app.

- A.** Long press START and HOME buttons for 3 seconds.
- B.** When PIN1 is displayed, and after "0---" appears, input the old password.
- C.** When PIN2 is displayed, and after "0---" appears, input the new password. Press OK to confirm.

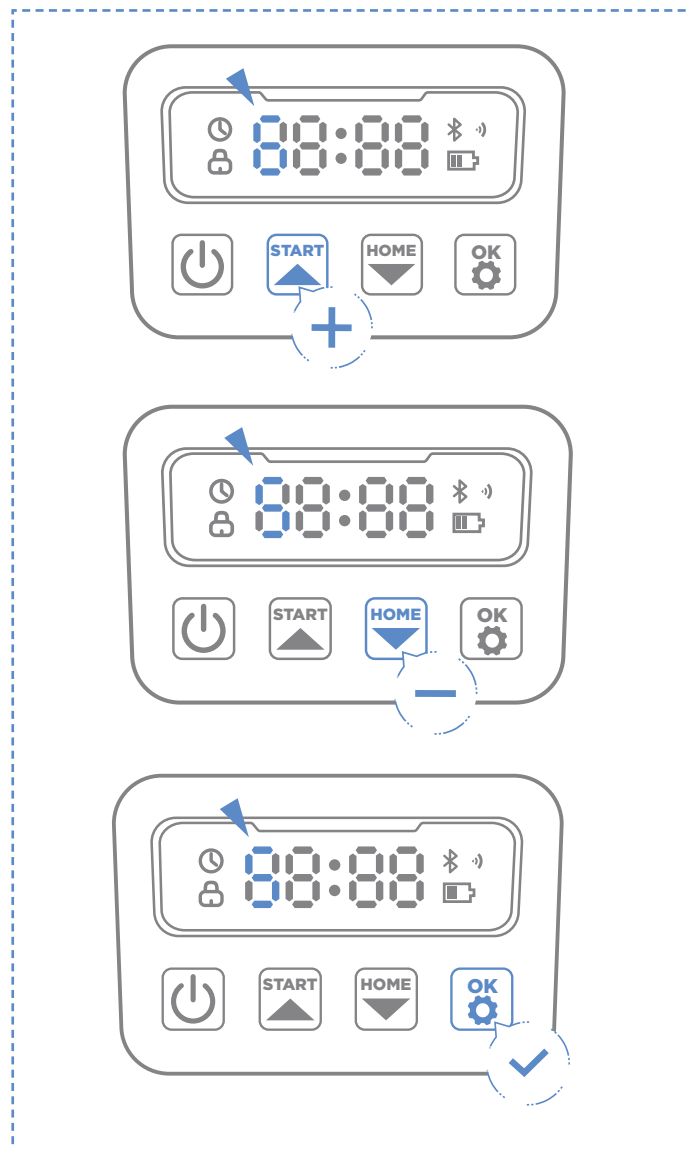

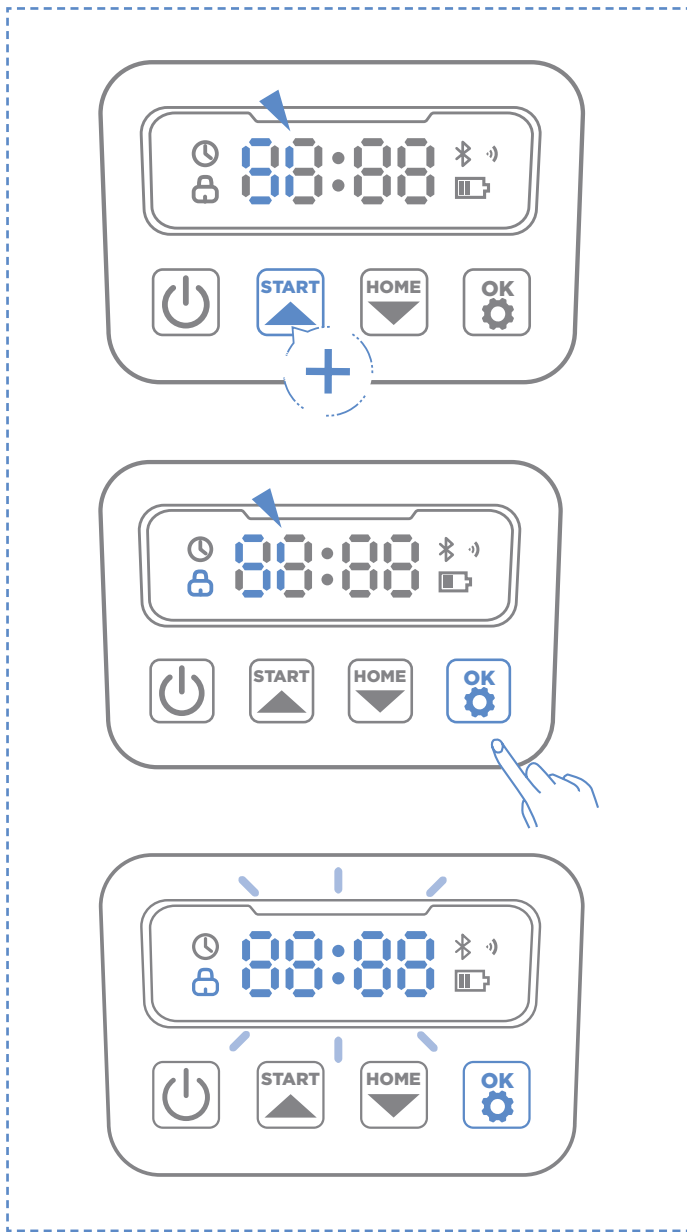

Note

If the pin code is input wrong, the display will show "ERR".

5.3 Schedule Setting

Note

The following illustrations regarding the App are for demonstration purposes only. Options available may vary depending on software version.

Recommended schedule

The mower will intelligently generate a mowing schedule based on the sunrise and sunset times at your location. Recommend Schedule will be enabled by default.

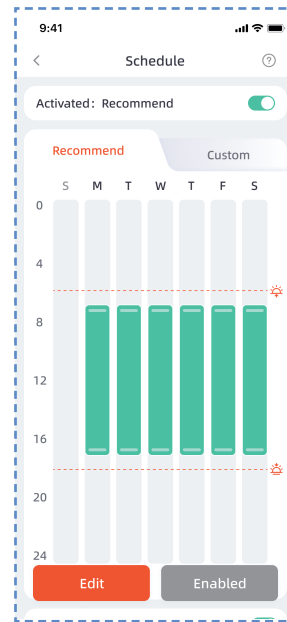

Custom schedule

If you need to modify the recommended schedule, you can also choose to set a custom schedule.

- A. Press Adjust or Custom button to enter custom settings.
- B. Select the day you want the mower to work.
- C. Choose the area where you want the mower to work on that day, or select all areas.
- D. Set the start and end times for the mower's operation.

Note

If the custom schedule time does not fall within the daytime working hours, which are based on the local sunrise and sunset times, the mower will not leave the charging station to mow during schedule times outside of these hours.

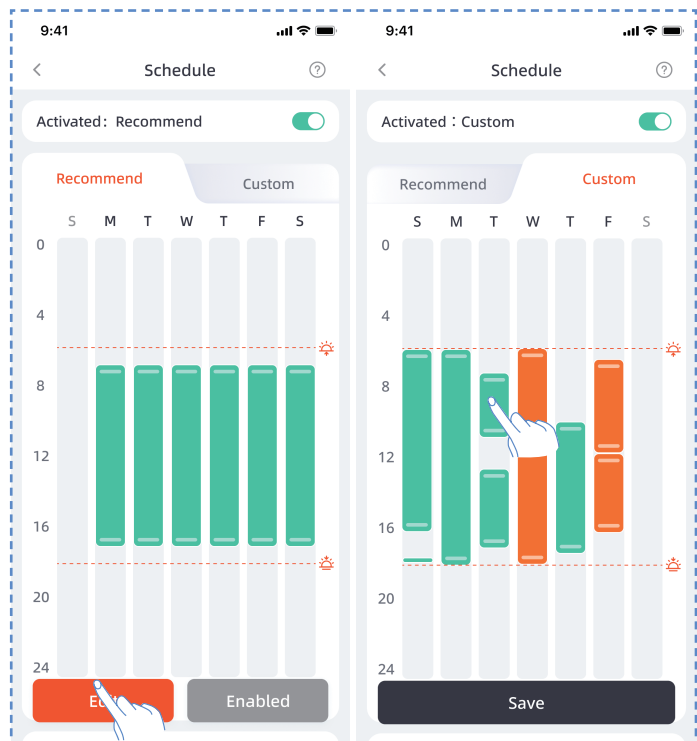

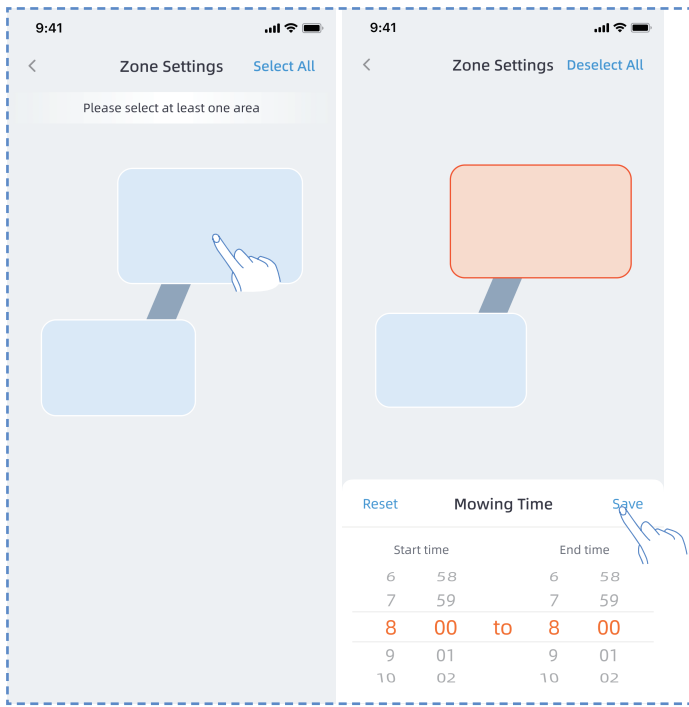

- A. Mower name – Click to rename
- B. Mower status display
- C. Help & Guidance
- D. Add device
- E. Mower Bluetooth connection status
- F. Mower Wi-Fi signal status
- G. Mower battery level
- H. Start mowing
- I. Device details page

5.4 APP Introduction

Note

The following illustrations regarding the App are for demonstration purposes only. Options available may vary depending on software version.

Main page introduction

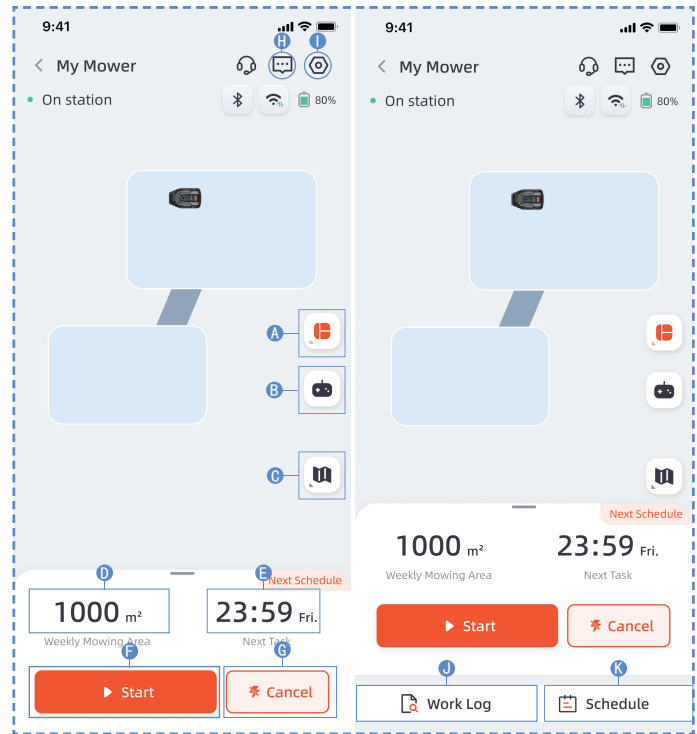
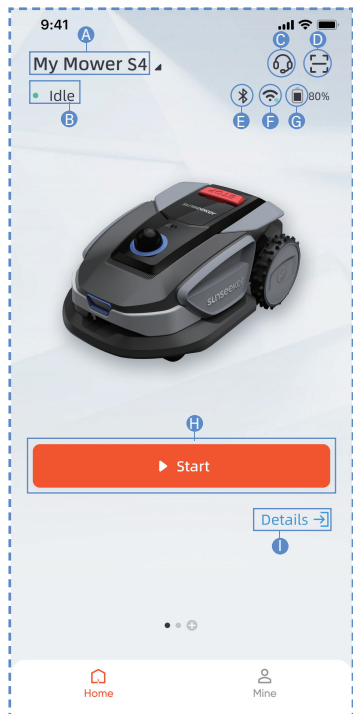

- A. Area selection. Choose between working the entire area or divided zones
- B. Remote control of the mower
- C. Map management / Antenna signal map
- D. Area worked / Estimated work area
- E. Time worked / Next work time
- F. Start mowing
- G. Return to charging station
- H. Message list
- I. Settings
- J. Work log
- K. Schedule settings



Settings

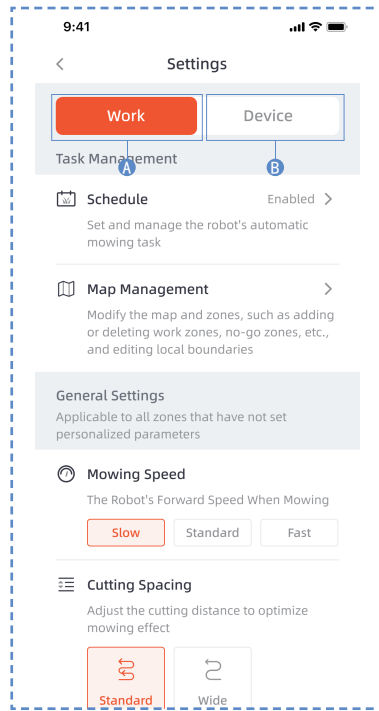

A. Work settings

Here you can adjust the settings related to the mower's operation.

- Schedule
- Map Management
- Cutting Spacing
- Mowing Speed
- Cutting Direction
- Edge Cutting Frequency
- Obstacle Avoidance
- Rain delay
- Energy Saving Mode
- Zone Settings

B. Device settings

You can adjust the device-related settings here.

- Device Info
- PIN Code
- Firmware Update
- Work Log
- Network Settings
- Time Zone
- Feedback

5.5 IoT

The Platform S is an Internet of Things (IoT) device. Connect the mower to the Internet via cellular network or your Wi-Fi network, enabling the following functionalities:

A. Firmware Updates Over-The-Air (OTA), keep your mower updated to the latest features.

B. Enable remote control through the network:

start mowing, stop mowing, return to charging station, set mowing schedule, set cutting height and other functions.

C. Remotely monitor the mowing progress and mower location.

D. Report error codes and the mower status through the network.

Wi-Fi

Platform S uses Wi-Fi to connect to a network. See Wi-Fi Setting for more details.

Note

- Platform S only supports 2.4GHz Wi-Fi network.
- If you are using an iOS device, the mower can only connect to the Wi-Fi that your mobile device is connected to. Please follow the instructions in the app. Connect your mobile device to the Wi-Fi first, then connect the mower to the same Wi-Fi. There are no such requirements for Android devices.

Firmware updates

We will continue to update the mower's firmware. If there is a new version of the firmware, you will receive a pop-up notification in the app. It is recommended that you update as soon as the latest firmware is available.

When updating the firmware, the conditions below need to be met:

- The machine is on the charging station.
- The network is connected.
- The battery power is more than 30%.
- There is no mowing plan in an hour.

In the process of updating, you can see the update progress on your app. After the update is completed, The LED screen on the mower will display the symbol "🔌" to indicate OK.

! WARNING

- DO NOT move the mower during the update process.

5.6 Obstacle Avoidance

Monocular camera

Monocular camera is part of the standard equipment of Platform S. They are designed for visual boundary detection, prior obstacle avoidance and visual recognition of QR codes during the charging process, making the mower more intelligent.

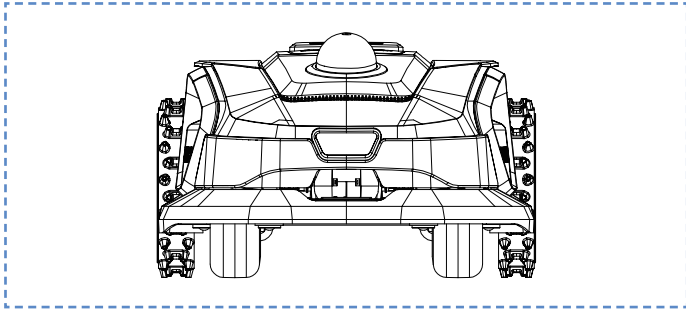

Note

- If there are too many obstacles in your lawn, consider setting up no-go zones around them or removing some of the obstacles to improve the machine's efficiency.

ALLSense (Allsense 3D sensing system)

Equipped with 3D Lidar and monocular camera, Sunseeker's AI and Deep-learning System excels in perceiving the surrounding environment and navigating obstacles seamlessly. Supported by our proprietary deep learning algorithms, it consistently enhances its comprehension of garden landscapes through continuous data accumulation.

Bumper sensor

Sensors are installed inside the Platform S to detect obstacles. When the bumper bumps into an obstacle and triggers the sensor, the mower will go backward and avoid the obstacle.

Note

- Your Platform S is able to avoid objects after bumping into them. However, it is recommended to remove excess clutter before mowing.

6. Maintenance

- A.** Experience superior mowing results and extend the lifespan of your mower with Maintenance.
- B.** Regular inspection and upkeep by an adult every week are essential to ensure the optimal performance of the machine.
- C.** Safeguard your well-being by adhering to safety guidelines: refrain from performing maintenance while wearing open sandals or being barefoot.
- D.** Always prioritize safety by donning long trousers and work shoes during mower servicing.
- E.** Replace any damaged or worn parts promptly to guarantee seamless operation.

ONLY authorized service technicians are permitted to open and reseal the chassis compartment located behind the bumper. The Limited Warranty may be voided if you perform your own servicing.

NOTICE: INSURANCE

You might not be covered for accidents involving this product by your insurance policies. Please get in touch with your insurance provider or agent to find out if coverage is offered.

6.1 Cleaning

- A.** Turn off the mower.
- B.** Utilize a gentle brush or cloth to meticulously clean the exterior, avoiding any corrosive solvents such as alcohol, gasoline, or acetone. These substances have the potential to cause harm to both the aesthetics and internal components of your mower.

Note

- For seamless docking, it is crucial to regularly examine and cleanse the charging station from any debris or mud accumulation.
- Ensure that all connecting parts of the charging station, extension cable, and power supply remain unobstructed for optimal performance.

Chassis and blade disc

- A.** Put on the LiDAR protective cover and turn the mower upside down gently so as not to damage the LiDAR.
- B.** To clean the chassis and blade disc, it is recommended to use a brush or a water hose.
- C.** Do not use a high-pressure washer as it can cause damage.
- D.** Ensure that the blade disc rotates smoothly and the blades have the ability to pivot without any restrictions.

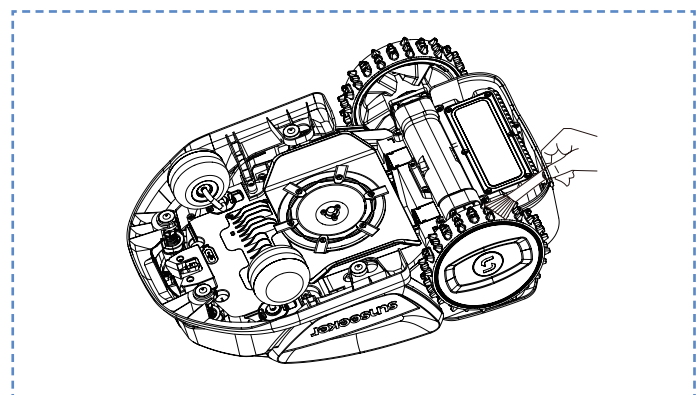
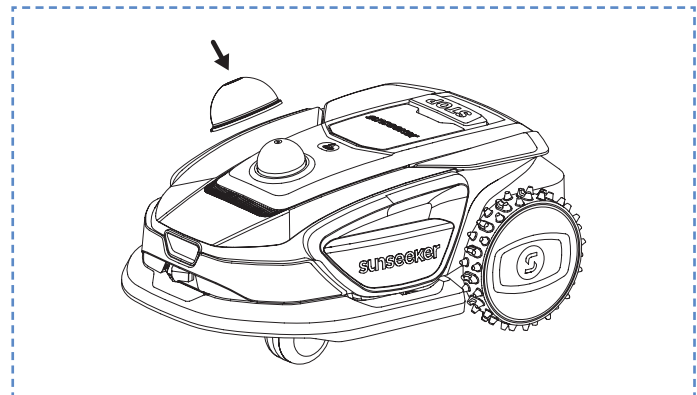

CAUTION

- High pressure water can leak into the sealings and damage electronic and mechanical parts.

Wheels

Grass on the wheels can impair the performance of the mower when climbing slopes. Use the brush to remove mud or other objects in between to ensure a good grip.

Rain sensor

- Check the rain sensor once a month and make sure that it is not covered by mud, grass or other objects.
- Wash mud, grass or other objects off or use a soft brush to clean it.
- Dry the sensor area after cleaning to prevent it from being triggered as it would be by rain.

Camera

Clean the camera regularly to keep it in good condition. Use a clean, soft cotton cloth to avoid scratching the lens.

WARNING

- Make sure that the mower is powered off before cleaning.
- When the mower is upside down, turn it off.

6.2 Replace Blades

For improved mowing performance and safety, it is recommended to change the mower's screws and blades every 1-2 months if it is used frequently. For a safe cutting system, replace all blades along with their screws at the same time. Refer to section "Specification - accessories" for parts can be used.

WARNING

- When inspecting or servicing the blade, wear thick gloves.
- DO NOT reuse the screws. Serious injury may result from doing this.
- We strongly advise using the correct screws and original blades that have been sold by us. (NO.80203054).

How to replace the blades

- Turn off the mower.
- Set the mower upside-down on a spotless, soft surface to prevent scratches.
- Use a cross-tip screwdriver to loosen the screws.
- Remove the screws and blades.
- Fasten the new blades and screws (Torque: 1.0+0.2 N.m).

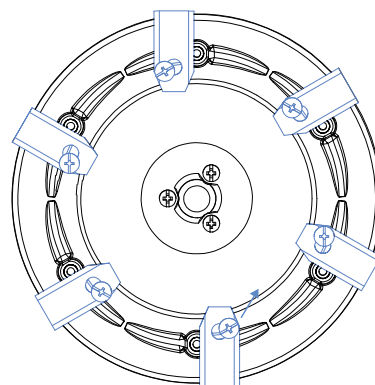
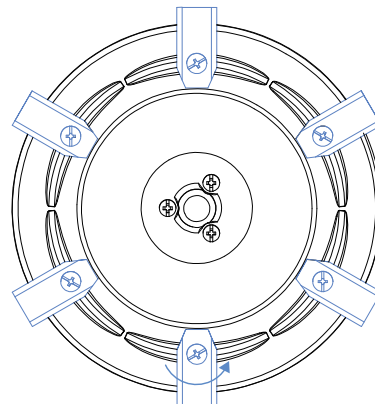
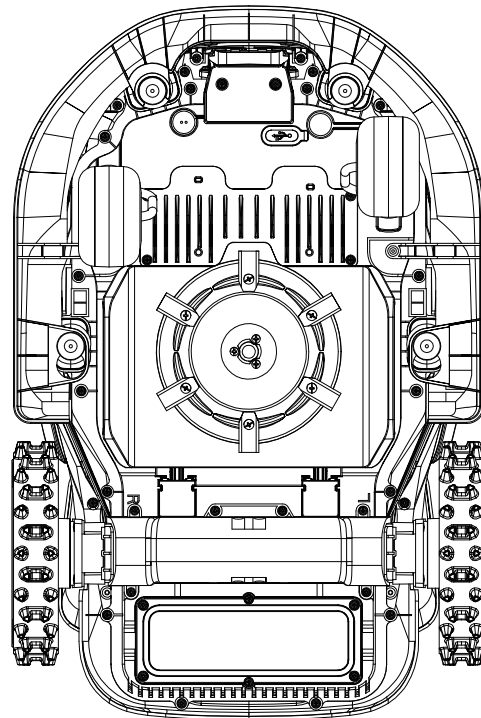



Make sure that the blades can pivot freely.

Note

- Replace the screws with a standard torque of 1.0+0.2 N.m. Incorrect torque may lead to avoidable issues.
- Ensure that the mower is turned off and check the blades for proper application. Check for abnormal noise or shaking.

6.3 Transportation

Make sure that the safety of the mower during long-distance transportation by utilizing the original packaging. Before lifting, moving, or transporting the product, make sure to power it off. Handle with care and avoid violent force, such as throwing and heavy pressure. Never pick up or carry the mower while the motor is running.

How to move or lift properly

Carry the mower by the handle. Keep the blade disc facing away from your body.

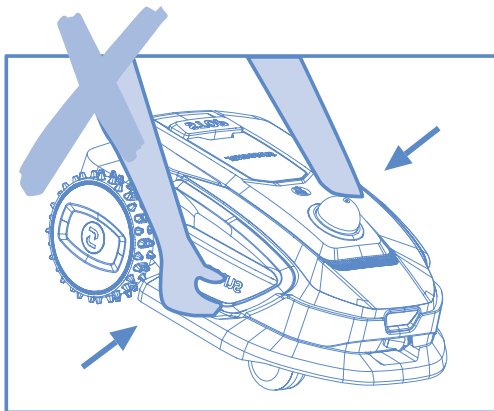
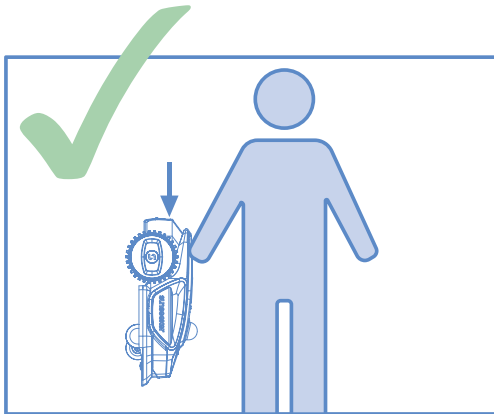

6.4 Battery

- A.** Before storing, fully charge the battery to prevent over-discharge and harm to the electrical parts.
- B.** The Limited Warranty will not protect against over-discharge battery damage.
- C.** DO NOT charge the battery pack in air temperatures below 5 °C, or above 40 °C.

D. If the battery pack is charged when the air temperature is between 18 °C and 25 °C, it can extend its life and improve its performance.

E. Battery pack performs best when it is operated at normal room temperature (20 °C±5 °C).

Note

- The battery life depends on how often the product is used and the total working hours. When the operation time is significantly shorter than usual per full charge or the lawn is not well-cut, it is recommended to replace the battery.

How to replace the battery

- A.** Turn off the mower.
- B.** Place the lawnmower upside-down on a spotless, soft surface.
- C.** Loosen the 4 screws holding the battery compartment in place with a cross-tip screwdriver.
- D.** Disconnect the plug.
- E.** Take out the battery pack and replace it with the new one.

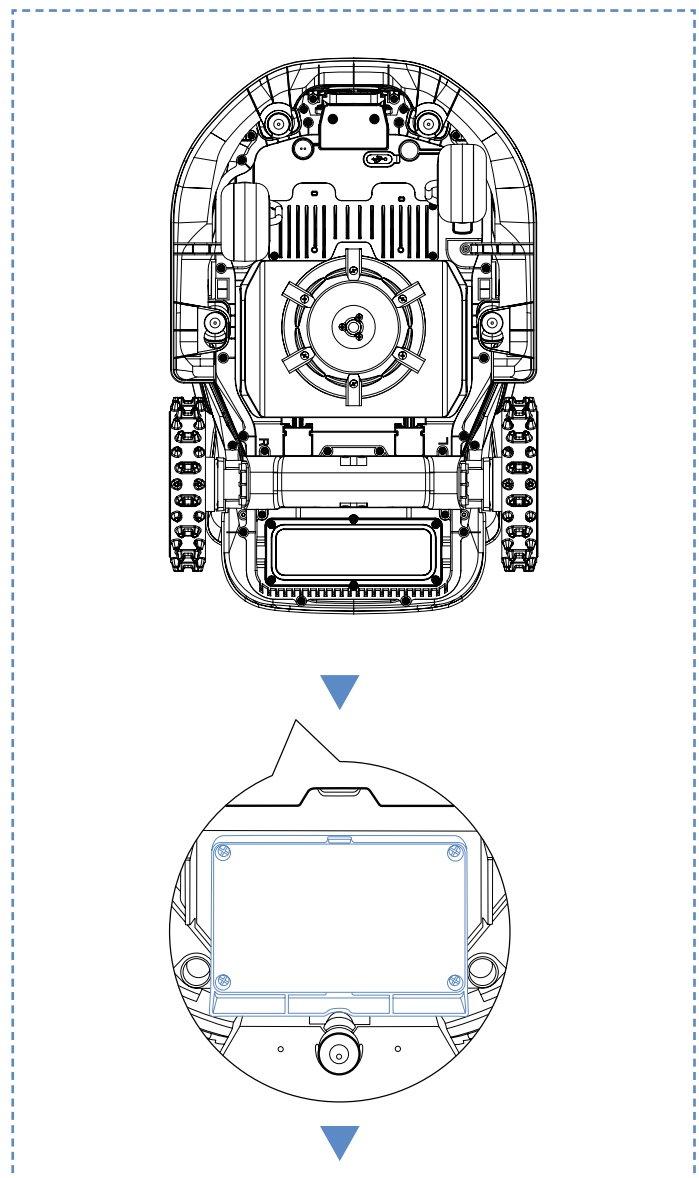

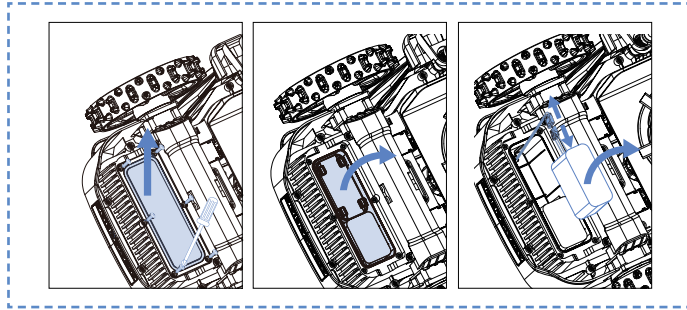

WARNING

- Use only the original battery pack or that of the same model as specified by SUNSEEKER. Each mower contains one battery pack.
- Depending on the specific mower model, the rated capacity of the battery is 4000mAh.
- Do not use non-rechargeable batteries. For the purposes of recharging the battery, only use the detachable supply unit provided with this product.
- Avoid breaking or disassembling the battery casing. Avoid contacting with metal objects to prevent short circuits. Keep away from heat sources, fire, and direct sunlight.
- Please get in touch with your point-of-sale, your local or regional waste management office, or your household waste disposal service for more information about battery and electrical waste.
- It is not intended for the battery compartment to be opened frequently. If a new battery is required, only then should you open the battery compartment.
- The battery pack contains electrolytes. If the electrolyte leakage comes into contact with your skin, wash off with soap and water immediately. Get medical help in case of eye contact and immediately flush the eyes with plenty of water for at least 15 minutes without rubbing.

6.5 Power Supply

Disconnect the power supply:

- A.** Before clearing a blockage.
- B.** Before checking, cleaning or working on the machine.
- C.** After striking a foreign object to inspect the machine for damage.
- D.** Regularly examine the cable, plug, enclosure and other parts. If any damage or signs of aging are found, stop using immediately.

WARNING

- NEVER use a damaged power supply for operation. To prevent a hazard, the damaged supply cable must be replaced by the manufacturer, its service agent, or other appropriately qualified individuals. If the extension cable is faulty, replace it with a SUNSEEKER approved 10 m cable.

- NEVER touch an extension cable or damaged cord before it has been unplugged from the power source or connect it to the power supply. A damaged cable may cause contact with electrical components.
- The power supply should not be used with any other device or battery as this increases the risk of electrical shock, fire, or personal injury. If you use anything other than original batteries, product safety cannot be guaranteed.
- DO NOT charge when the battery is leaking.
- Keep the extension cable away from moving hazardous parts to avoid damage to the cables which can lead to contact with live parts.

Recommendation

Connect the mower and/or its peripherals only to a supply circuit protected by a residual current device (RCD) with a tripping current of not more than 30 mA.

6.6 Storage

- A.** Make sure that the mower is fully charged and turned off before storing it to prevent over-discharge, which could result in permanent damage.
- B.** Store in a dry, cool place indoors. Exposure to sunlight and extreme temperatures (either hot or cold) will accelerate the aging process of components and may cause permanent damage.
- C.** Keep chemicals and heat sources (stoves, radiators, etc.) away from the mower, charging station, and power supply.
- D.** Store the power supply in an area with good ventilation and protect it from moisture.

WARNING

- Unplug the power supply from the power socket if a thunderstorm is predicted. Disconnect all wires and cables that are attached to the charging station. Reconnect when there is no longer a possibility of a thunderstorm.

Extra requirements for winter storage

The mower:

- A.** Clean the mower thoroughly before storage.
- B.** Check the components subject to wear such as the blades.
- C.** Repair or replace them if they are in poor condition.
- D.** Store the mower in a dry and frost-free place, while standing on all wheels, preferably in the original packaging.

The charging station:

- A.** Disconnect from the charging station and unplug the power supply from the power outlet.
- B.** Bring the charging station inside if the ambient temperature falls below -20°C.

6.7 Recycling and End-of-life Disposal

This product is NOT household waste. Get in touch with your municipality, point of sale, or domestic waste service for information on recycling.

WARNING

- This product should not be disposed of in a landfill, burned, or combined with regular household trash. Electrical components may cause danger or serious damage.

7. FAQ and Troubleshooting

7.1 Error message

LED code	App message	Solution
E1	Robot out of work zone	1. Confirm if the machine is outside the map. 2. Bring it back into the work area or start working from the charging station.
E2	Left wheel motor overcurrent (blocked) error	Left wheel motor is stuck, please remove obstacles.
	Right wheel motor overcurrent (blocked) error	Right wheel motor is stuck, please remove obstacles.
E3	Cutter motor overcurrent (blocked) error	1. Cutter motor is stuck, please remove obstacles. 2. Confirm the current cutting height is reasonable.
E4	Robot bumper stuck	1. Confirm if the bumper is stuck or detached. 2. Check for obstacles around the machine. 3. After confirming that the bumper is functioning properly, press any of the START/HOME/OK buttons to unlock it.
E5	Robot lifted	1. Confirm if the machine has been lifted and if there are any obstacles under the machine. 2. Place the robot on a flat surface and press any of the START/HOME/OK buttons to unlock it.
E6	Robot flipped	Confirm if the machine is turned over.
E7	Robot tilted	Confirm if the machine is placed on uneven ground.
E8	Failure to dock on the charging station during recharging	1. Unclean charging contacts on mower or charging station, please clean them with alcohol. 2. Check if the light on charging station is on, maybe charging station has no power. 3. Check if the charging station is installed on a flat surface. If it is uneven, adjust the position of the charging station. 4. Check if there are any obstacles in front of the charging station. If there are any obstacles, please remove them. 5. Check if the machine is obstructed at the charging station area. 6. The reflective strips on the charging station is dirty or damaged, try to clean it or order a new one from service center.
E9	Robot trapped	1. Confirm if there are too many obstacles around the machine. 2. The robot entered a narrow space and couldn't get out. 3. There is a visual misidentification in this area. Use the function of a safe zone to ignore the visual recognition results. 4. Mower is Slipping.
	Out of station error	
	Out of station timeout	
E10	Firmware upgrade failed	1. Check if the WiFi signal is very weak 2. Check if the machine is charging on a charging station
E13	Charging abnormality	1. Unclean charging contacts on mower or charging station, please clean them with alcohol. 2. Check if the light on charging station is on, maybe charging station has no power. 3. Check if the charging station is installed on a flat surface. If it is uneven, adjust the position of the charging station.
E14	The current map area is too large and exceeds the maximum working area supported by the robot	Build a new map within the nominal capability range of product.

LED code	App message	Solution
E17	Path plan failed, please check whether any obstacles around the robot	<ol style="list-style-type: none"> 1. Confirm if there are too many obstacles around the machine. 2. The robot entered a narrow space and couldn't get out. 3. There is a visual misidentification in this area. Use the function of a safe zone to ignore the visual recognition results. 4. Confirm if the charging station is out of map and customer doesn't build a corridor from station to the map. 5. Try to rebuild the corridors between different areas and rebuild the connecting corridors between charging stations and the map if it's out of map.
E18	Low battery cannot start to work	Confirm if the battery pack is too low, and let it work after it is fully charged.
E22	The front camera is obscured	Please check if the camera is cover by some object and wipe the camera before starting.
	the front camera error	Please restart the robot before working.
E23	Empty Map Error	Please create a map before starting.
E25	Mapping failed	<ol style="list-style-type: none"> 1. Confirm the camera is not obstructed or dirty. 2. Confirm the LiDAR is not obstructed or dirty.
E28	Location failed	<ol style="list-style-type: none"> 1. Please wipe the lidar to ensure there is no stain on the surface of the lidar. 2. Please ensure the lidar is not blocked by obstacles. 3. If the machine is in a narrow space, please remotely control the machine to an open area and try again. 4. If the above methods cannot solve the problem, please put the robot back to the charging pile and then restart it.
E30	Lidar recovering.Please wait	Please do not move the robot. The radar abnormality is being restored. Please wait patiently.
BP	Battery temperature error	Confirm if the ambient temperature is too high or too low, wait until the temperature returns to normal before letting the mower work.
NA	Unable to reach other work areas, will go back to charging station	<ol style="list-style-type: none"> 1. Confirm if there are too many obstacles around the machine 2. The robot entered a narrow space and couldn't get out 3. There is a visual misidentification in this area, Use the function of a safe zone to ignore the visual recognition results 4. Try to rebuild the corridors between different areas.
	PIN code input error	Please enter the correct PIN code to unlock the robot.
	the schedule task is not executed	<ol style="list-style-type: none"> 1. The battery is low and cannot execute the currently scheduled task. 2. Battery is fully charged, machine will automatically begin working if it is within the scheduled time. 3. The machine has detected rain and cannot execute the currently scheduled task. 4. After the rain stops, the machine will automatically begin working if it is within the scheduled time.
STOP	The machine is in "STOP" mode, the device can not work.	<ol style="list-style-type: none"> 1. If you have pressed the stop button before, need to click "START" and "OK" to restart. 2. Check if the red stop button is stuck, click "START" and "OK" to restart after cleaning is complete.
EE	Machine component abnormality	Please turn off the machine and restart it
	Machine sensor abnormality	
	The Lidar abnormality	

Instructions on how to proceed in case of abnormal vibrations:

- A.** Turn off the machine.
- B.** Place the lawnmower upside-down on a spotless, soft surface.
- C.** Check the condition of the blades for damage or malfunction.
- D.** It is recommended to replace all blades.
- E.** Turn the machine back over to start working.

7.2 Trouble shooting

If you encounter any product or app-related problems, common issues and questions, check out the FAQ articles on the Sunseeker official website (www.sunseekertech.com) or from the "Help and feedback" section from the App.



8. Important Information

8.1 Data Privacy

Processing of personal data within Platform S

• Who and why?

When you register for and use Sunseeker's Platform S, Sunseeker (or "we"), as the controller, will process your personal data. We will process your personal data in order to:

1. Provide you with Platform S connection or to make you an offer for such service. The legal basis is that the processing is necessary for the performance of the contract that you have entered into with us, or to take steps prior to entering into a contract with us.
2. Further develop and improve our products and services. The legal basis is our legitimate interest in developing and improving our products and services.
3. Enable connectivity of Platform S (Internet of Things): use partner integrations (for example smart assistants, including voice enabled devices); use connectivity platforms to connect Platform S to third party devices, apps, and services; and build your own smart home integration. The legal basis is that the processing is necessary for the performance of the contract that you have entered into with us.
4. Provide you with relevant information relating to your Platform S experience. The legal basis is our legitimate interest to keep you informed of your specific products and services and its features.
5. Provide you with support and troubleshooting regarding Platform S. The legal basis is that the processing is necessary for the performance of the contract that you have entered into with us.

If you have given us your consent (in which case the legal basis is your consent), we may also process your personal data for the following purposes:

1. Send you customized advertisements and newsletters about our products and services.
2. Send you customer surveys and analyze the input you provide as further detailed in such communication.

Your data will be processed for as long as it is required by Sunseeker to fulfil the above-mentioned purposes, but under no circumstances for longer than the applicable laws allow.

• What personal data do we process?

We may process the following personal data:

1. Personal details: first and last name, nationality, language preferences;
2. Contact details: email address, postal address;
3. Account information: account age, password, account number;
4. Other data related to your Platform S: mower name, pairing names, actions triggered through the use of partner integrations, and device information.

• Use of location data

Some of our services only work if we can determine the location of your mower (e.g. weather display). When you share your mower location with us, the data is stored as part of your profile and may be sent to third parties in pseudonymized form for the purposes of providing the relevant service (e.g. to park the mower in case of heavy rain).

8.2 Limited Warranty

This Limited Warranty covers only defects in materials or workmanship of the product and its components when used under normal, ordinary conditions. If a defect covered by this Limited Warranty arises, Sunseeker or its authorized representatives, at their sole discretion, will repair or replace the defective Product or components in accordance with this Limited Warranty. The applicable warranty period begins on the date of original purchase from Sunseeker or an authorized Sunseeker reseller, distributor, or dealer.

Warranty Conditions

Registration: Register the product online at www.sunseekertech.com within 30 days of purchase to receive a 36-month warranty. Without registration, a 24-month warranty will apply.

Battery Warranty: Battery packs are covered for a 12-month period only, regardless of online registration.

Proper Use: The product must not have been misused, abused, neglected, altered, modified, or repaired by anyone other than an authorized service center.

Approved Parts: Only Sunseeker Elite-approved accessories and parts may be used with this product.

Damage Prevention: The product must not have sustained damage due to foreign objects, substances, or accidents.

Storage Conditions: The battery and product must be stored indoors if the outside temperature is below 0°C.

Exclusions from Warranty

Normal Wear and Tear: Components that experience natural wear and tear from standard use, such as blades, are not covered under this warranty.

Unauthorized Maintenance: Damage, malfunctions, or failures resulting from unauthorized or improper maintenance, handling, or overloading are excluded.

High-Pressure Washer Damage: Damage caused by exposure to high-pressure washing is not covered.

To make a warranty claim, you must provide proof of purchase in the form of a valid receipt that shows the date and place of purchase.

This warranty is in addition to your statutory rights and does not cover any accessories supplied with the product. All repairs and replacement products are covered under the limited warranty for the remainder of the original warranty period from the date of purchase.





8.3 Disclaimers

We provide customers with after-sale services, excluding the following circumstances:

1. Crashes damage caused by non-manufacturing factors, including but not limited to, user errors.
2. Damage caused by unauthorized modification, disassembly, or shell opening not in accordance with official instructions or manuals.
3. Damage caused by improper installation, incorrect use, or operation not in accordance with official instructions or manuals.
4. Damage caused by a non-authorized service provider.
5. Damage caused by unauthorized modification of circuits and/or mismatch or misuse of the battery and charger.
6. Damage caused by users who do not follow instructions and manual recommendations.
7. Damage caused by operation in bad lawn conditions (i.e. large areas of puddles when restricted areas are not properly set, locations with abundance of stones covering lawn surface, etc.)
8. Damage caused by operating the product in environments with electromagnetic interference, including mining areas or proximity to radio transmission towers, high-voltage wires, substations, etc.
9. Damage caused by operating the product in environments suffering from interference from other wireless devices, such as transmitters, video-downlinks, Wi-Fi signals, etc.
10. Damage caused by reliability or compatibility issues when using unauthorized third-party parts.
11. Damage caused by operating the unit with a low-charged or defective battery.
12. Damage caused by unpredictable factors such as car collisions, wild animal attacks, floods, etc.

This content is subject to change without prior notice.

WARNING for button cell or coin battery:

- a) Remove and immediately recycle or dispose of used batteries according to local regulations and keep away from children.
- b) Do NOT dispose of batteries in household trash or incinerate.
- c) Even used batteries may cause severe injury or death.
- d) Call a local poison control center for treatment information.
- e) Battery type: CR2032.
- f) Nominal voltage: 3.0 Vdc.
- g) Non-rechargeable batteries are not to be recharged.
- h) Do not force discharge, recharge, disassemble, heat above (manufacturer's specified temperature rating) or incinerate. Doing so may result in injury due to venting, leakage or explosion resulting in chemical burns.
- i) The product contains non-replaceable button cell.

8.4 Contact Us

Sunseeker Intelligent Technology SE

Address: Theodorstraße 41M1, D-22761 Hamburg

Email: support@sunseekertech.eu

Website: www.sunseekertech.com