

设计版本号	产品名称   Product name	比例   scale	日期   Date	设计师   Designer	审核   Audit
Rev_V2_EN	DR-HPF012_美规说明书	1:1	20250724	Yan/beryl	Laura/phil
Hesung   Innovation 和生创新	材质印刷与 技术要求	封面封底:80g书纸 内页: 80g书纸 印刷要求: 双面印刷, 文字线图清晰 装订方式: 骑马钉装订	字体   Fonts	Manrope	尺寸   Size
					105mm × 150mm

\*此页删除不做印刷

图纸设计禁止修改, 尺寸刀模图为准

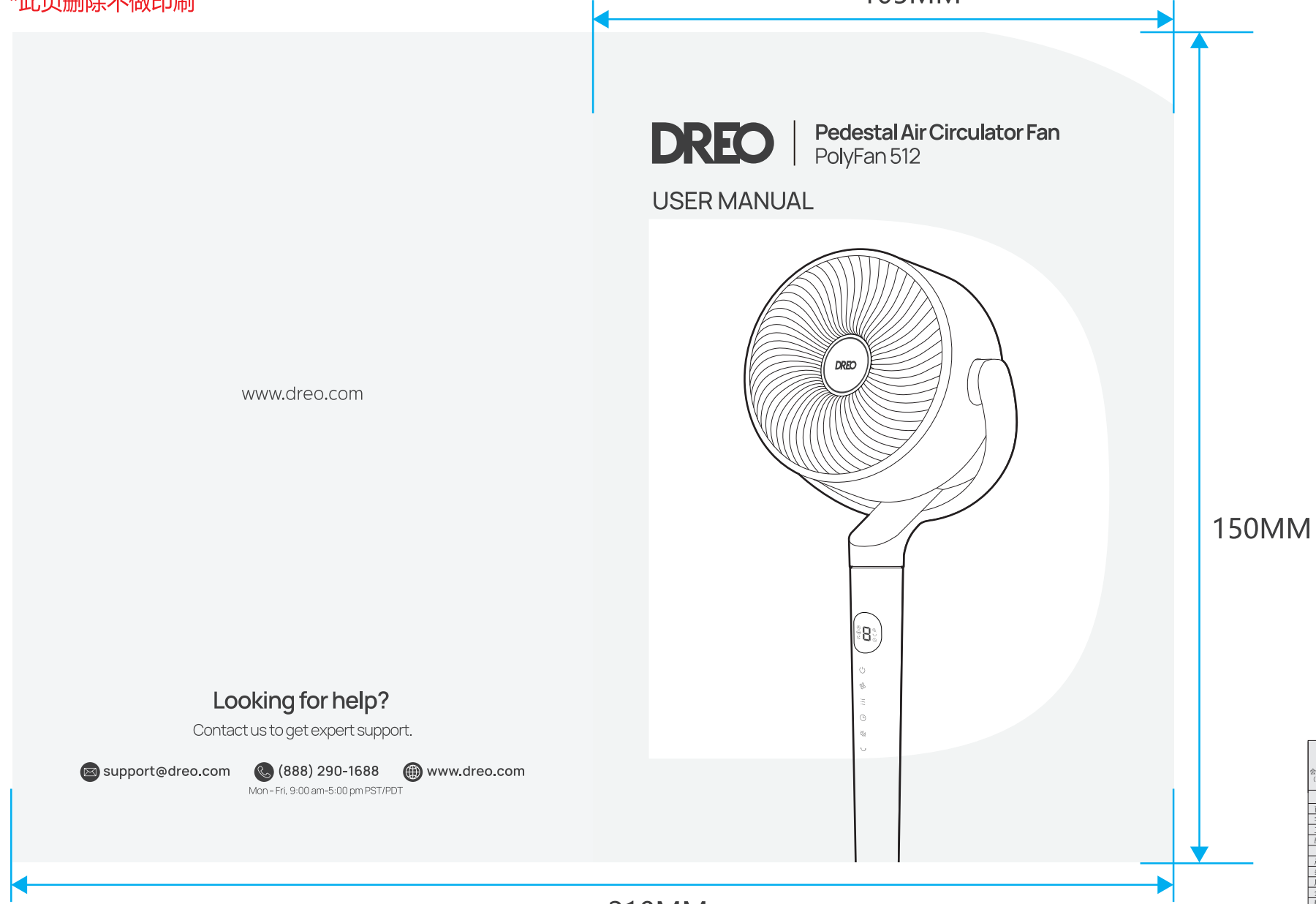

	裁切线
	正折线
	反折线
	出血位
	粘胶区域

<b>图层使用规范:</b>
1、备注信息图层为非印刷区域, 展示印刷物料基础信息。 2、刀板线、备注工艺、尺寸层展示印刷工艺部分。 3、画面信息层展示印刷展示图片与文字。
*电子文档为Adobe Illustrator制作
文件格式: model规格类目日期.AI (为可编辑原始文档) 文件格式: model规格类目日期.pdf (为文件转曲不可编辑文档)

审核 检查事项 余量以“√”形式确认 (负责部门/日期/确认)
审核检查事项
图板规范
字符高度
工艺材质
颜色标识
产品文案
条码检查
厂址
金线分
警告标准
执行标准
产品尺寸
外/内箱尺寸
0EM信息*
产品包装信息
请相关部门确认产品、包装等信息!
*0EM信息: 委托方及被委托方 信息(名称、地址、 邮编、电话、生产 许可证、卫生许可 证)

设计师	审核	产品负责人	法规	采购
-----	----	-------	----	----

# DREO

Pedestal Air Circulator Fan  
PolyFan 512

## USER MANUAL

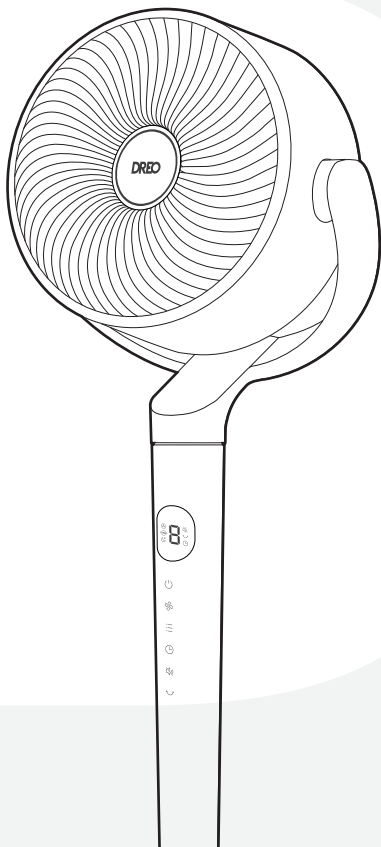

//

# Thanks for Choosing **DREO!**

Your support means the world to us. We hope you enjoy our product as much as we did creating it.

# CONTENTS

## 01

IMPORTANT SAFETY  
INSTRUCTIONS

1-3

---

## 02

ASSEMBLING YOUR  
APPLIANCE

4-6

---

## 03

KNOWING YOUR  
APPLIANCE

7-8

---

## 04

USING YOUR  
APPLIANCE

9-12

---

## 05

CLEANING  
AND MAINTENANCE

13-16

---

## 06

TROUBLESHOOTING

17

---

## 07

DREO CUSTOMER  
CARE

18-20

---

# IMPORTANT SAFETY INSTRUCTIONS

# 01



READ ALL CAUTION-ARY MARKINGS ON THE APPLIANCE AND SAFETY INSTRUCTIONS IN THE USER MANUAL BEFORE

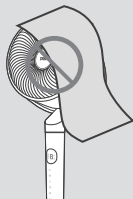

**Do not** cover the air inlet and outlet while in operation.



**Do not** use the air circulator near flammables and combustibles.

## General Safety

1. Children shall not play with the appliance. Cleaning and maintenance shall not be performed by children without supervision.
2. Use the appliance as described in the user manual only. Any other use not recommended in the user manual may cause fire, electrical shock, or personal injury.
3. This appliance can be used by children aged above 8 years and persons with reduced physical, sensory or mental capabilities or lack of experience and knowledge if they have been given supervision or instruction concerning use of this appliance in a safe way and understand the hazards involved.

## Operation Safety

1. Place the appliance on a flat, dry surface before use.
2. **Do not** immerse in water and any other liquids.
3. **Do not** use the appliance until the base is installed.
4. **Do not** insert your fingers, pencil and any other objects into the grilles under any circumstances.
5. **Do not** dismantle, repair, or modify. All servicing should be performed by qualified personnel.
6. **Do not** operate the unit close to the curtain. Do not hang foreign objects on the grille to prevent damaging the balance of the fan or rotational structure.

7. **Do not** operate the fan under overly humid, high-temperature, dusty environment or the place where acid or alkali is stored.
8. Fans should never blow directly on infants, the elderly, and patients for a long time.

## Electricity Safety

### WARNING:

1. Make sure that the voltage of your electricity supply is the same as that indicated on the appliance.
2. Always unplug before cleaning or leaving the appliance unused for a long period of time. Keep your hands dry when plugging/unplugging.
3. Do not operate any air circulator with a damaged cord or plug. Discard air circulator or return to an authorized service facility for examination and/or repair.
4. Do not run cord under carpeting. Do not cover cord with throw rugs, runners, or similar coverings. Do not route cord under furniture or appliances. Arrange cord away from traffic area and where it will not be tripped over.
5. **WARNING:** To reduce the risk of fire or electric shock, do not use this air circulator with any solid-state speed control device.
6. **WARNING:** To reduce the risk of fire, electric shock or injury to persons, do not use replacement parts that have not been recommended by the manufacturer (e.g. parts made at home using a 3D printer).
7. If the supply cord is damaged, it must be replaced by the manufacturer or its service agent or a similarly qualified person in order to avoid a hazard.
8. This appliance employs overload protection (fuse). A blown fuse indicates an overload or short-circuit situation. If the fuse blows, unplug the product from the outlet. Replace the fuse as per the user servicing instructions and check the appliance. If the replacement fuse blows, a short-circuit may be present and the appliance should be discarded or returned to an authorized service facility for examination and/or repair.
9. This appliance has a polarized plug (one blade is wider than the other). To reduce the risk of electric shock, this plug is intended to fit in a polarized outlet only one way. If the plug does not fit fully in the outlet, reverse the plug. If it still does not fit, contact a qualified electrician. Do not attempt to defeat this safety feature.

# FOR HOUSEHOLD USE ONLY READ AND SAVE THESE INSTRUCTIONS

## Gentle Reminder:



Check the appliance regularly and refer to TROUBLESHOOTING or contact our customer support if it shows any of the following signs:

- Power cord or plug is damaged.
- Loud noise, unusual smell or excessive heat.

## Specifications

Model No.:	DR-HPF012
Input	AC 120V~60Hz
Rated Power	36W
Battery Type	CR2025 3V

# ASSEMBLING YOUR APPLIANCE

# 02

## Assembly Instructions

When using the appliance for the first time, remove the wraps and attach the parts by following the steps below.

1

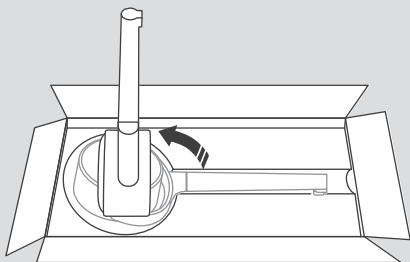

Turn the fan body upside down.

2



Install the short pedestal into the fan body column by rotating the pedestal until tightened.

3

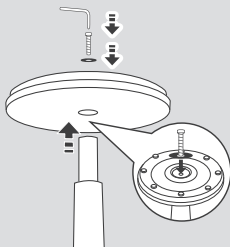

Push the column into the base, then thread the screw through the flat washer and use the included screwdriver to drive the screw into the bottom of the column.

4

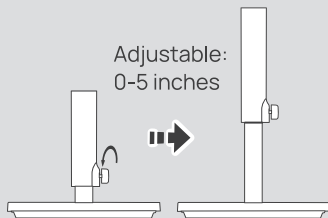

Adjustable:  
0-5 inches

Hold the main body while rotating the Adjustment Collar counterclockwise to raise or lower the pedestal air circulator fan to the desired height.

5

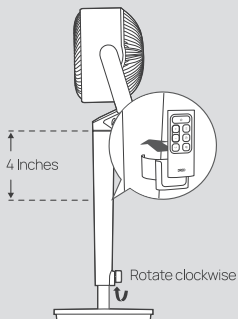

4 Inches

Rotate clockwise

Tighten the adjustment collar and install the remote control holder

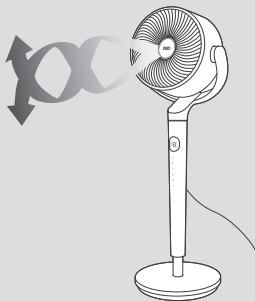

## CAUTION

Do not operate the pedestal air circulator fan if the base has not been installed. Please exercise caution and handle the base with care during installation.

# Package Contents

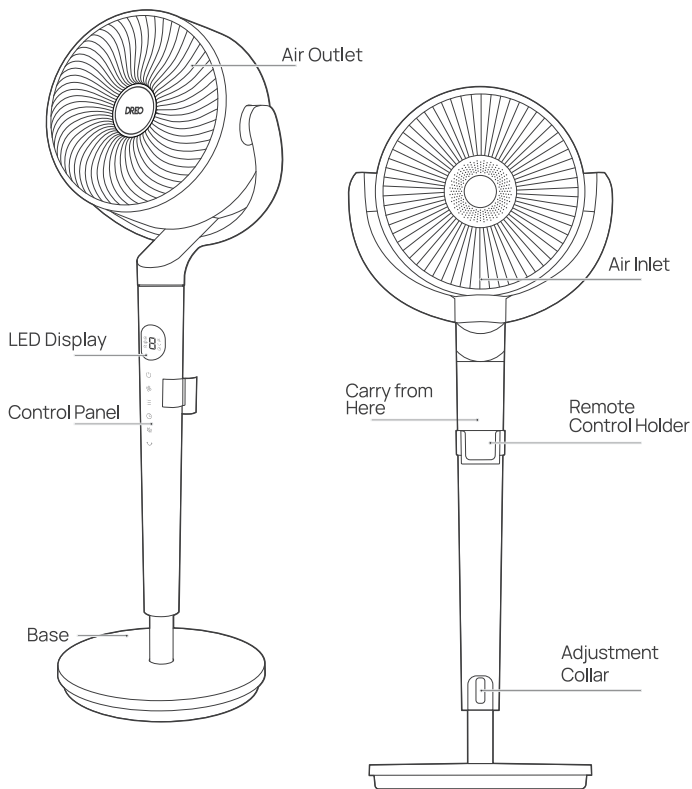

Remote Control (Battery Included)



Remote Control Holder



Screw for Base



Screwdriver for Base



Flat Washer

# KNOWING YOUR APPLIANCE

# 03

## Control Panel



### Power Button

- Turn power on/off
- Long press 10 seconds to reset to factory settings.



### Fan Speed Button

- 1-9 Levels



### Working Mode Button

- Switch between Normal/Auto/Turbo/Sleep.



### Timer Button

- Select to set a timer (0-8h).



### Mute Button

- Turn on/off the button sounds
- Long press 3s to activate/deactivate fan repositioning.



### Horizontal Oscillation Button

- Sweep airflow horizontally (0°/30°/60°/90°/120°)

## LED Display



Auto Mode



Turbo Mode



Sleep Mode



Fan Speed/Timer  
Hour



Mute



Horizontal  
Oscillation



Timer

# USING YOUR APPLIANCE

# 04

## Getting the Most out of Your Pedestal Air Circulator Fan

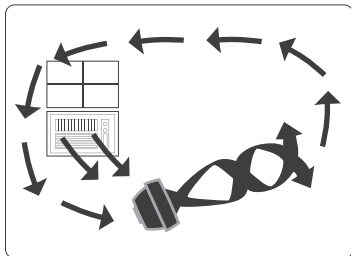

### Summer:

Use with Air Conditioner

Position the pedestal air circulator fan in front of your AC to circulate cold air and provide better cooling.

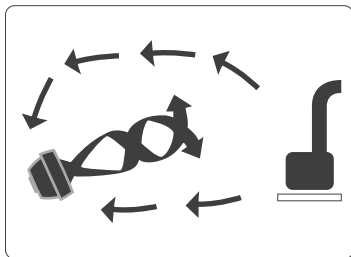

### Winter:

Use with Heater

Send the heat to corner of the room and circulate warm air faster.

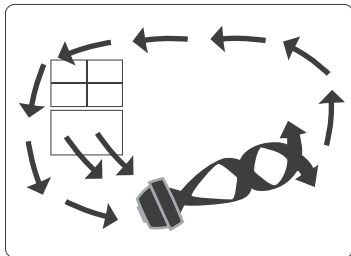





### Spring & Fall:

Circulation

Make the indoors as fresh and pleasant as the outdoors.

## Working Modes (Press on the remote)

	<b>Normal Mode</b> Fan runs at the fixed speed.
	<b>Auto Mode</b> Fan automatically increases speed when room temp is higher and decreases speed when temp is lower.
	<b>Turbo Mode</b> Fan runs at the maximum speed.
	<b>Sleep Mode (Mute Auto On)</b> Balance comfort and noise by automatically decreasing fan speed as you fall sleep.  If the fan speed is higher than 3, it will decrease two times at most, one speed every 30 minutes, then it will remain constant.

## Additional Features





### Timer

When the fan is ON/OFF, touch the timer button  repeatedly to set a timer from 1 to 8 hours. When the timer ends, the fan will stop/start running automatically. To cancel, set the time to 0 hour.

**Note:** When the auto off timer is enabled, display will return to fan speed after 3 seconds.



### Child Lock

Long press the Mute button  and Horizontal Oscillation button  at the same time for 3 seconds to turn on/off Child Lock.

**Note:** Child Lock doesn't apply to operations from the remote control. You can also turn off Child Lock by re-plugging in, resetting to factory settings.



### Memory

If the fan is turned OFF or disconnected from power, it will operate under the previous settings (except the Timer setting) when it is turned ON again.



### Countdown Display

When long pressing buttons for Factory Reset, Child Lock, and Mute, a countdown will show on the display accordingly.



### Display Auto Off

Display turns off after 1 minute.  
Wake up the display with any button.

## Remote Control

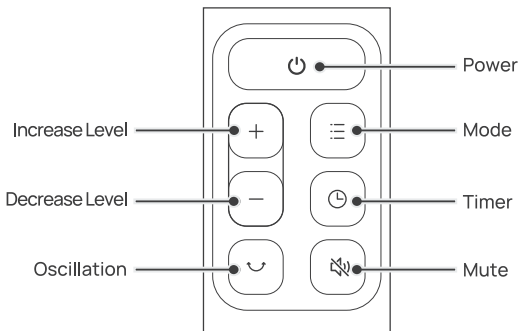

## Battery Replacement

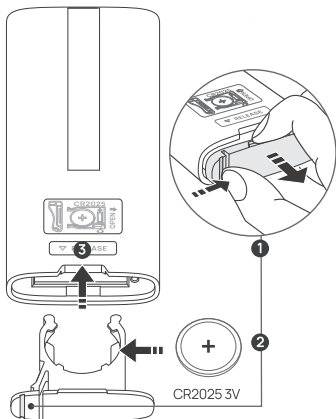

- 1 Keep the locking tab pressed while pulling out the battery holder from the slot at the back.
- 2 Replace with the same battery type with the (+) side facing up.
- 3 Push in the holder until securely locked in place.

Note: If the appliance doesn't respond when using the remote control in close range please consider replacing the battery.

# **WARNING**

- **INGESTION HAZARD:** This product contains a button cell or coin battery
- **DEATH** or serious injury can occur if ingested.
- A swallowed button cell or coin battery can cause **Internal Chemical Burns** in as little as **2 hours**.
- **KEEP** new and used batteries **OUT OF REACH of CHILDREN**
- **Seek immediate medical attention** if a battery is suspected to be swallowed or inserted inside any part of the body.



- a) Remove and immediately recycle or dispose of used batteries according to local regulations and keep away from children. Do NOT dispose of batteries in household trash or incinerate.
- b) Even used batteries may cause severe injury or death.
- c) Call a local poison control center for treatment information.
- d) Compatible battery type: CR2025.
- e) Battery nominal voltage: 3.0 Vdc
- f) Non-rechargeable batteries are not to be recharged.
- g) Do not force discharge, recharge, disassemble, heat above (rated temperature: 140 °F) or incinerate. Doing so may result in injury due to venting, leakage or explosion resulting in chemical burns.
- h) Ensure the batteries are installed correctly according to polarity (+ and -).
- i) Do not mix old and new batteries, different brands or types of batteries, such as alkaline, carbon-zinc, or rechargeable batteries.
- j) Remove and immediately recycle or dispose of batteries from equipment not used for an extended period of time according to local regulations.
- k) Always completely secure the battery compartment. If the battery compartment does not close securely, stop using the product, remove the batteries, and keep them away from children.

# CLEANING AND MAINTENANCE

# 05

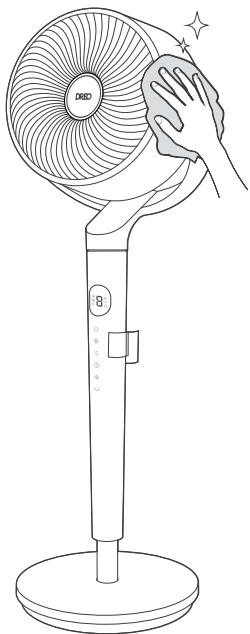

## Outer Surface

Gently wipe off the dust with a soft, dry cloth.

## Base

The base can be disassembled in the reverse order of assembly.

## CAUTION



1. Always unplug the fan before any cleaning or maintenance to avoid the risk of fire, electric shock, or injury to persons.
2. Do not immerse in water or get water inside the motor housing.
3. Do not use any chemical agents when cleaning the fan.
4. Store in a cool, dry place and cover it to protect from dust.



## WARNING

To reduce the risk of electrical shock and injury to persons, turn off and unplug the appliance before any cleaning and maintenance.

1

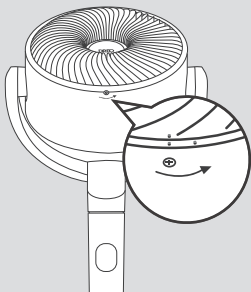

Remove the screw on the front grille, rotate the grille counterclockwise to take off.

2

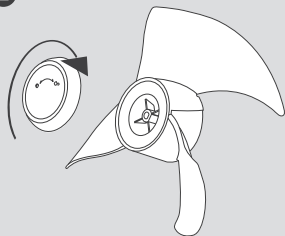

Remove the blade cap by rotating it as shown and take the blade assembly out of the shaft.

3

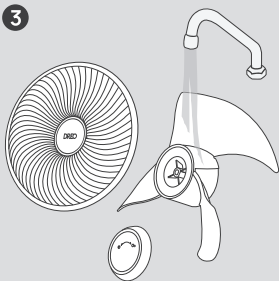

Rinse cap, blades, and grille under running water or with a clean, damp cloth.

4

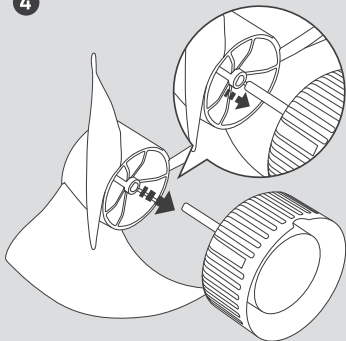

Dry up all parts, and insert the blade assembly back into the shaft by aligning the centers.

5

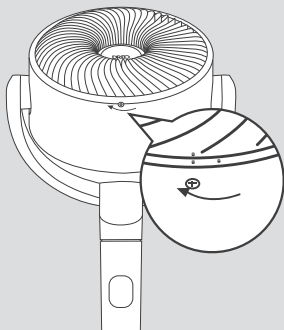

Align the point on the front grille with the right point on the casing, then rotate the grille clockwise and install the screw back in place.

## User Servicing Instructions (Fuse)

This appliance features a fused safety plug that protects against overload or short-circuit situations. If the fuse blows, please cut off power and follow the below instructions or consult a qualified electrician.

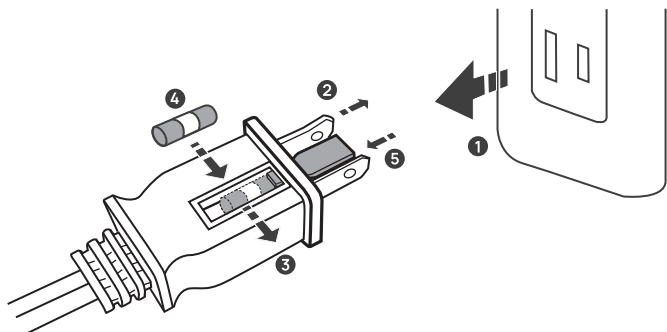

- 1 Grasp plug and remove from the receptacle or other outlet device. Do not unplug by pulling on cord.
- 2 Open fuse cover. Slide open fuse access cover on top of attachment plug towards blades.
- 3 Remove fuse carefully. Push the fuse from the other side to remove the fuse.
- 4 Risk of fire. Replace fuse only with 5 Amp.125 Volt fuse.
- 5 Close fuse cover. Slide closed the fuse access cover on top of attachment plug.



### WARNING

Risk of fire. Do not replace attachment plug.  
Contains a safety device(fuse) that should not be removed.  
Discard product if the attachment plug is damaged.

## **My pedestal air circulator fan won't turn on!**

Make sure that the cord is connected to a powered outlet and the mains voltage corresponds with the voltage indicated on the pedestal air circulator fan.

## **My pedestal air circulator fan is shaky and wobbling!**

1. Place the pedestal air circulator fan on a flat, level surface.
2. Incorrect installation might also cause shakiness. Please refer to the assembly instructions in page 4-5.

## **My pedestal air circulator fan is making vibration and noise!**

1. Place the pedestal air circulator fan on a flat, level surface.
2. Be sure not to insert anything into the air inlet and outlet.
3. It is normal that the fan makes a little noise when manually adjusting the fan head.

If your problem is not listed or still persists, please contact our Customer Support (see page 20)

# DREO CUSTOMER CARE

# 07

## 12-MONTH LIMITED WARRANTY

### What is Covered

DREO warrants to you that your product will be free from original defects in materials and workmanship for a period of twelve (12) months from the date of your purchase, when you use your product for intended purposes in accordance with this User Manual.

Please retain your proof of purchase. If you do not retain your proof of purchase, your warranty will start two (2) months from the date of manufacture printed on your product label.

### What is Not Covered

This limited warranty only applies to the original purchaser of your product and is non-transferable. This warranty is only valid if your product is used in the country in which you originally purchased it. In addition, this warranty will not apply, and DREO will not be liable for any costs, damages, or repairs, in connection with any of the following:

- Accidents or use of your product with inappropriate force;
- Damage or destruction caused by wrong voltage or unstable electric current;
- Normal wear and tear;
- Careless operation or handling, misuse, abuse, neglect, and/or failure to maintain or use your product in accordance with this User Manual;
- Any partially or completely altered, modified and/or dismantled products;
- Reduction in battery discharge time due to battery age or use (as applicable);
- Products with altered or removed serial numbers;
- Clearing any blockages from the product;
- Purchases from retailers and distributors not authorized by DREO to sell this product;
- Defects caused by or resulting from damages from shipping or handling by any third party not authorized by DREO to ship or handle your product; or
- Defects caused by or resulting from repairs, service, improper maintenance, or alteration to your product or any of its components by anyone other than a repair person authorized by DREO.

Any service and customer support that DREO provides to you under this limited warranty will not extend the duration of this limited warranty.

## Warranty Limitations and Exclusions

ANY IMPLIED WARRANTIES RELATING TO YOUR PRODUCT, INCLUDING BUT NOT LIMITED TO THE WARRANTY OF MERCHANTABILITY AND THE WARRANTY OF FITNESS FOR A PARTICULAR PURPOSE, ARE LIMITED TO THE DURATION OF THE LIMITED WARRANTY SET FORTH ABOVE AND ARE OTHERWISE DISCLAIMED.

THIS LIMITED WARRANTY SHALL BE THE SOLE REMEDY OF THE PURCHASER OR USER OF THE PRODUCT, AND DREO SHALL NOT BE LIABLE FOR AN ALLEGEDLY DEFECTIVE OR DAMAGED PRODUCT EXCEPT TO REPAIR OR REPLACE IT IN ACCORDANCE WITH THIS LIMITED WARRANTY. DREO WILL NOT BE LIABLE FOR SPECIAL, INCIDENTAL, INDIRECT, CONTINGENT, OR CONSEQUENTIAL DAMAGES OR LOSSES OF ANY NATURE THAT YOU MAY INCUR IN CONNECTION WITH YOUR PURCHASE OR USE OF YOUR PRODUCT.

Some jurisdictions do not allow limitations on how long an implied warranty lasts or the exclusion or limitation of incidental or consequential damages, so the above limitations or exclusions may not apply to you. This limited warranty gives you specific legal rights, and you also may have other rights which vary from jurisdiction to jurisdiction.

## Limited Remedies

If your product fails because of an original defect in material and/or workmanship during the warranty period, DREO will repair or replace (in DREO's sole discretion) your product.

To obtain warranty service on your product, contact us at support@dreo.com or at (888) 290-1688 (available from Monday-Friday, 9:00 AM-5:00 PM PST/PDT) for further instructions.

**IN THE EVENT OF AN ORIGINAL DEFECT IN MATERIAL AND/OR WORKMANSHIP, TO THE EXTENT PERMITTED BY LAW, THE REMEDIES SET FORTH IMMEDIATELY ABOVE ARE YOUR SOLE AND EXCLUSIVE REMEDIES.**

## FCC Statement

This device complies with Part 18 of the FCC Rules. Operation is subject to the following two conditions: (1) this device may not cause harmful interference, and (2) this device must accept any interference received, including interference that may cause undesired operation.

Please note that changes or modifications of this product is not expressly approved by the party responsible for compliance could void the user's authority to operate the equipment.

NOTE: This equipment has been tested and found to comply with the limits for a Class B digital device, pursuant to Part 15 of the FCC Rules. These limits are designed to provide reasonable protection against harmful interference in a residential installation. This equipment generates, uses and can radiate radio frequency energy and, if not installed and used in accordance with the instructions, may cause harmful interference to radio communications. However, there is no guarantee that interference will not occur in a particular installation.

If this equipment does cause harmful interference to radio or television reception, which can be determined by turning the equipment off and on, the user is encouraged to try to correct the interference by one or more of the following measures:

- Reorient or relocate the receiving antenna.
- Increase the separation between the equipment and receiver.
- Connect the equipment into an outlet on a circuit different from that to which the receiver is connected.
- Consult the dealer or an experienced radio/TV technician for help.

Model No.: DR-HPF012  
Rev\_1.3\_EN

## We're Here to Help!

 (888) 290-1688 (Mon - Fri, 9:00 am-5:00 pm PST/PDT)

 support@dreo.com

 www.dreo.com



[www.dreo.com](http://www.dreo.com)

## Looking for help?

Contact us to get expert support.



[support@dreo.com](mailto:support@dreo.com)



[\(888\) 290-1688](tel:(888)290-1688)



[www.dreo.com](http://www.dreo.com)

Mon - Fri, 9:00 am-5:00 pm PST/PDT