

# General User Manual for IMOU Security Cameras

## Content:

Set Up Your Camera.....	2
Camera Home Page .....	3
Pan/Tilt Control .....	4
Detection Settings.....	5
Siren and Abnormal Sound Detection .....	6
Imou Cloud Storage Plan.....	7
Storage Settings.....	8
Share Device .....	9
IR LED Control .....	10
Status LED Control .....	11
Image Rotation.....	12
Time Zone .....	13
Date Format Setting .....	14
Alarm Events .....	15
Personal Info .....	16
System Info .....	17
Playback SD card or Imou Cloud Record .....	18
Device Center .....	19
Local Files .....	20
LAN View.....	21

# 1, Set Up Your Camera

Step 1. Download App: Get the Imou Life app from the Apple App Store or Google

Play, or by scanning the QR code below;

Step 2. Log In: Launch the App, create your imou account and login;

Step 3. Add Camera: Scan the QR code on the camera or enter serial number manually.

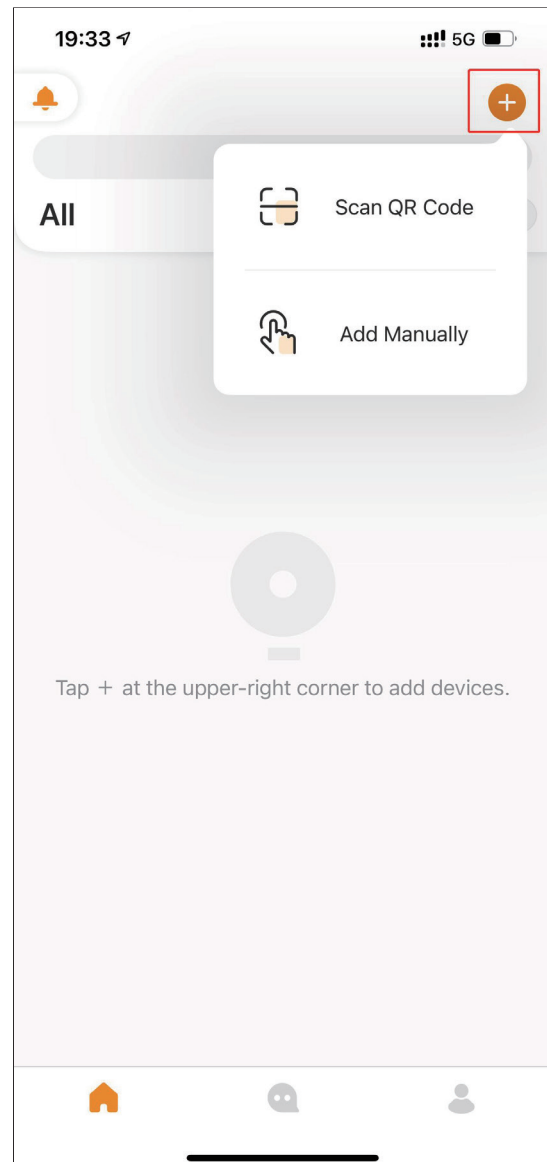
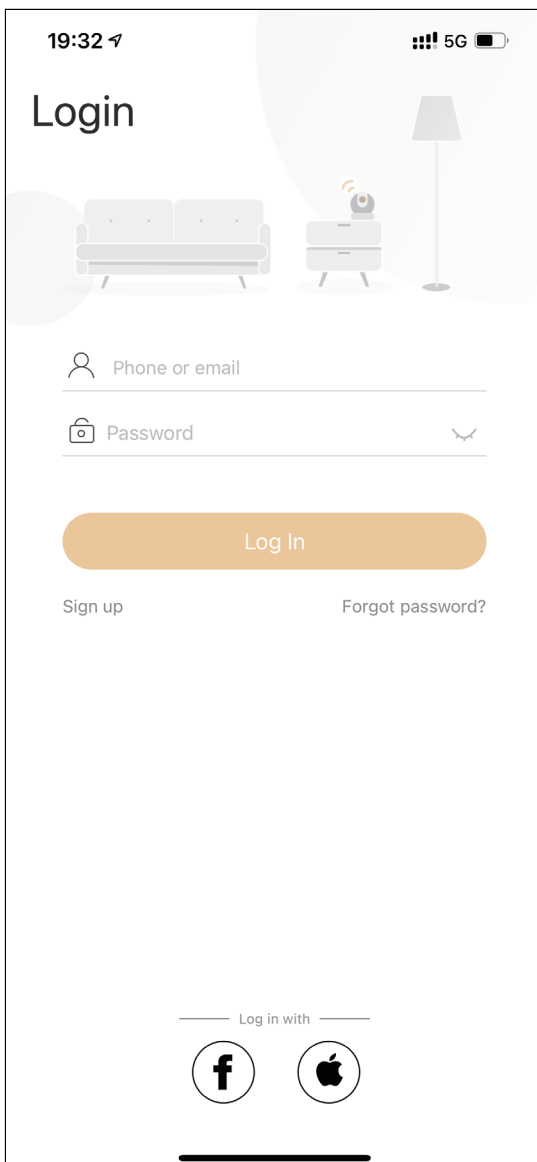

## 2, Main Camera Controls

2.1 Camera Home Page: This page listed all your cameras and you can manage them easily, tap to view the live video.

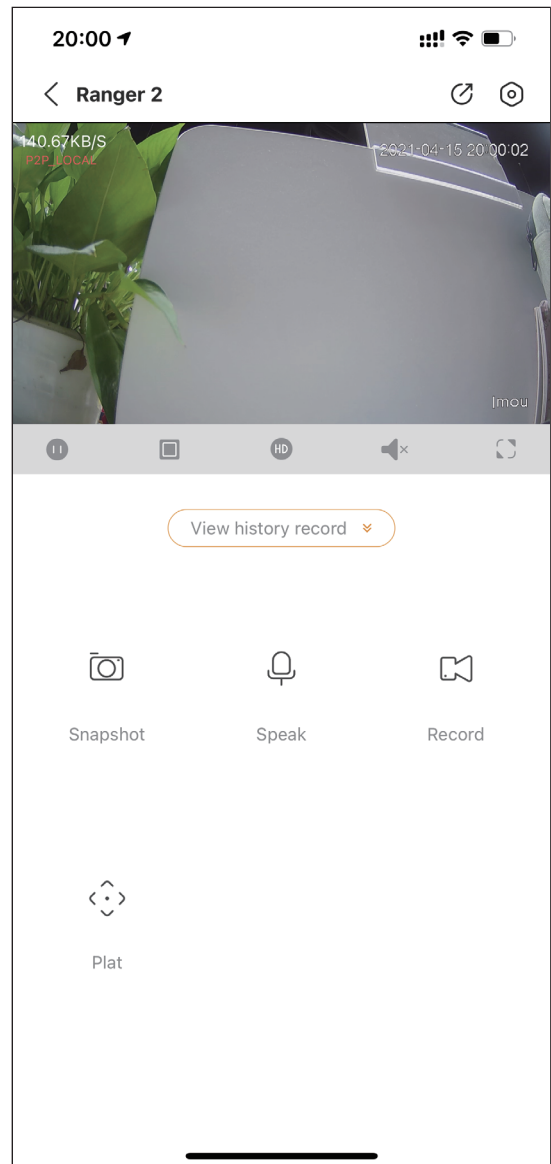
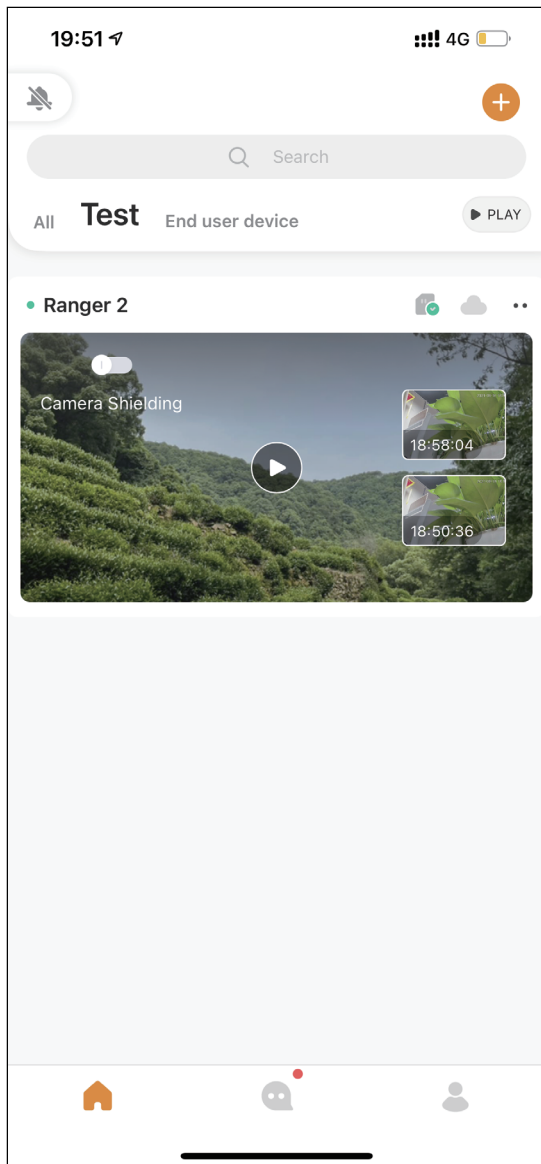

2.2 Pan/Tilt control and two way audio: On the Live View page, tap "Plat" to enter the control page. Tap on the Pan & Tilt panel to control your camera to move; activate the microphone icon and talk to the people around the camera.

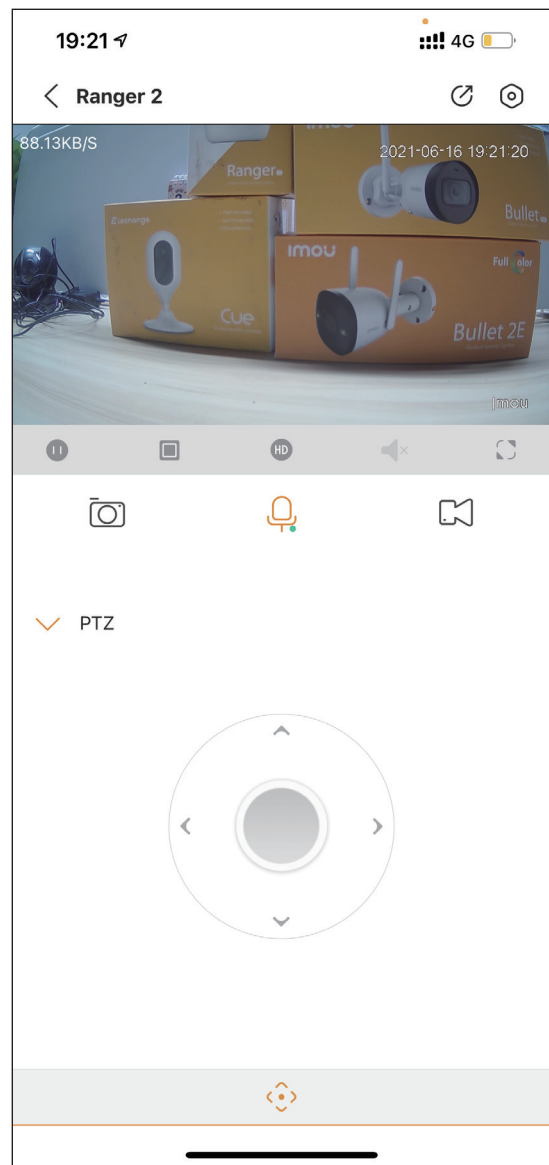
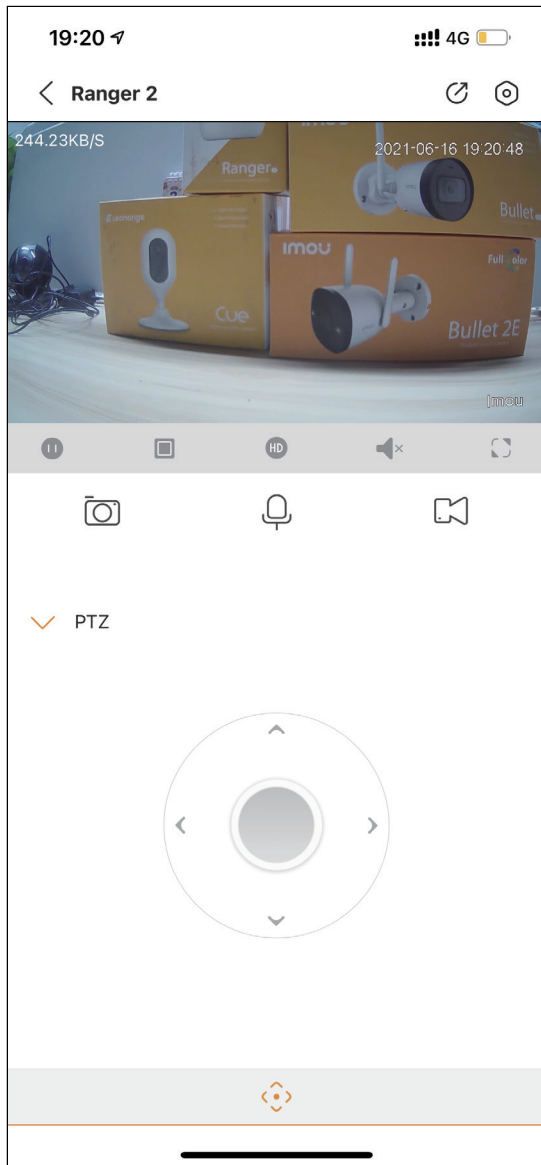

### 3, Detection Setting:

- activate motion detection or human detection;
- set the detection schedule;
- customize activity zone (yellow region);
- activate notification menu to get notification when detecting movements or human;

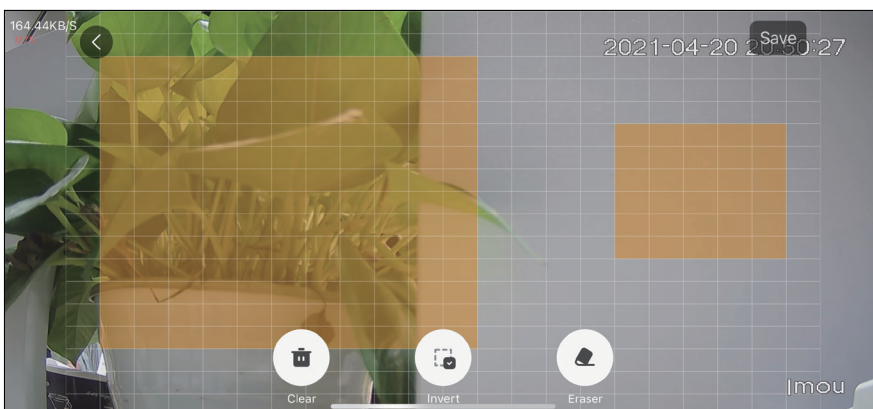
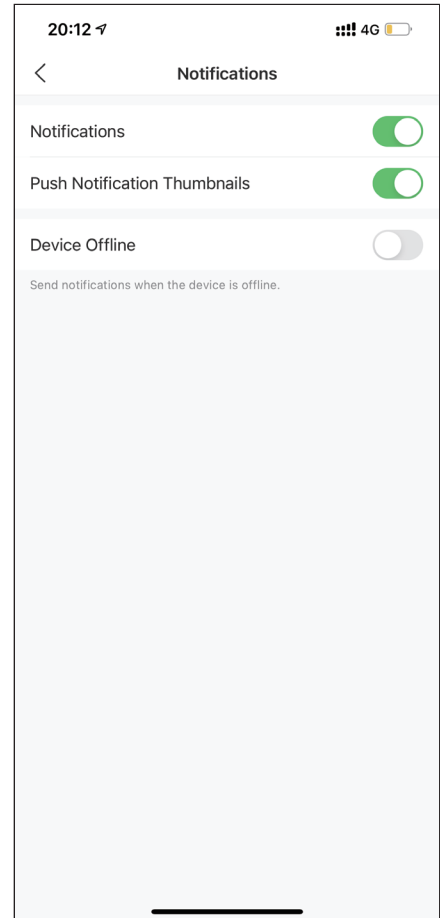
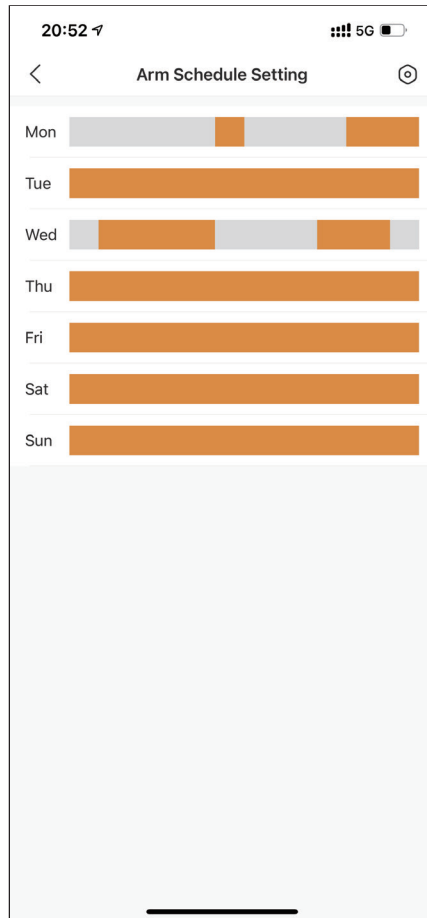
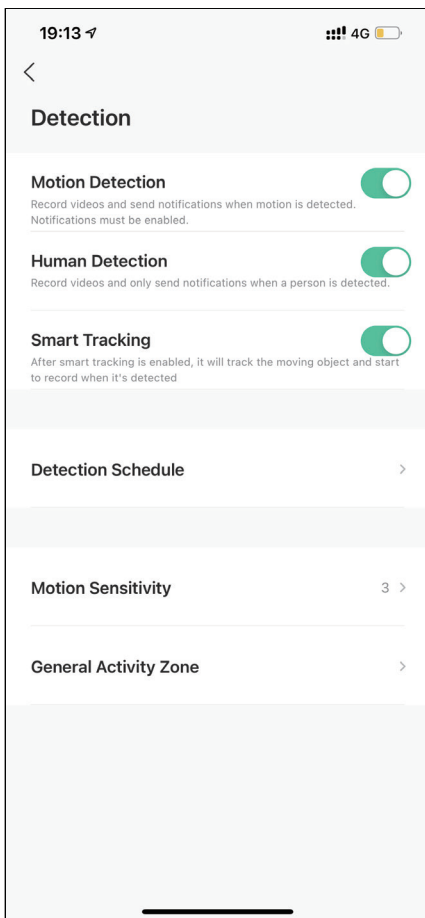

## 4, Siren and Abnormal Sound Detection:

- activate the alarm linkage, then the siren will be triggered when detecting movement or human;
- activate the abnormal sound detection and set the detection decibel to receive alarm notifications when detecting sound;

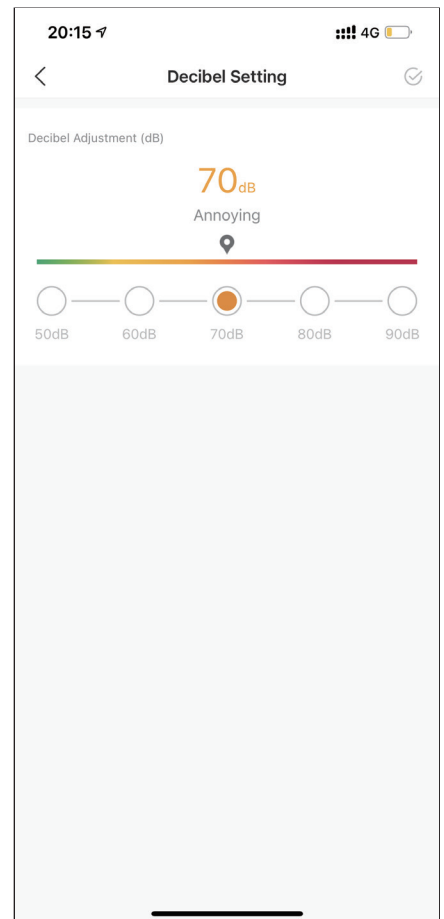
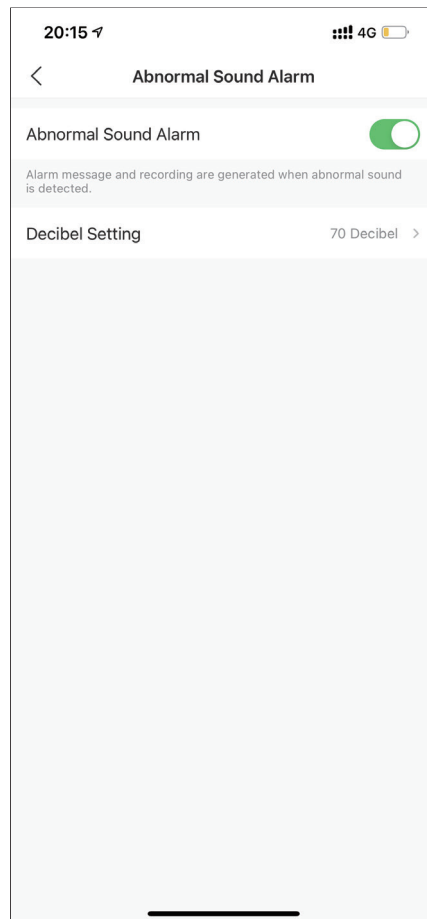
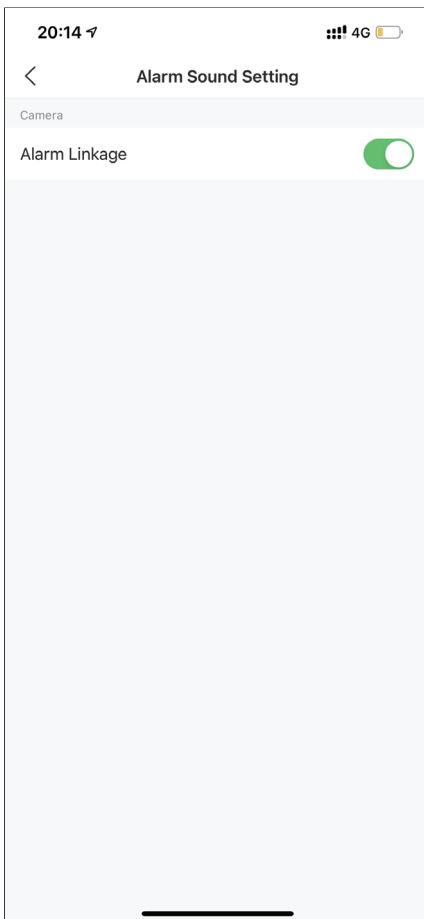

## 5, Imou Cloud Storage Plan:

- tap the "free trial" to activate the 7-day playback monthly plan, valid for 30 days;
- tap the "start" to subscribe more kinds of imou cloud storage plans for your devices;

ps: mark: each cloud plan can only be applied to one device.

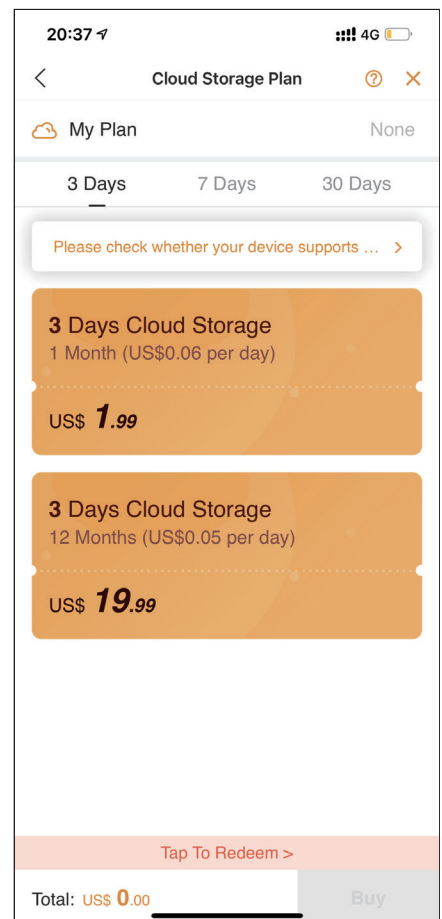
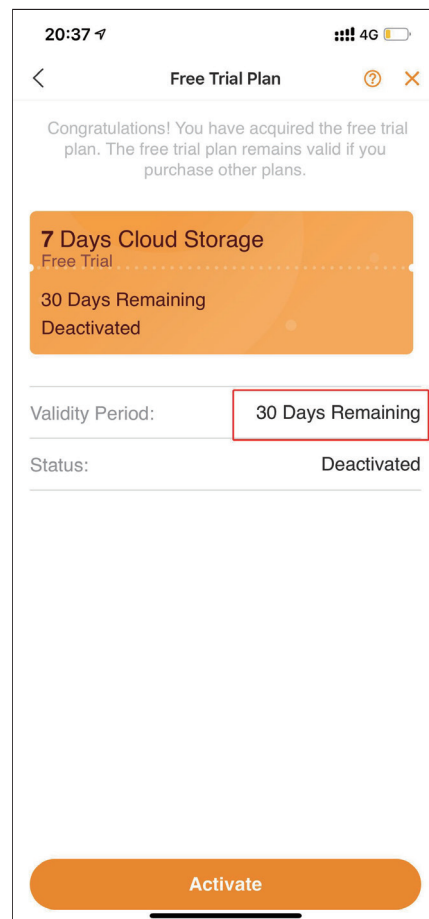
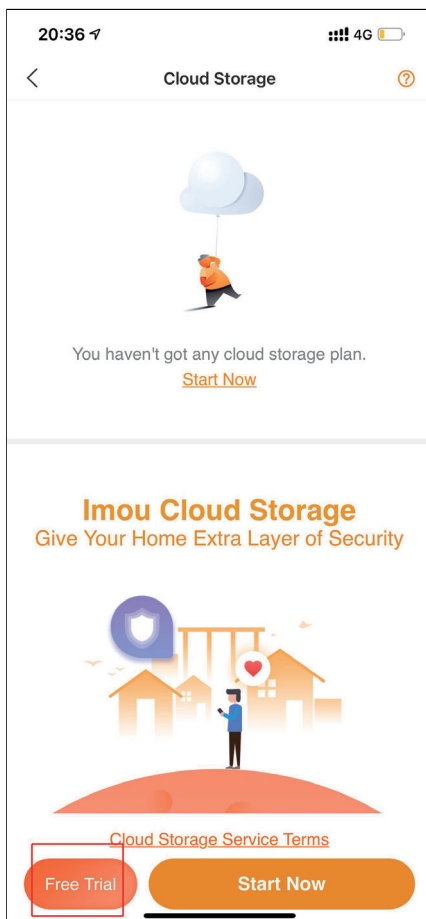

## 6. Storage Settings:

- local storage: enable the device storage is in normal status, Imou camera can only works with SD card at FAT 32 format;
- local storage rule: activate "store video" to save motion detection records, please note this function needs to work with detection settings; activate the "scheduled recording" to make 24 hours continuous records.

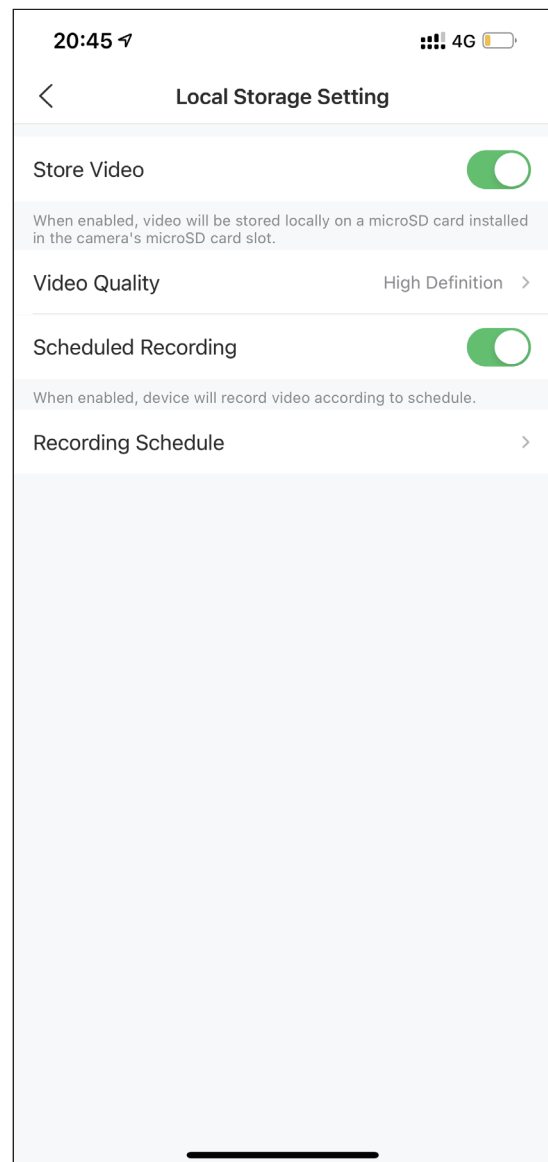
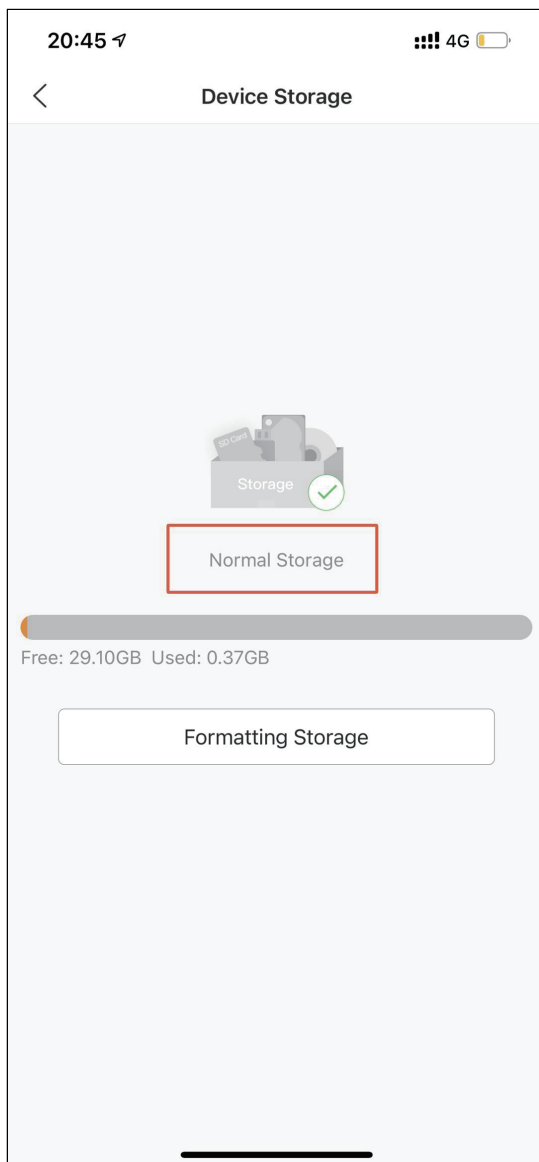

## 7, Share Device

Step 1. tap share device menu from device detail;

Step 2. click "+" and enter the email address;

Step 3. select the necessary permissions for other user.

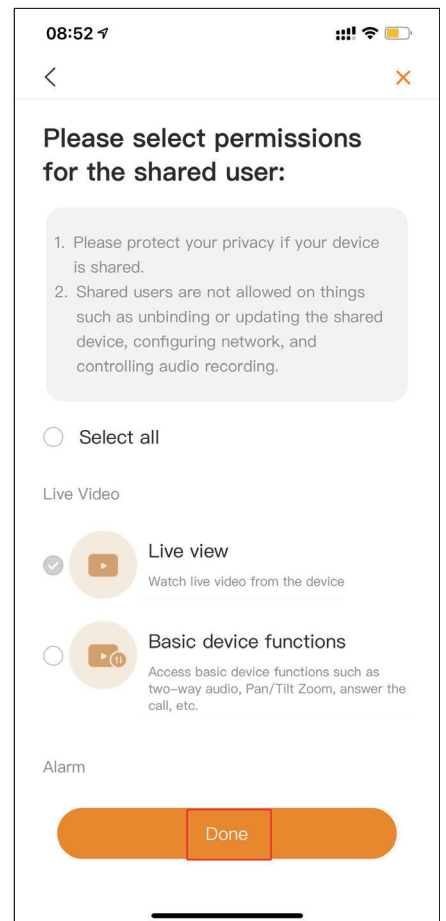
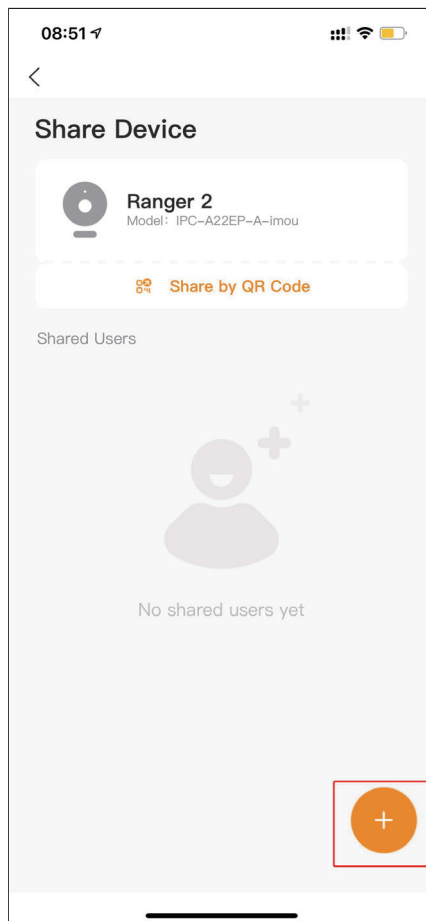
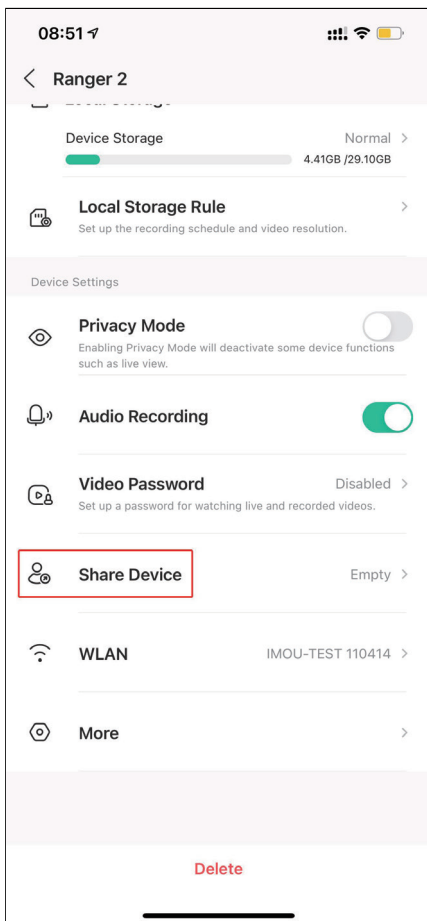

## 8, More Setting Menus:

8.1 IR LED Control: change the status of the device infrared lights.

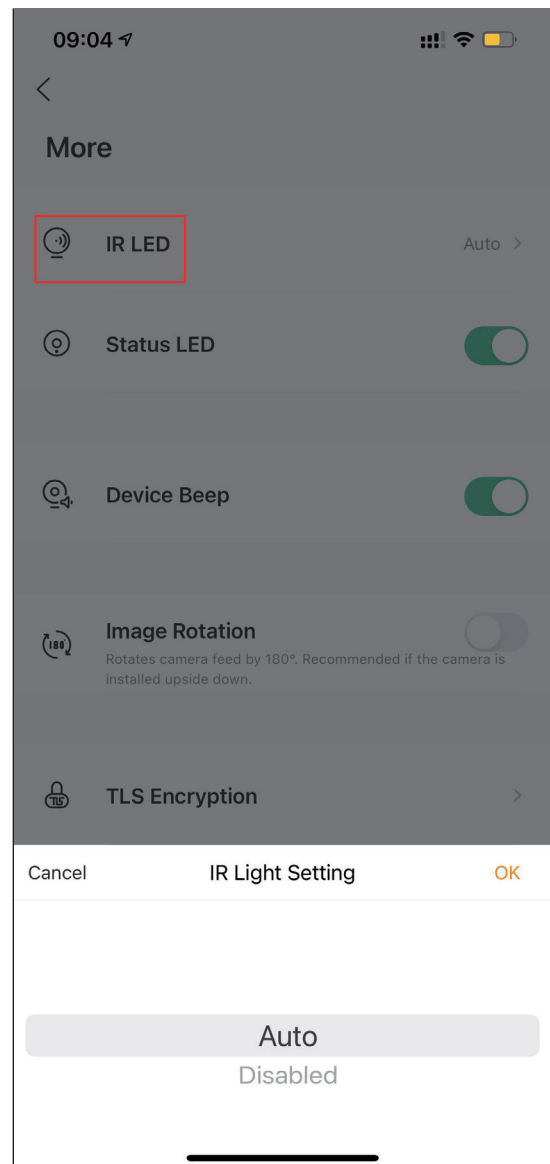
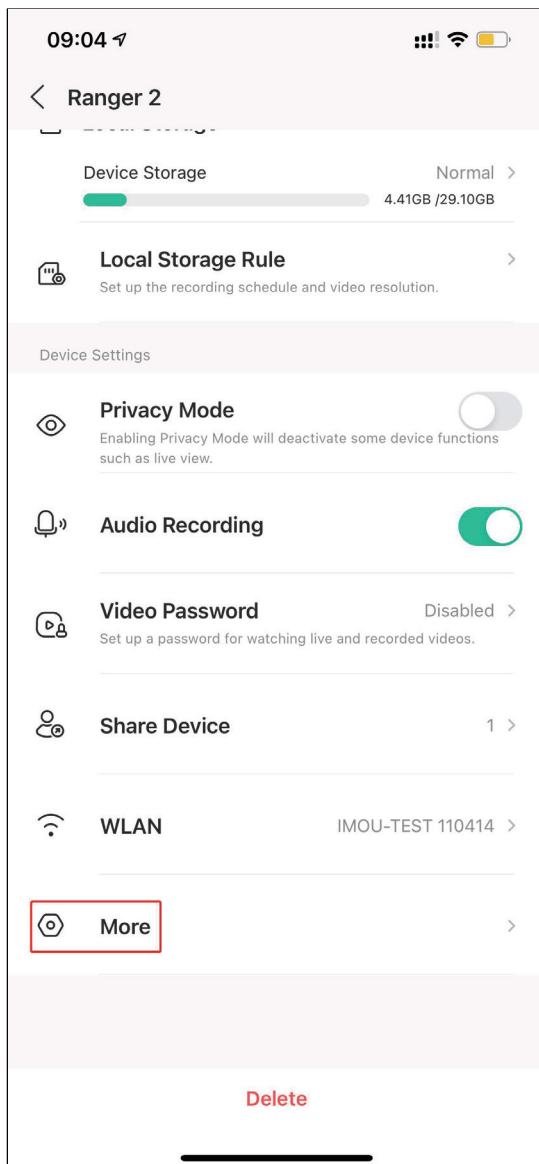

## 8.2 Status LED Control: turn on/off the device LED indicator.

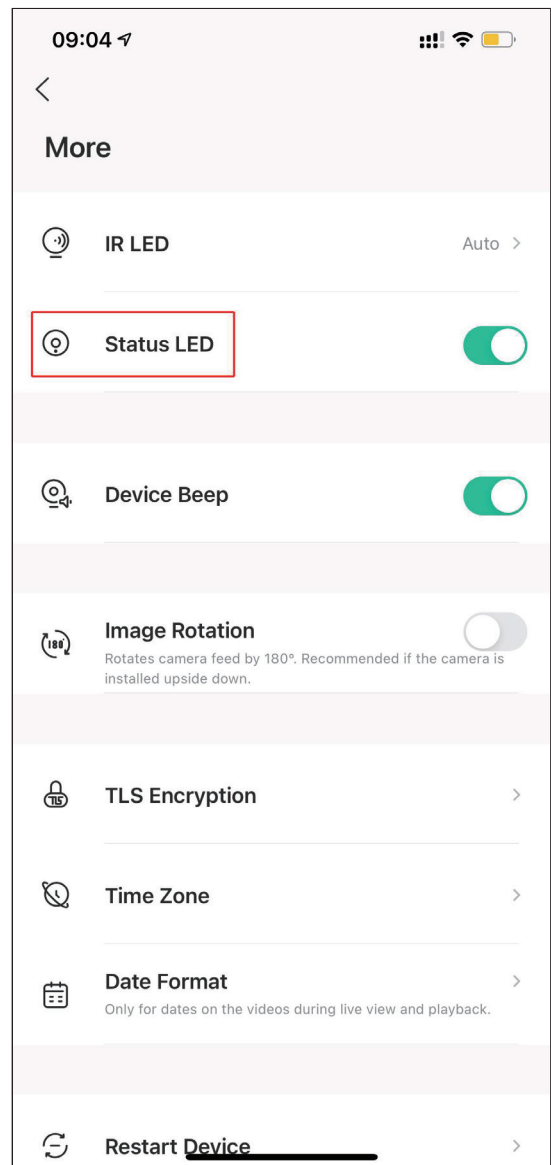
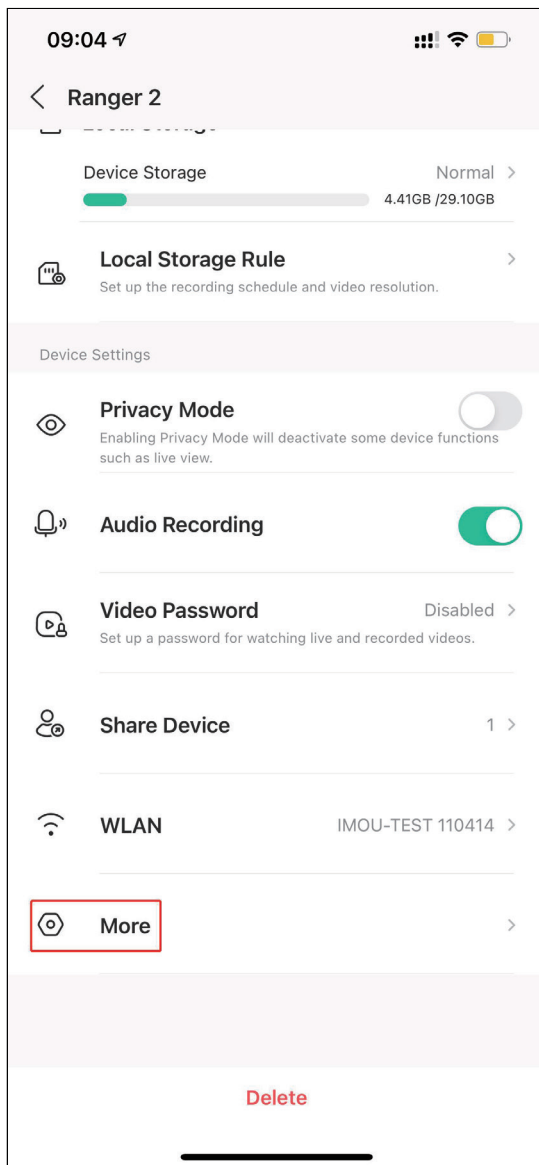

8.3 Image Rotation: rotates camera image by 180°. Recommend if the camera is installed upside down.

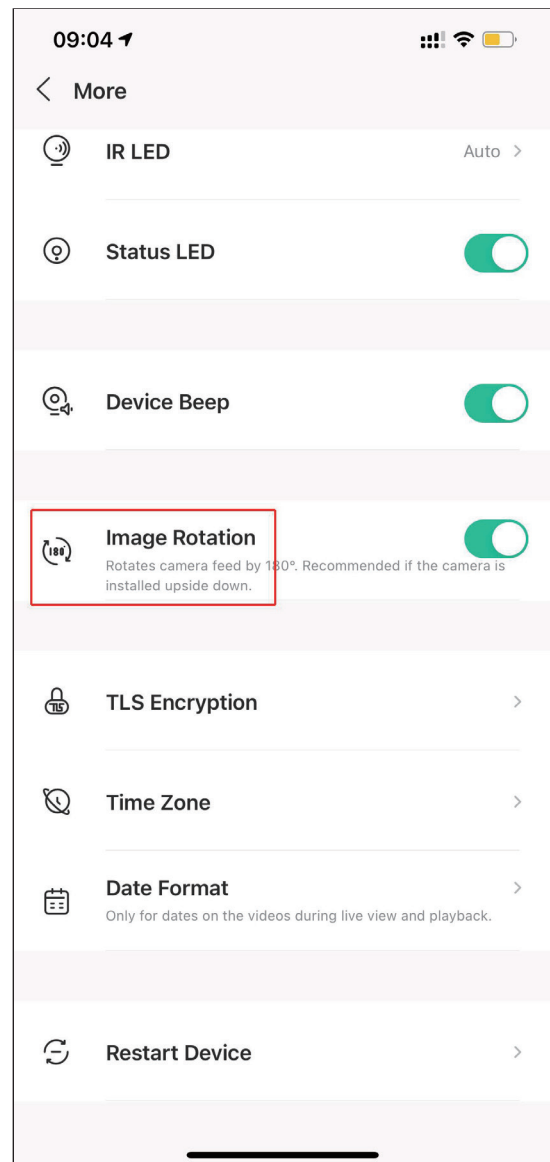
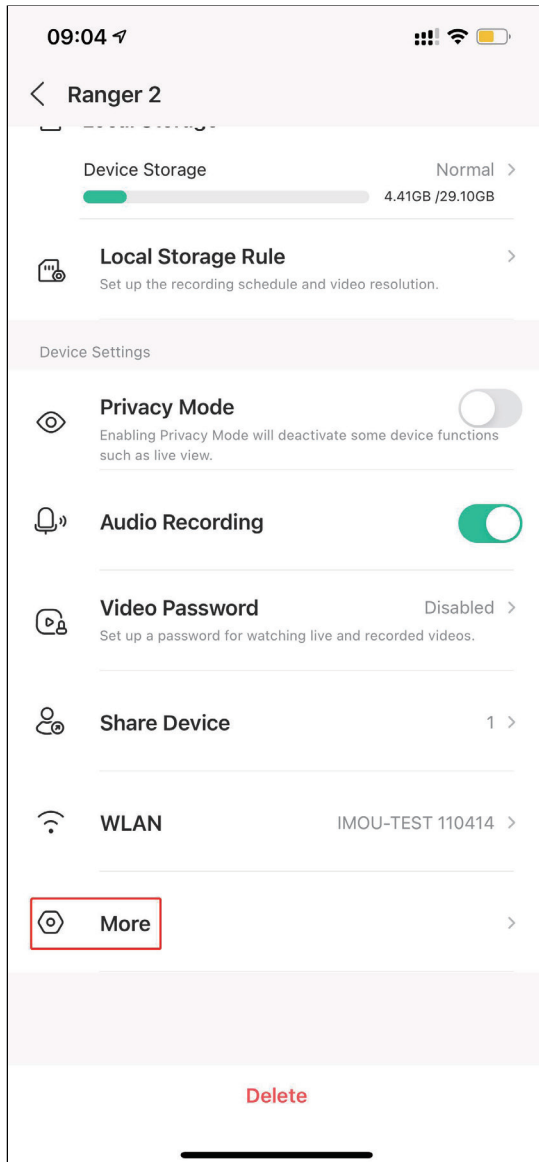

8.4 Time Zone: select the correct time zone for your device, daylight saving time(DST) is also available if it is needed.

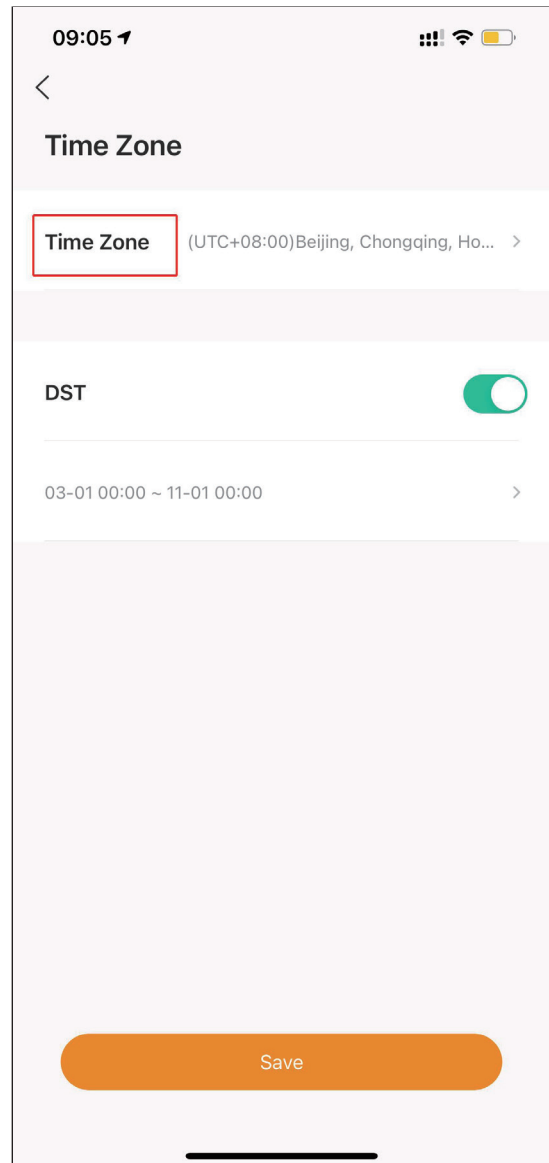
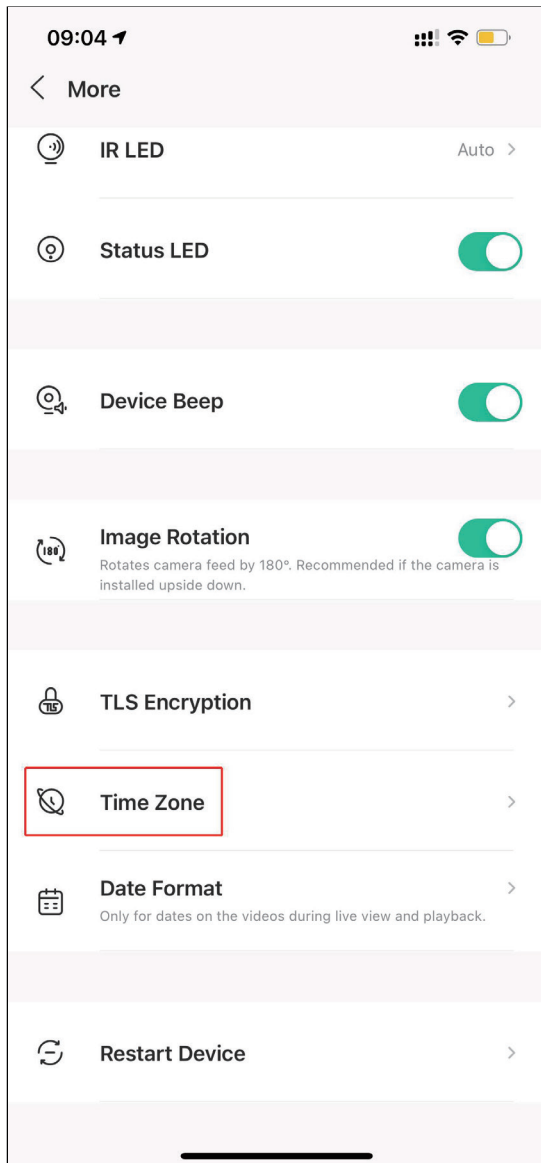

## 8.5 Date Format Setting: set difference date format if you want.

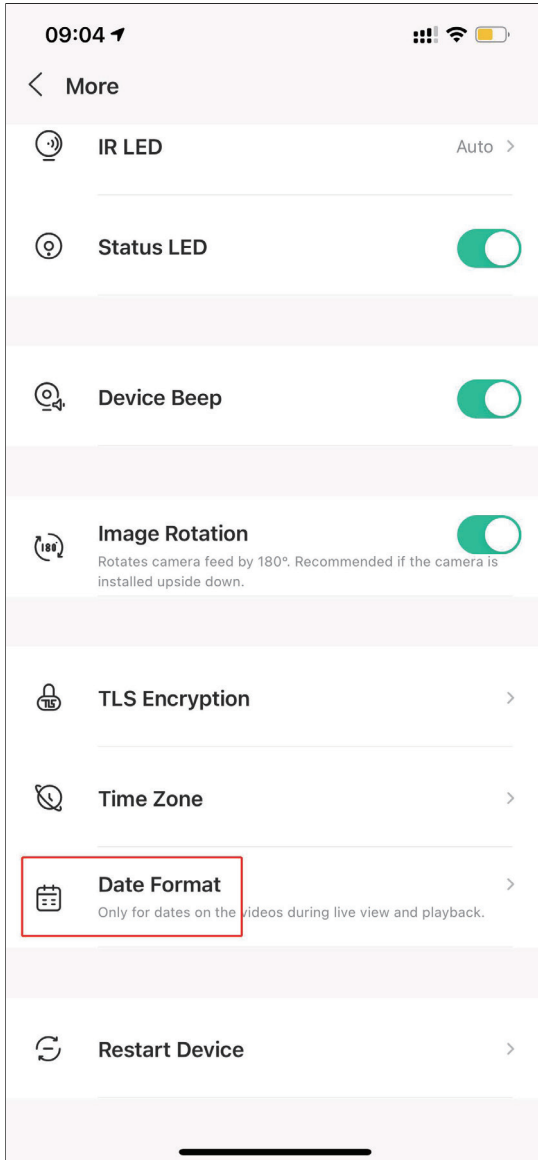

## 9, Message Panel

9.1 Alarm events and Records: view alarm events and play back alarm records. You can play back the video clips at 1x, 2x, 4x, 8x speed if you want.

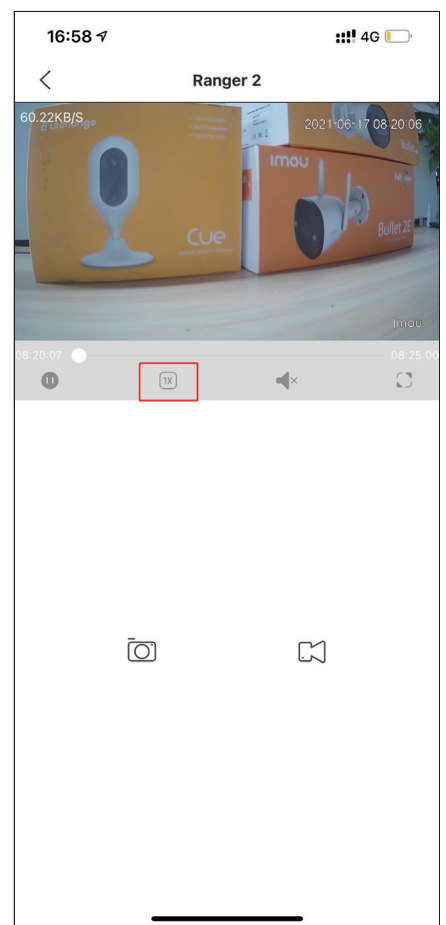
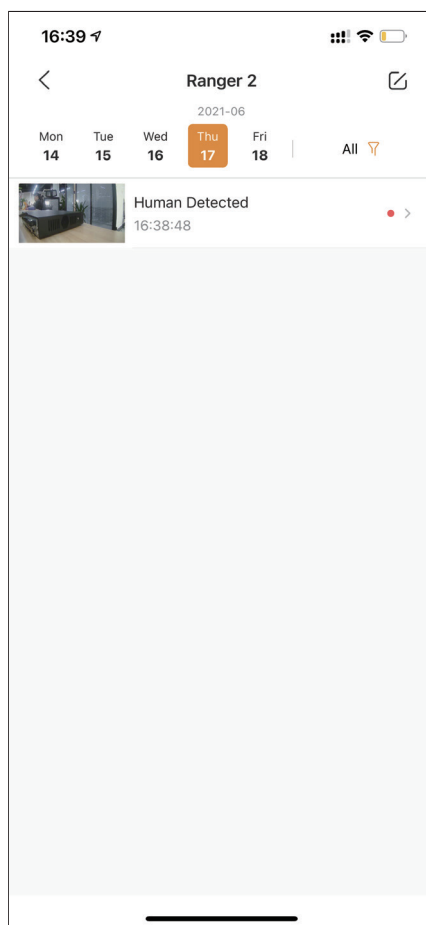
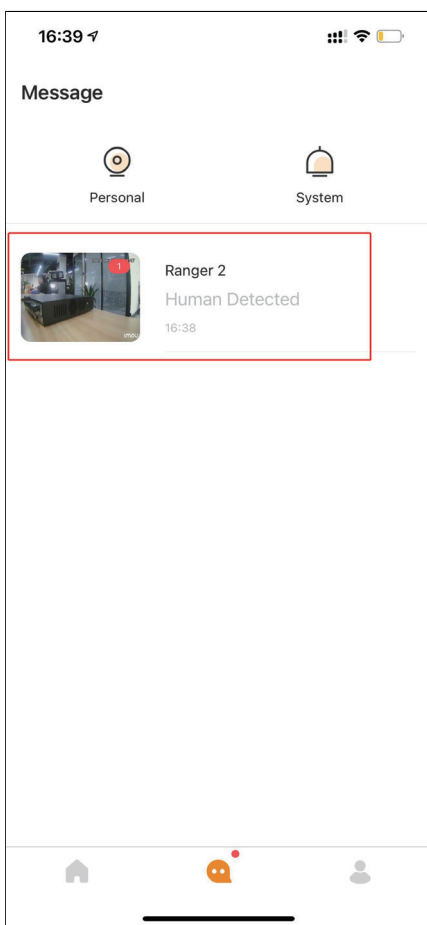

9.2 Personal info: You can find the device bind, device delete and share information.

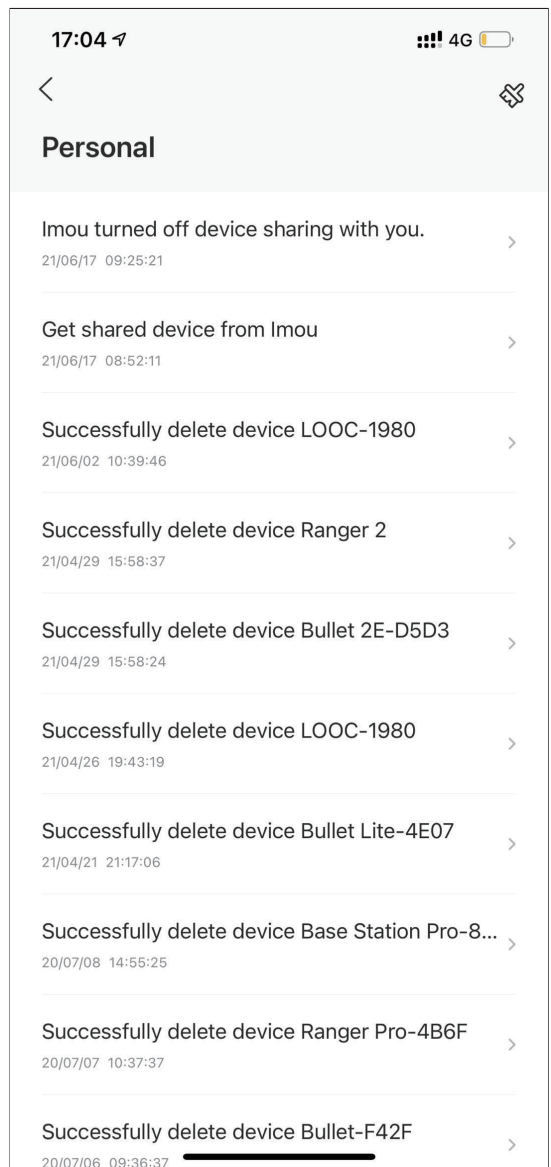
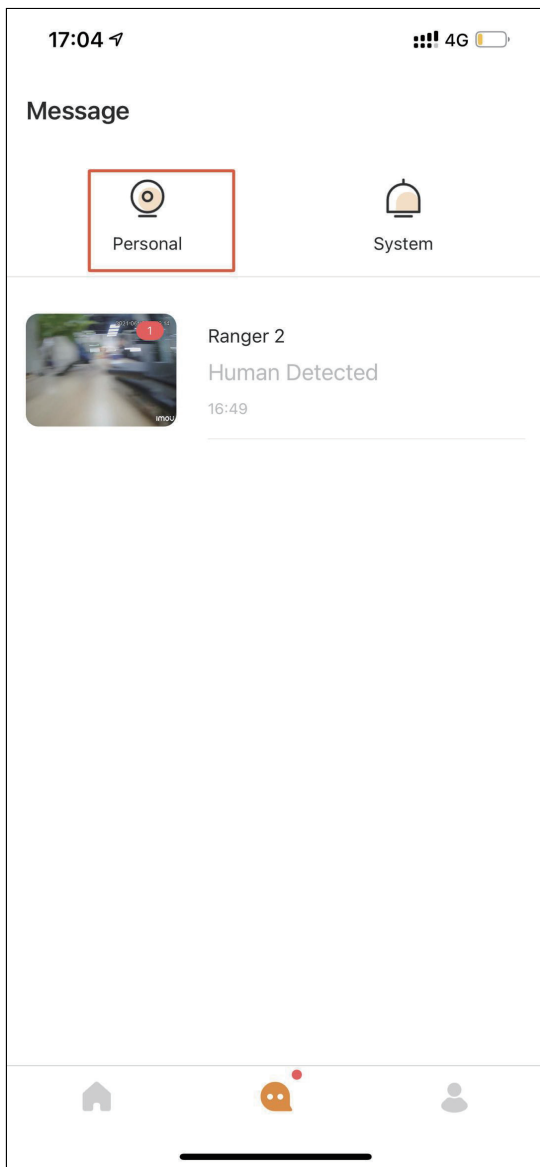

### 9.3 Sytem info: You will receive maintenance notice from IMOU

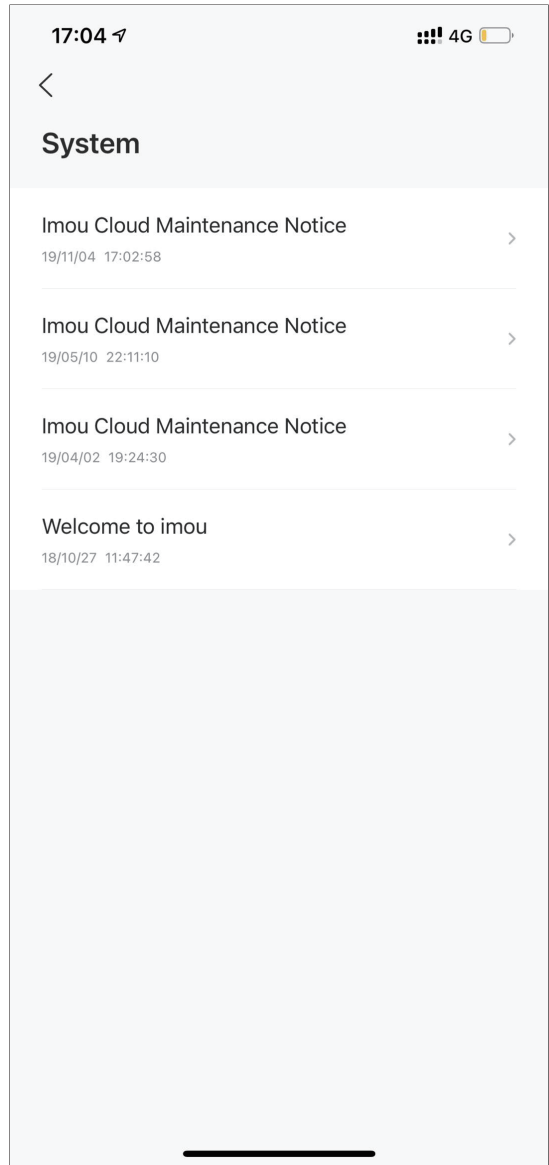
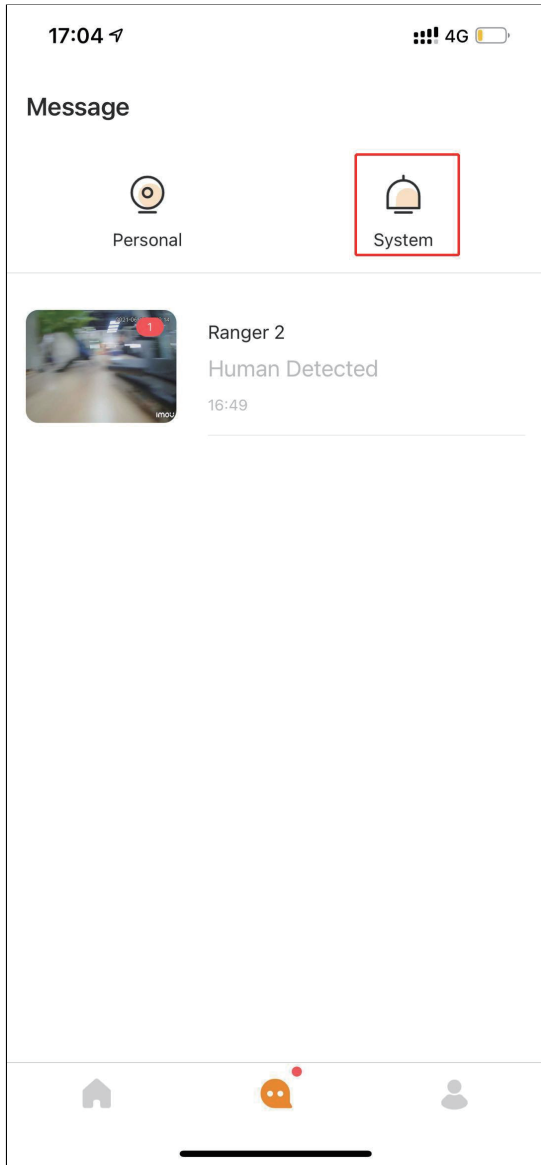

## 9.4 Playback alarm record and 24 hours continuous record:

Step 1. Play the live video and tap the "Event History Timeline";

Step 2. Slide the timeline to see the video clip of specific time. Please notice orange region is alarm record, blue region is continuous record;

Step 3. Or access "All Videos" to play the separate video clips.

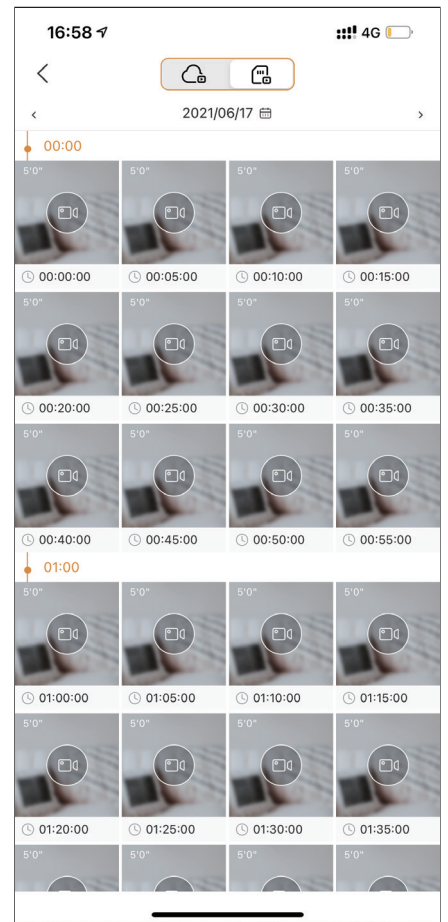
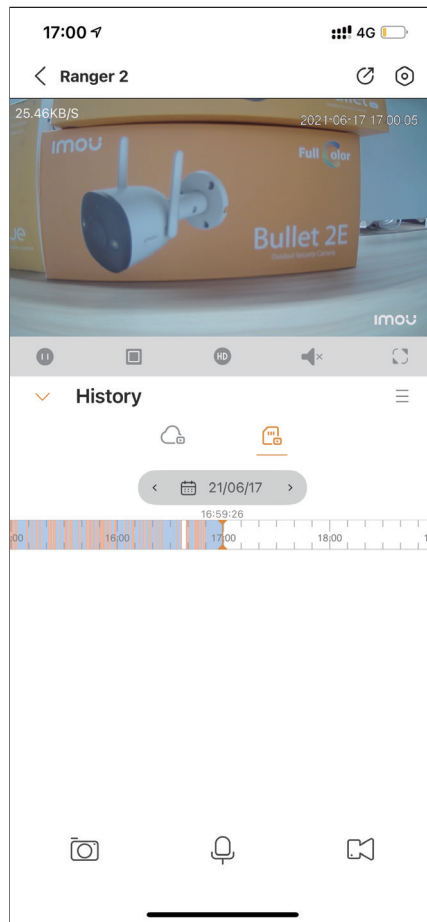
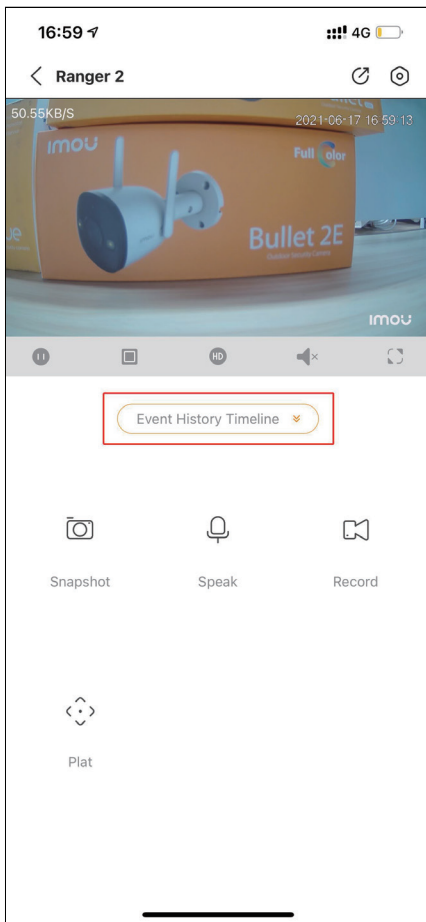

# 10, Me

10.1 Device Center: reorder your cameras, or assign your camera in different groups.

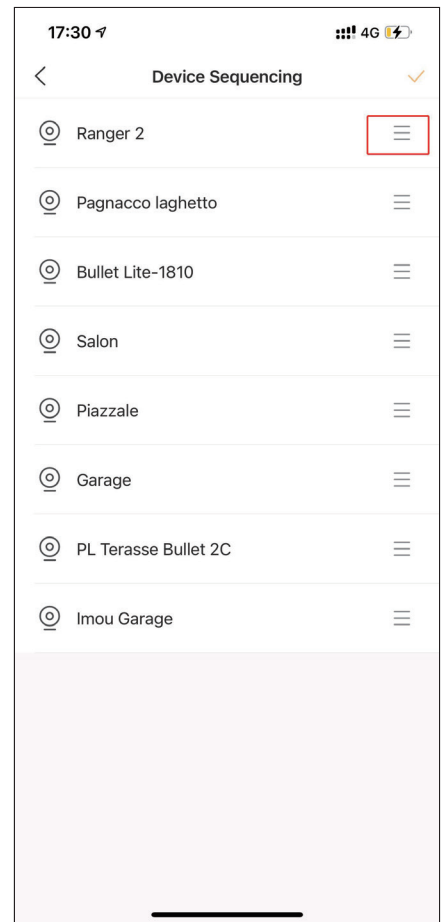
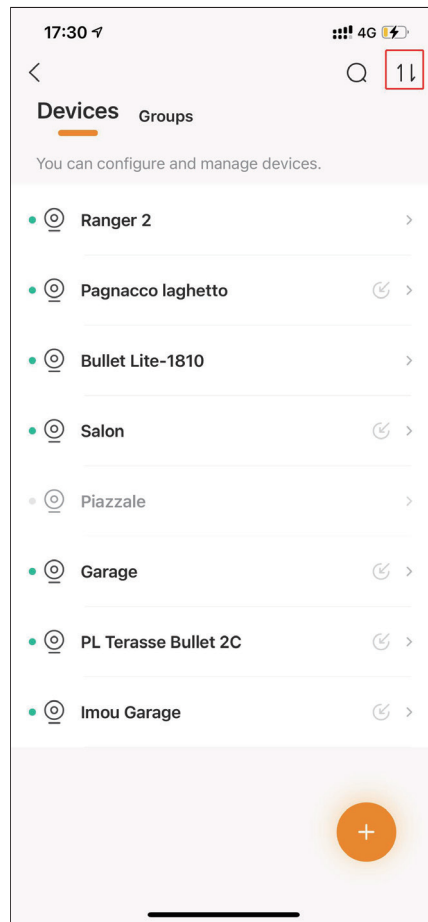
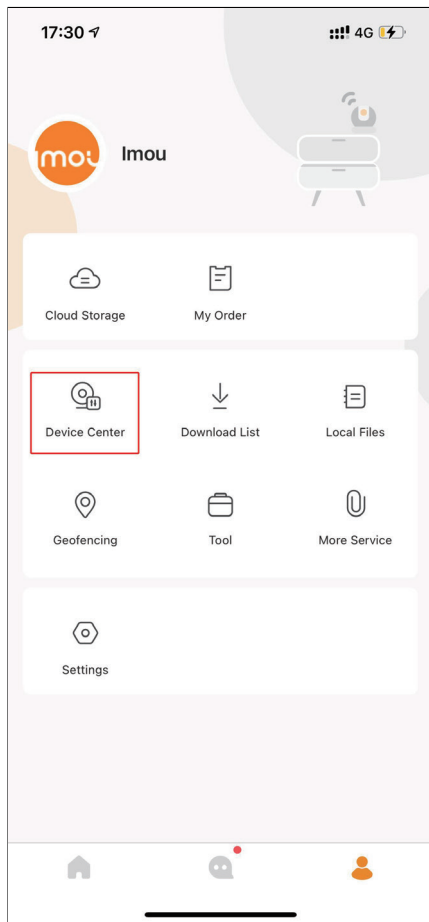

## 10.2 Local Files: manual snapshots or recording will be saved in Local File.

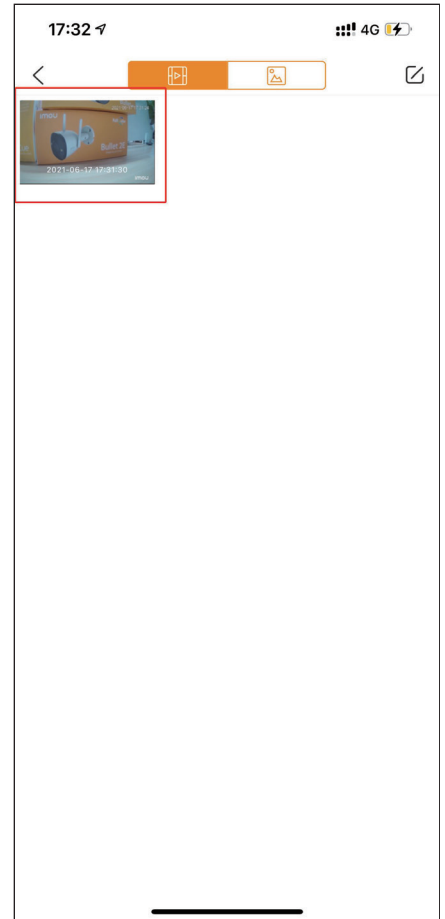
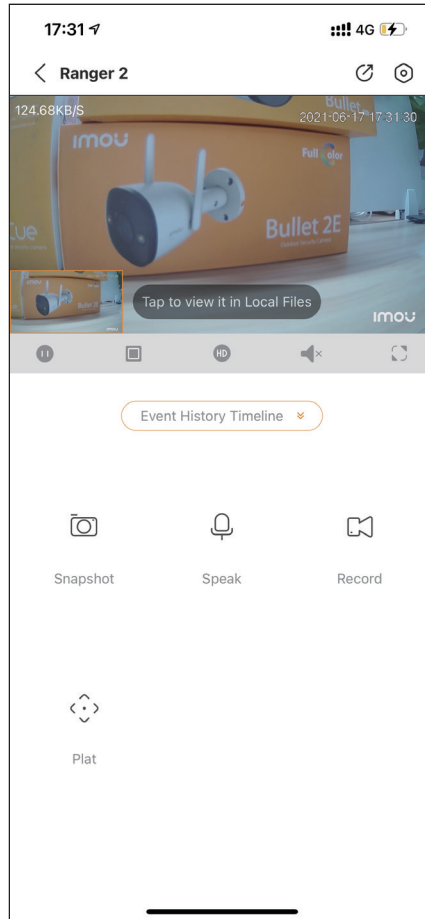
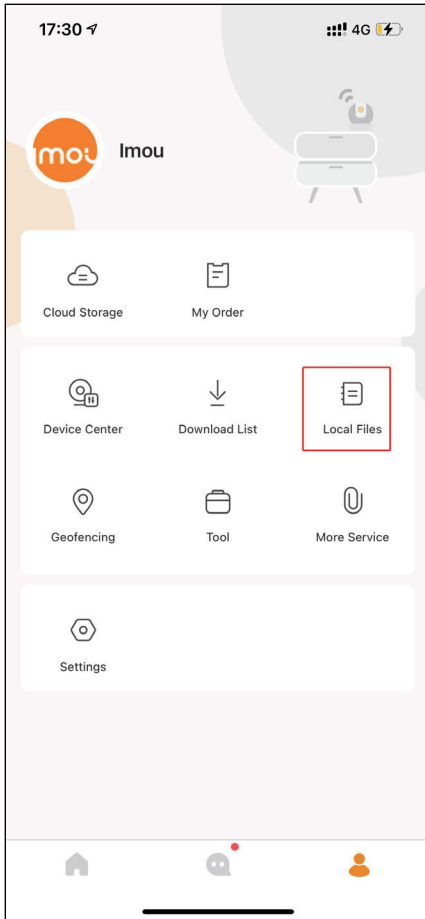

10.3 Tool>LAN View: play the live video under LAN, or download the SD card video record file.

Step 1: Tap "Tool" and select the LAN view

Step 2: Search cameras under LAN;

Step 3: Select your camera and enter the password (8 bit safety code on the label)

Step 4: Play the live video and download the SD card video record file.

Step 5: watch the video from "Download List"

