

# Bluetooth Device Connection Guide: musiCozy

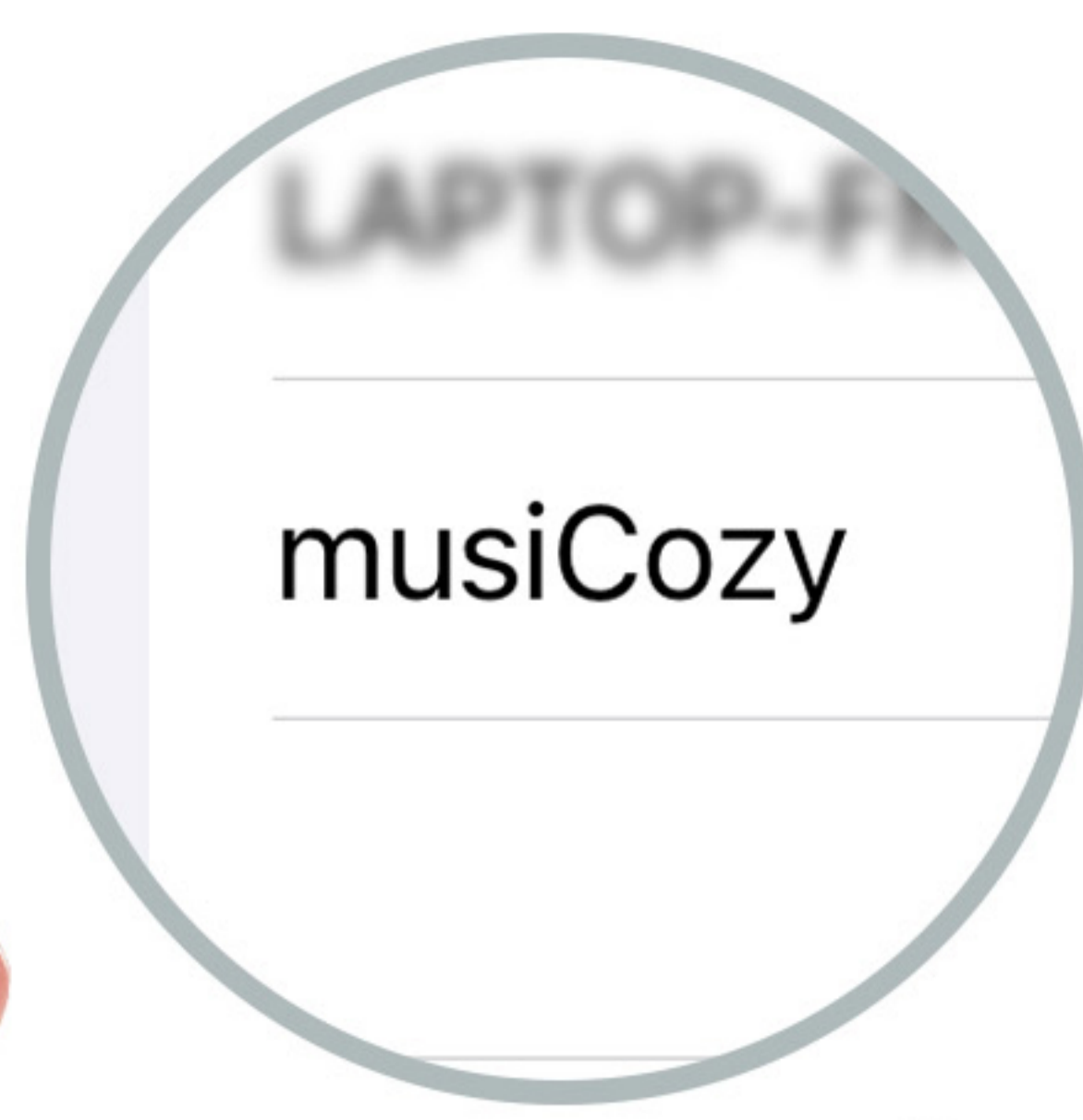

## Step 1: Disconnect Existing Devices

Ensure a stable connection by disconnecting any previously connected devices.

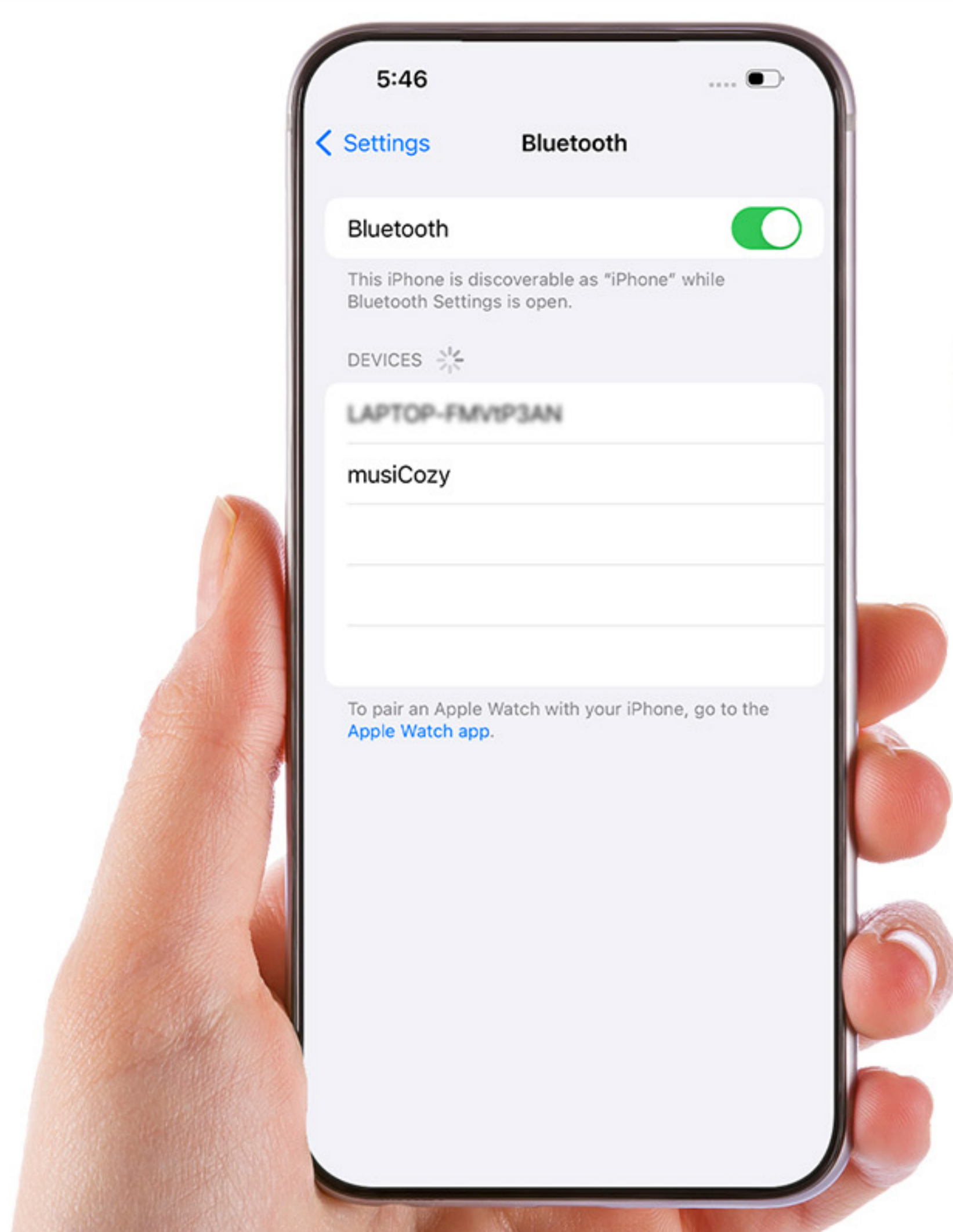
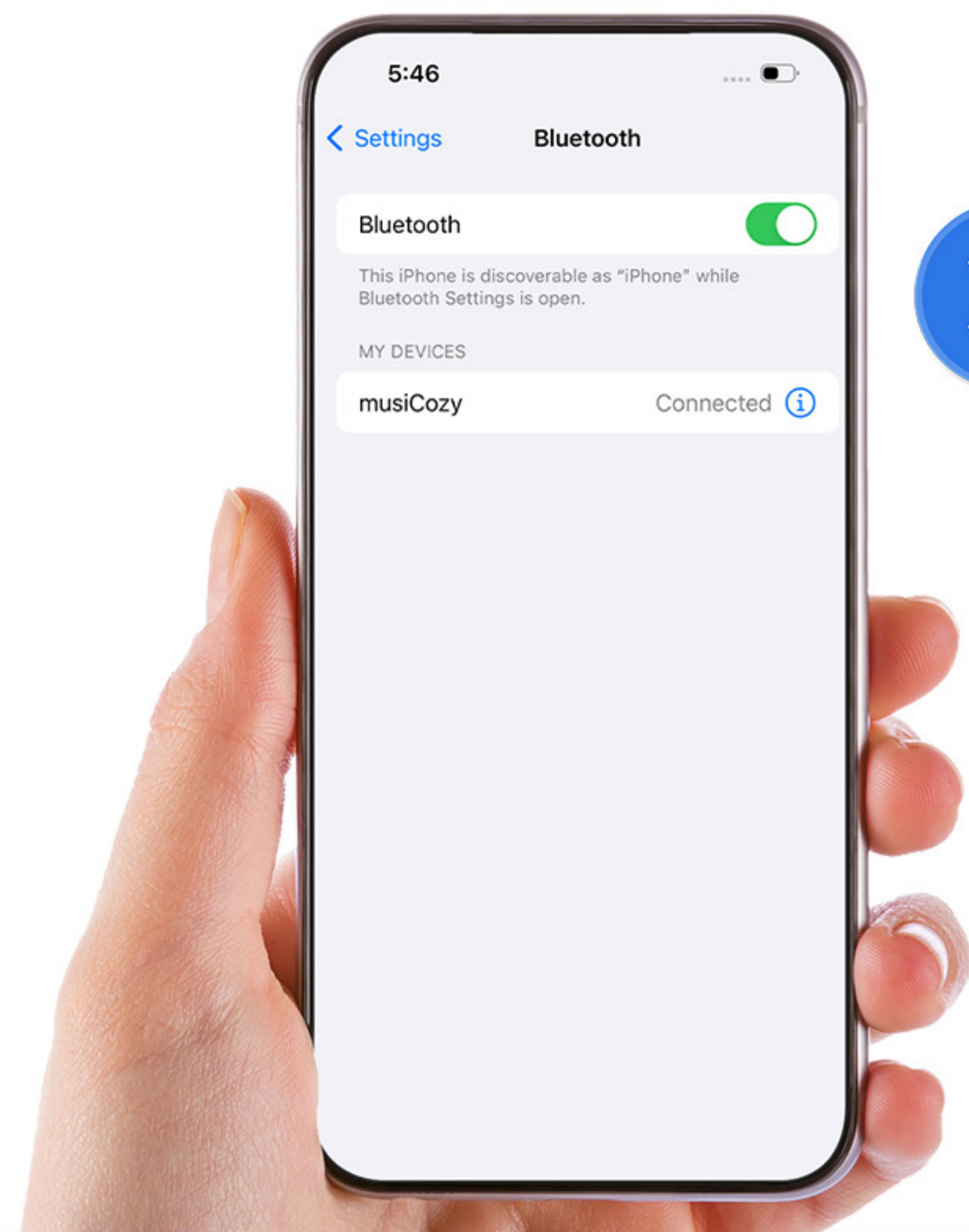

## Step 2: Connect to musiCozy

Open your device's Bluetooth settings. Locate and select the musiCozy device. Click on 'Connect' to establish a secure connection.

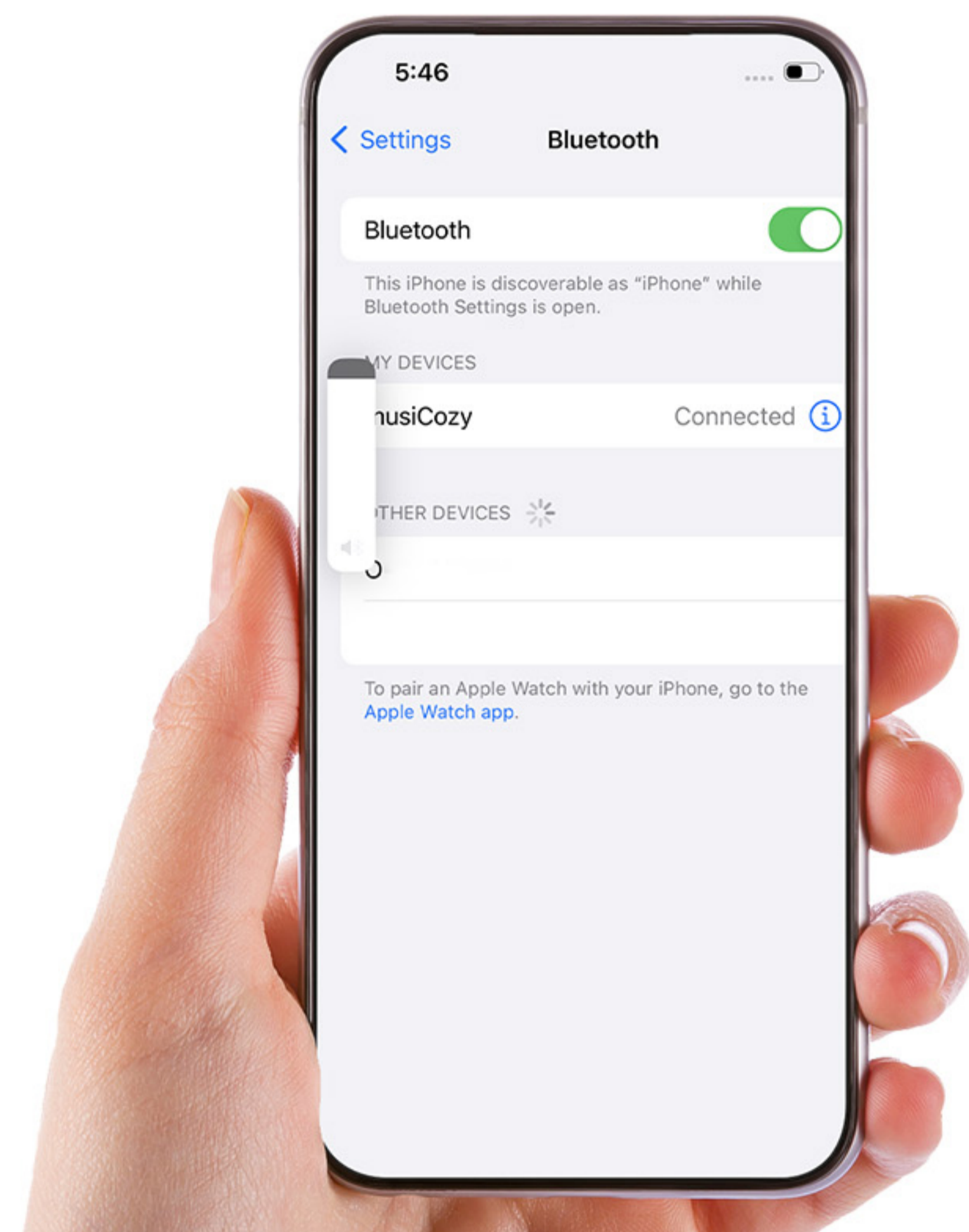

## Step 3: Adjust Volume and Enjoy

Adjust the audio volume to your preference. Start playing your favorite music or audio content. Note: For optimal performance, keep the device stable and within the Bluetooth range.

## Bluetooth Module Maintenance:

### Step 4: Remove and Clean the Bluetooth Module



Carefully remove the Bluetooth module from the headband. Ensure a gentle and cautious approach to avoid any damage.



#### Cleaning Process:

Do not let the module come into contact with water. Avoid using cleaning agents; opt for a gentle rinsing with clean water. Thoroughly rinse any dust or debris without submerging the module.



#### Drying:

Place the module in a cool, dry area to air-dry. Ensure it is completely dry before reinstallation.

### Step 5: Reinstall the Bluetooth Module



Once dry, securely reinstall the Bluetooth module into the headband. Align it properly and make sure it fits snugly. Follow the previous steps to reconnect your musiCozy device.

Note: Handle the Bluetooth module with care during the removal and cleaning process to avoid any potential damage.



## Charging Note:



During the Charging Process:

While the device is undergoing the charging process, please be aware that Bluetooth connectivity may be temporarily unavailable. It is recommended to complete the charging cycle before attempting to connect or use the musiCozy device wirelessly.